



BOUNDARY DESCRIPTION
PARCEL "A"

A PART OF THE SOUTHEAST QUARTER OF SECTION 10, TOWNSHIP 6 NORTH, RANGE 2 WEST, OF THE SALT LAKE BASE AND MERIDIAN, BEGINNING AT A POINT BEING LOCATED SOUTH 88°15'35" EAST 3603.14 FEET ALONG THE SOUTH LINE OF SAID SECTION 10 AND NORTH 0°00'00" EAST 53.77 FEET AND NORTH 0°38'31" EAST 603.94 FEET AND NORTH 0°19'46" EAST 212.57 FEET FROM THE SOUTHWEST CORNER OF SAID SECTION, RUNNING THENCE NORTH 0°19'46" EAST 538.79 FEET; THENCE SOUTH 89°45'09" EAST 402.38 FEET; THENCE SOUTH 0°57'11" WEST 183.68 FEET; THENCE SOUTH 89°26'15" EAST 245.04 FEET TO THE CENTER LINE OF 2800 WEST STREET, THENCE ALONG SAID CENTER LINE SOUTH 0°35'58" WEST 371.81 FEET; THENCE NORTH 88°08'54" WEST 643.90 FEET TO THE POINT OF BEGINNING, CONTAINING 7.08 ACRES.

BOUNDARY DESCRIPTION
PARCEL "B"

A PART OF THE SOUTHEAST QUARTER OF SECTION 10, TOWNSHIP 6 NORTH, RANGE 2 WEST, OF THE SALT LAKE BASE AND MERIDIAN, MORE PARTICULARLY DESCRIBED AS FOLLOWS: BEGINNING AT A POINT BEING LOCATED SOUTH 88°15'35" EAST 3603.14 FEET ALONG THE SOUTH LINE OF SAID SECTION 10 AND NORTH 0°00'00" EAST 53.77 FEET FROM THE SOUTHWEST CORNER OF SAID SECTION 10, RUNNING THENCE NORTH 0°38'31" EAST 603.94 FEET; THENCE NORTH 0°19'46" EAST 212.57 FEET; THENCE SOUTH 88°08'54" EAST 643.90 FEET TO THE CENTERLINE OF 2800 WEST STREET; THENCE ALONG SAID WEST CENTERLINE SOUTH 0°35'58" WEST 659.34 FEET TO THE NORTH LINE OF THE DARREN AND JENNY DEVRIES MINOR SUBDIVISION; THENCE ALONG THE BOUNDARY OF SAID DARREN AND JENNY DEVRIES MINOR SUBDIVISION THE FOLLOWING TWO (2) COURSES, (1) NORTH 88°45'13" WEST 337.86 FEET, (2) SOUTH 0°57'11" WEST 150.19 FEET; THENCE NORTH 88°47'08" WEST 304.44 FEET TO THE POINT OF BEGINNING, CONTAINING 10.83 ACRES.

SCALE	1:100 XREF
DATE	10/25/21
DESIGN	
DRAWN	KHW
CHECKED	KHW

REVISIONS	DATE	DESCRIPTION

PROPERTY SURVEY FOR FERN ELIZABETH DEVRIES TRUST
 +/- 250 NORTH 2800 WEST, MARRIOTT-SLATERVILLE, UT
 LOCATED IN THE SOUTHEAST QUARTER OF SECTION 10,
 TOWNSHIP 6 NORTH, RANGE 2 WEST, S.L.B. AND M.

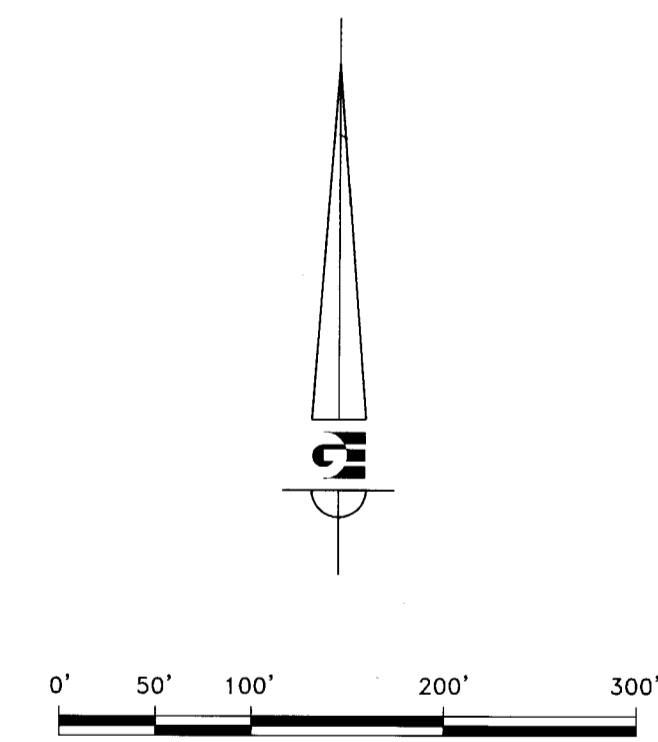

LEGEND

- ◆ WEBER COUNTY MONUMENT AS NOTED
- SET 24" REBAR AND CAP MARKED GARDNER ENGINEERING
- SUBDIVISION BOUNDARY
- LOT LINE
- - - ADJACENT PARCEL
- - - SECTION LINE
- - - EASEMENT
- × EXISTING FENCE LINE

NARRATIVE

THE PURPOSE OF THIS SURVEY WAS TO ESTABLISH AND SET THE PROPERTY CORNERS OF THE PARCEL AS SHOWN AND DESCRIBED HEREON. THE SURVEY WAS ORDERED BY BOB DEVRIES, THE BASIS OF BEARING IS THE SOUTH LINE OF SECTION 10, WHICH BEARS NORTH 88°15'35" EAST, WEBER COUNTY, UTAH NORTH, NAD 83 STATE PLANE GRID BEARING. THE BOUNDARY WAS DETERMINED BY WARRANTY DEED RECORDED AS ENTRY NUMBER 2075867, 1679517, 834880, 2879552, 2879550, 2993900, 2879551, 2910255, AND DEEDS OF ADJOINING PROPERTY OWNERS. RECORD OF SURVEY NUMBERS 004340, 001029 AND THE DEDICATED PLATS OF 1834945, 5945 WERE ALSO USED TO DETERMINE BOUNDARY LOCATION ALONG WITH THE FOUND MONUMENTS AS SHOWN AND DESCRIBED HEREON.

SURVEYOR'S CERTIFICATE

I, KLINT H. WHITNEY, DO HEREBY CERTIFY THAT I AM A LICENSED PROFESSIONAL LAND SURVEYOR IN THE STATE OF UTAH AND THAT I HOLD CERTIFICATE NO. 8227228 IN ACCORDANCE WITH TITLE 88, CHAPTER 22, OF THE PROFESSIONAL ENGINEERS AND LAND SURVEYORS ACT. I FURTHER CERTIFY THAT BY AUTHORITY OF THE OWNERS I HAVE COMPLETED A SURVEY OF THE PROPERTY DESCRIBED ON THIS RECORD OF SURVEY PLAT IN ACCORDANCE WITH SECTION 17-23-20 AND HAVE VERIFIED ALL MEASUREMENTS; THAT THE REFERENCE MONUMENTS SHOWN ON THIS RECORD OF SURVEY PLAT ARE LOCATED AS INDICATED AND ARE SUFFICIENT TO RETRACE OR REESTABLISH THIS SURVEY; AND THAT THE INFORMATION SHOWN HEREIN IS SUFFICIENT TO ACCURATELY ESTABLISH THE LATERAL BOUNDARIES OF THE HEREIN DESCRIBED TRACT OF REAL PROPERTY.

SIGNED THIS 7TH DAY OF MARCH, 2021.

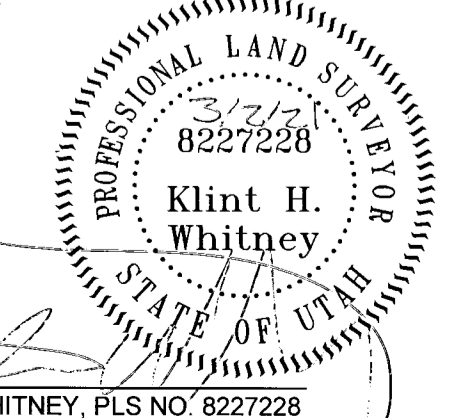

NOTED
 MAR 02 2021
 BY: 6813

GARDNER ENGINEERING
 CIVIL, LAND PLANNING
 MUNICIPAL - LAND SURVEYING
 5150 SOUTH 375 EAST OGDEN, UT
 OFFICE: 801.476.0202 FAX: 801.476.0066

S1
 1