

BOUNDARY DESCRIPTION

PART OF THE NORTHWEST QUARTER OF SECTION 8, T6N, R1W, S.L.B.&M. (FOUND WEBER COUNTY BRASS CAP MONUMENT)

BEGINNING AT A POINT ON THE NORTH LINE OF SAID SECTION BEING LOCATED SOUTH 88°52'17" EAST 143.35 FEET FROM THE NORTHWEST CORNER OF SAID SECTION; RUNNING THENCE SOUTH 88°52'17" EAST 72.51 FEET ALONG THE SAID NORTH LINE TO THE WESTERLY BOUNDARY LINE OF LORIN W. CROWTHER SUBDIVISION; THENCE ALONG SAID WESTERLY BOUNDARY LINE FOLLOWING TWO (2) COURSES; (1) SOUTH 2°59'42" WEST 520.85 FEET; (2) SOUTH 30°29'57" WEST 307.00 FEET; THENCE NORTH 52°37'10" WEST 101.10 FEET; THENCE NORTH 25°14'42" EAST 130.40 FEET; THENCE NORTH 12°33'59" EAST 621.66 FEET TO THE POINT OF BEGINNING. CONTAINING 2.102 ACRES MORE OR LESS.

RECEIVED
MAY 26 2021
BY: 6878

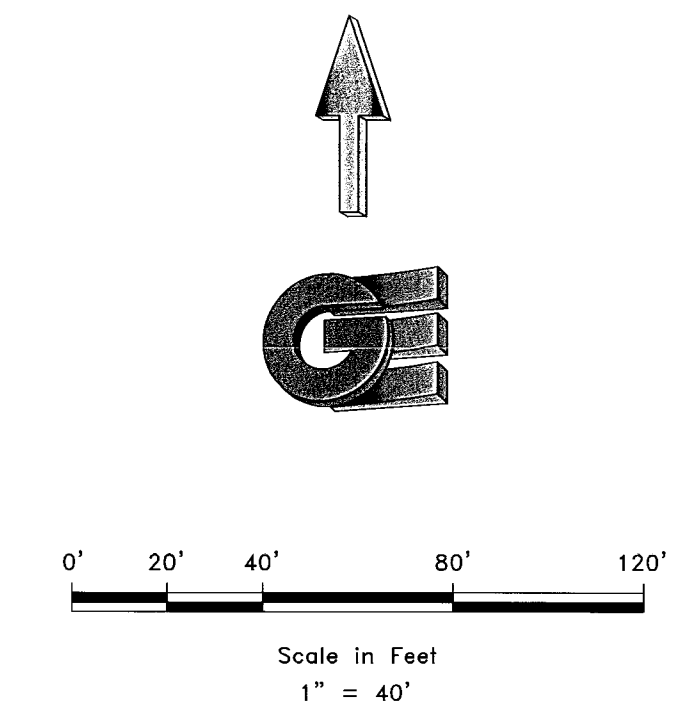

- LEGEND**
- ◆ WEBER COUNTY MONUMENT AS NOTED
 - SET 24" REBAR AND CAP MARKED GARDNER ENGINEERING
 - SUBJECT PROPERTY BOUNDARY
 - LOT LINE
 - - - ADJACENT PARCEL
 - - - SECTION LINE
 - - - EASEMENT
 - x - EXISTING FENCE LINE

NARRATIVE

THE PURPOSE OF THIS SURVEY WAS TO ESTABLISH AND SET THE PROPERTY CORNERS OF THE PARCEL AS SHOWN AND DESCRIBED HEREON. THE SURVEY WAS ORDERED BY BEN MOA. THE BASIS OF BEARING IS THE NORTH LINE OF SECTION 8, TOWNSHIP 6 NORTH, RANGE 1 WEST, OF THE SALT LAKE BASE AND MERIDIAN WHICH BEARS SOUTH 88°52'17" EAST, WEBER COUNTY, UTAH NORTH, NAD 83 STATE PLANE GRID BEARING. THE BOUNDARY WAS DETERMINED BY WARRANTY DEED RECORDED AS ENTRY NUMBER 2948367, AND DEEDS OF ADJOINING PROPERTY OWNERS. RECORD OF SURVEY NUMBER 1292, AND THE DEDICATED PLATS OF THE LORIN W. CROWTHER SUBDIVISION AND THE KNIGHT SUBDIVISION WERE ALSO USED TO DETERMINE BOUNDARY LOCATION ALONG WITH THE FOUND MONUMENTS AS SHOWN AND DESCRIBED HEREON.

SURVEYOR'S CERTIFICATE

I, KLINT H. WHITNEY, DO HEREBY CERTIFY THAT I AM A LICENSED PROFESSIONAL LAND SURVEYOR IN THE STATE OF UTAH AND THAT I HOLD CERTIFICATE NO. 8227228 IN ACCORDANCE WITH TITLE 58, CHAPTER 22, OF THE PROFESSIONAL ENGINEERS AND LAND SURVEYORS ACT; I FURTHER CERTIFY THAT BY AUTHORITY OF THE OWNERS I HAVE COMPLETED A SURVEY OF THE PROPERTY DESCRIBED ON THIS RECORD OF SURVEY PLAT IN ACCORDANCE WITH SECTION 17-23-20 AND HAVE VERIFIED ALL MEASUREMENTS; THAT THE REFERENCE MONUMENTS SHOWN ON THIS RECORD OF SURVEY PLAT ARE LOCATED AS INDICATED AND ARE SUFFICIENT TO RETRACE OR REESTABLISH THIS SURVEY; AND THAT THE INFORMATION SHOWN HEREIN IS SUFFICIENT TO ACCURATELY ESTABLISH THE LATERAL BOUNDARIES OF THE HEREIN DESCRIBED TRACT OF REAL PROPERTY.

SIGNED THIS 25TH DAY OF MAY, 2021.

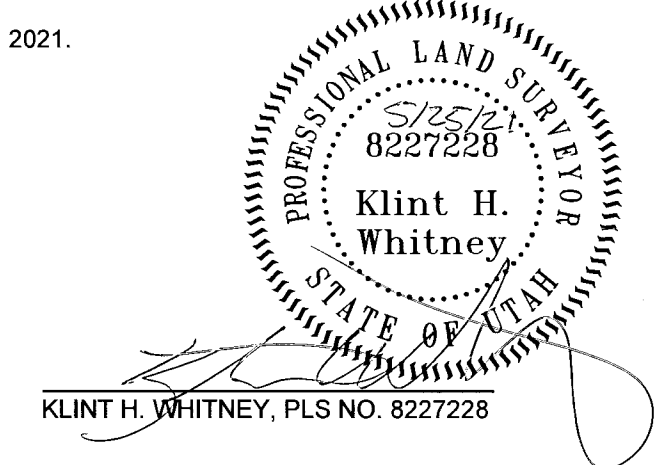

REVISIONS	DATE	DESCRIPTION

SCALE: 1/40 AREF
DATE: 7/1/20
DESIGN: _____
DRAWN: KHW
CHECKED: KHW
DWG.: R:\2021-MISC SURVEYS\2021-JONAH TUATAGALOA\REVISED\JONAH TUATAGALOA.DWG

PROPERTY SURVEY FOR JONAH TUATAGALOA
992 NORTH HARRISVILLE ROAD, HARRISVILLE, UTAH
LOCATED IN THE NORTHWEST QUARTER OF SECTION 8,
TOWNSHIP 6 NORTH, RANGE 1 WEST, S.L.B. AND M.

GARDNER ENGINEERING
CIVIL-LAND PLANNING
MUNICIPAL-LAND SURVEYING
5150 SOUTH 375 EAST OGDEN, UT
OFFICE: 801-476-0202 FAX: 801-476-0066

S1
1