



PARCEL A BOUNDARY DESCRIPTION

A PART OF THE SOUTHWEST QUARTER OF SECTION 33, TOWNSHIP 6 NORTH, RANGE 2 WEST, OF THE SALT LAKE BASE AND MERIDIAN. BEGINNING AT A POINT ON THE WEST LINE OF SAID SOUTHWEST QUARTER BEING LOCATED NORTH 01°22'09" EAST 1331.35 FEET ALONG THE WEST LINE OF SAID SOUTHWEST QUARTER FROM THE SOUTHWEST CORNER OF SAID SOUTHWEST QUARTER; RUNNING THENCE ALONG SAID WEST LINE NORTH 01°22'09" EAST 60.01 FEET; THENCE SOUTH 89°36'38" EAST 176.62 FEET; THENCE SOUTH 01°22'09" WEST 60.01 FEET; THENCE NORTH 89°36'38" WEST 176.62 FEET TO THE POINT OF BEGINNING. CONTAINING 0.243 ACRES.

PARCEL 150890025 BOUNDARY DESCRIPTION

A PART OF THE SOUTHWEST QUARTER OF SECTION 33, TOWNSHIP 6 NORTH, RANGE 2 WEST, OF THE SALT LAKE BASE AND MERIDIAN. BEGINNING AT A POINT BEING LOCATED NORTH 01°22'09" EAST 1331.35 FEET ALONG THE WEST LINE OF SAID SOUTHWEST QUARTER AND SOUTH 89°36'38" EAST 176.62 FEET FROM THE SOUTHWEST CORNER OF SAID SOUTHWEST QUARTER; RUNNING THENCE NORTH 01°22'09" EAST 427.06 FEET; THENCE SOUTH 88°37'51" EAST 638.39 FEET; THENCE SOUTH 01°22'09" WEST 69.60 FEET; THENCE SOUTH 17°30'39" WEST 346.29 FEET; THENCE SOUTH 17°23'18" WEST 5.90 FEET; THENCE SOUTH 25°39'38" WEST 15.59 FEET; THENCE NORTH 89°15'32" WEST 534.53 FEET TO THE POINT OF BEGINNING. CONTAINING 5.797 ACRES.

RECORD PARCEL 150890033 BOUNDARY DESCRIPTION

PART OF THE SOUTHWEST CORNER OF SECTION 33, TOWNSHIP 6 NORTH, RANGE 2 WEST, SALT LAKE BASE & MERIDIAN, HAVING A BASIS OF BEARING OF SOUTH 89D16'10" EAST ALONG THE MONUMENTED SECTION LINE BETWEEN THE SOUTHWEST CORNER AND THE SOUTH QUARTER CORNER OF SAID SECTION 33, THE SOUTHWEST CORNER HAVING COORDINATES OF X= 1842290.23 Y=318261.12 AND THE SOUTH QUARTER CORNER HAVING COORDINATES OF X= 1842290.23 Y=318227.35 OF RECORD IN THE WEBER COUNTY SURVEYORS OFFICE BEING PUBLISHED AS NAD1927 COORDINATES BEGINNING AT A POINT LOCATED 1008.48 FEET SOUTH 89D16'10" EAST ALONG THE MONUMENTED SECTION LINE FROM THE SOUTHWEST CORNER OF SAID SECTION 33, RUNNING THENCE NORTH 01D23'12" EAST 1351.19 FEET, THENCE NORTH 89D16'12" WEST 290.50 FEET TO AN EXISTING FENCE LINE AS DEEDED IN QUIT CLAIM DEED ENTRY 1116299 BK 1585 PAGE 148 WHICH IS ALSO EVIDENCED BY A 1982 SURVEY BY NELSON SURVEYING AND ENGINEERING (CHESTER L NELSON PLS) DRAWING NO PS 82-09, THENCE THE FOLLOWING TWO (2) COURSES ALONG SAID EXISTING FENCE AND THE SURVEY OF CHESTER L NELSON 1) SOUTH 17D23'18" WEST 5.90 FEET 2) SOUTH 25D39'38" WEST 15.59 FEET SAID POINT BEING THE SOUTHEAST CORNER OF PARCEL D OF SAID NELSON SURVEY, THENCE LEAVING SAID FENCE LINE SOUTH 05D24'22" WEST 297.43 FEET TO AN EXISTING FENCE CORNER THENCE SOUTH 00D00'49" WEST 382.06 FEET ALONG AN EXISTING FENCE REPRESENTING THE EAST LINE OF PARCEL B OF A RECORD SURVEY N0001841 OF THE WEBER COUNTY SURVEYORS OFFICE SAID SURVEY BEING DONE IN 1986 BY CHESTER L NELSON, THENCE SOUTH 00D18'03" EAST 256.42 FEET ALONG SAID FENCE BEING DOCUMENTED AS BEING ON THE WEST SIDE OF THE HOOPER CANAL IS SAID 1996 SURVEY TO AN EXISTING FENCE CORNER, THENCE SOUTH 00D44'54" EAST 396.56 FEET ALONG AN EXISTING FENCE LINE TO SECTION LINE, THENCE SOUTH 89D16'10" EAST 285.54 FEET ALONG SAID SECTION LINE TO THE POINT OF BEGINNING. CONTAINING 9.452 ACRES, MORE OR LESS.

SCALE: 1:100 X REF	DATE: 2/28/21
DESIGN: _____	DRAWN: KHW
CHECKED: KHW	DWG. NO.: R-0301-MBC SURVEY 119-1-MATT PETERSON SURVEYING

REVISIONS	DESCRIPTION

PROPERTY SURVEY FOR MATT PETERSON
 +/- 4300 WEST 3300 SOUTH, WEBER COUNTY, UTAH
 LOCATED IN THE SOUTHEAST QUARTER OF SECTION 28,
 TOWNSHIP 7 NORTH, RANGE 1 WEST, S.L.B. AND M.

LEGEND

- ◆ WEBER COUNTY MONUMENT AS NOTED
- SET 24" REBAR AND CAP MARKED GARDNER ENGINEERING
- SUBJECT PROPERTY BOUNDARY
- - - LOT LINE
- - - ADJACENT PARCEL
- - - SECTION LINE
- - - EASEMENT
- X — EXISTING FENCE LINE

NARRATIVE

THE PURPOSE OF THIS SURVEY WAS TO ESTABLISH AND SET THE PROPERTY CORNERS OF THE PARCEL AS SHOWN AND DESCRIBED HEREON. THE SURVEY WAS ORDERED BY MATT PETERSON. THE BASIS OF BEARING IS THE WEST LINE OF THE SOUTHWEST QUARTER OF SECTION 33, TOWNSHIP 5 NORTH, RANGE 2 WEST WHICH BEARS NORTH 01°22'09" EAST, WEBER COUNTY, UTAH NORTH, NAD 83 STATE PLANE GRID BEARING. THE BOUNDARY WAS DETERMINED BY WARRANTY DEEDS RECORDED AS ENTRY NUMBERS 2413724, 2733175 AND DEEDS OF ADJOINING PROPERTY OWNERS. RECORD OF SURVEY NUMBERS 451, 6891, 1841, 5237 AND THE DEDICATED PLAT OF D.M. HADLEY SUBDIVISION WERE ALSO USED TO DETERMINE BOUNDARY LOCATION ALONG WITH THE FOUND MONUMENTS AS SHOWN AND DESCRIBED HEREON.

SURVEYOR'S CERTIFICATE

I, KLINT H. WHITNEY, DO HEREBY CERTIFY THAT I AM A LICENSED PROFESSIONAL LAND SURVEYOR IN THE STATE OF UTAH AND THAT I HOLD CERTIFICATE NO. 8227228 IN ACCORDANCE WITH TITLE 58, CHAPTER 22, OF THE PROFESSIONAL ENGINEERS AND LAND SURVEYORS ACT; I FURTHER CERTIFY THAT BY AUTHORITY OF THE OWNERS I HAVE COMPLETED A SURVEY OF THE PROPERTY DESCRIBED ON THIS RECORD OF SURVEY PLAT IN ACCORDANCE WITH SECTION 17-23-20 AND HAVE VERIFIED ALL MEASUREMENTS; THAT THE REFERENCE MONUMENTS SHOWN ON THIS RECORD OF SURVEY PLAT ARE LOCATED AS INDICATED AND ARE SUFFICIENT TO RETRACE OR REESTABLISH THIS SURVEY; AND THAT THE INFORMATION SHOWN HEREIN IS SUFFICIENT TO ACCURATELY ESTABLISH THE LATERAL BOUNDARIES OF THE HEREIN DESCRIBED TRACT OF REAL PROPERTY.

SIGNED THIS 25TH DAY OF MAY, 2021.

SOUTH QUARTER CORNER SEC. 33, T5N, R2W, S.L.B.&M. (FOUND WEBER COUNTY BRASS CAP MONUMENT 8" BELOW ROAD SURFACE GOOD COND. 2020)

SOUTHWEST CORNER SEC. 33, T5N, R2W, S.L.B.&M. (FOUND WEBER COUNTY BRASS CAP MONUMENT 8" BELOW ROAD SURFACE POOR COND.)

RECEIVED
 MAY 26 2021
 BY: 6882

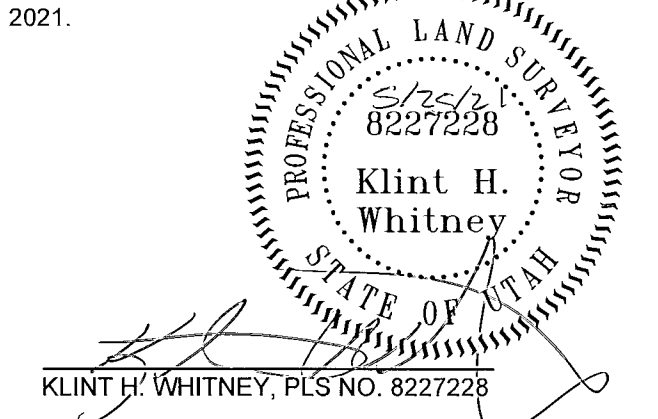

GARDNER ENGINEERING
 CIVIL-LAND PLANNING
 MUNICIPAL-LAND SURVEYING
 5150 SOUTH 375 EAST OGDEN, UT
 OFFICE: 801-476-0202 FAX: 801-476-0066

S1
 1