

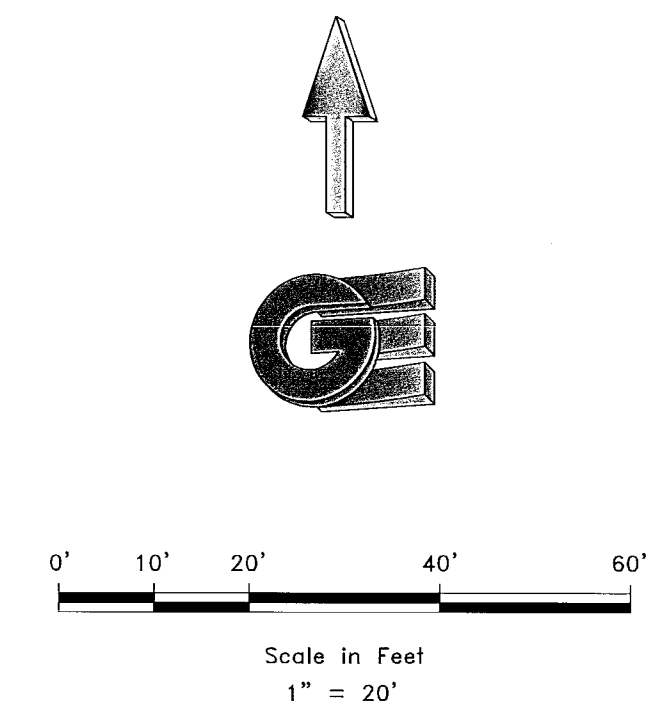

BOUNDARY DESCRIPTION
 ALL OF LOT 11R, SPENCER FARMS SUBDIVISION, MARRIOTTSLATERVILLE CITY, WEBER COUNTY, UTAH.

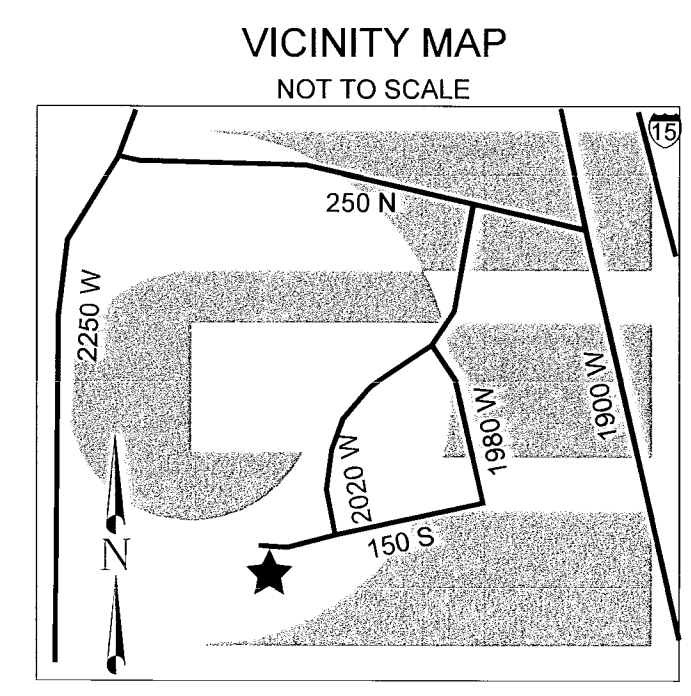

- LEGEND**
- ◆ STREET CENTERLINE MONUMENT AS NOTED
 - SET 24" REBAR AND CAP MARKED GARDNER ENGINEERING
 - SUBJECT PROPERTY BOUNDARY
 - - - ADJACENT PARCEL
 - SECTION LINE
 - - - STREET CENTERLINE

NARRATIVE

THE PURPOSE OF THIS SURVEY WAS TO ESTABLISH AND SET THE PROPERTY CORNERS OF THE PARCEL AS SHOWN AND DESCRIBED HEREON. THE SURVEY WAS ORDERED BY SCOTT MILLER, THE BASIS OF BEARING IS THE STREET CENTERLINE OF 150 SOUTH BETWEEN 2020 WEST STREET AND 1980 WEST, WHICH BEARS SOUTH 77°34'16" WEST, WEBER COUNTY, UTAH NORTH, NAD 83 STATE PLANE GRID BEARING. THE BOUNDARY WAS DETERMINED BY WARRANTY DEED RECORDED AS ENTRY NUMBER 3041250, AND DEEDS OF ADJOINING PROPERTY OWNERS. THE DEDICATED PLAT OF SPENCER FARMS SUBDIVISION WAS ALSO USED TO DETERMINE BOUNDARY LOCATION ALONG WITH THE FOUND MONUMENTS AS SHOWN AND DESCRIBED HEREON.

SURVEYOR'S CERTIFICATE

I, KLINT H. WHITNEY, DO HEREBY CERTIFY THAT I AM A LICENSED PROFESSIONAL LAND SURVEYOR IN THE STATE OF UTAH AND THAT I HOLD CERTIFICATE NO. 8227228 IN ACCORDANCE WITH TITLE 58, CHAPTER 22, OF THE PROFESSIONAL ENGINEERS AND LAND SURVEYORS ACT. I FURTHER CERTIFY THAT BY AUTHORITY OF THE OWNERS I HAVE COMPLETED A SURVEY OF THE PROPERTY DESCRIBED ON THIS RECORD OF SURVEY PLAT IN ACCORDANCE WITH SECTION 17-23-20 AND HAVE VERIFIED ALL MEASUREMENTS; THAT THE REFERENCE MONUMENTS SHOWN ON THIS RECORD OF SURVEY PLAT ARE LOCATED AS INDICATED AND ARE SUFFICIENT TO RETRACE OR REESTABLISH THIS SURVEY; AND THAT THE INFORMATION SHOWN HEREIN IS SUFFICIENT TO ACCURATELY ESTABLISH THE LATERAL BOUNDARIES OF THE HEREIN DESCRIBED TRACT OF REAL PROPERTY.

SIGNED THIS 25TH DAY OF MAY, 2021.

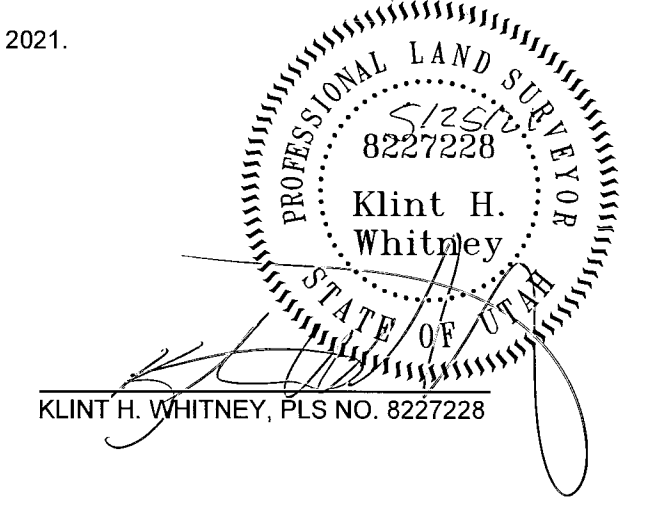

RECEIVED
 MAY 26 2021
 BY: 6885

SCALE:	1:20 X-REF
DATE:	7/1/20
DESIGN:	
DRAWN:	KHW
CHECKED:	KHW

REVISIONS	DESCRIPTION
DATE	

DWG. NO. R-3001 - MEC SURVEY 116 - SCOTT MILLER SURVEYORS/SCOTT MILLER DWS

PROPERTY SURVEY FOR SCOTT MILLER
 2085 W 150 S, MARRIOTT-SLATERVILLE, UTAH
 LOCATED IN THE NORTHEAST QUARTER OF SECTION 14,
 TOWNSHIP 6 NORTH, RANGE 2 WEST, S.L.B. AND M.

GARDNER ENGINEERING
 CIVIL-LAND PLANNING
 MUNICIPAL-LAND SURVEYING
 5150 SOUTH 375 EAST OGDEN, UT
 OFFICE: 801-476-0202 FAX: 801-476-0066

S1
 1