

**BOUNDARY DESCRIPTION**

A PART OF THE NORTHEAST QUARTER OF SECTION 26, TOWNSHIP 6 NORTH, RANGE 2 WEST, OF THE SALT LAKE BASE AND MERIDIAN, BEGINNING AT A POINT ON THE WEST RIGHT-OF-WAY LINE OF 1900 WEST STREET BEING LOCATED NORTH 00°50'13" EAST 674.59 FEET ALONG THE EAST LINE OF SAID NORTHEAST QUARTER, RUNNING THENCE ALONG SAID RIGHT-OF-WAY LINE OF 1900 WEST AND THE NORTH RIGHT-OF-WAY LINE OF 2100 SOUTH STREET THE FOLLOWING SEVEN (7) COURSES: (1) NORTH 31°22'47" WEST 37.48 FEET; (2) SOUTH 00°50'38" WEST 21.50 FEET; (3) NORTH 89°29'29" WEST 200.31 FEET; (4) SOUTH 83°12'38" WEST 102.34 FEET; (5) SOUTH 87°51'42" WEST 40.83 FEET; (6) SOUTH 85°12'52" WEST 203.94 FEET; (7) SOUTH 88°00'38" WEST 35.04 FEET TO THE EAST BOUNDARY LINE OF THE NAMPIL SUBDIVISION; THENCE ALONG SAID EAST LINE THE FOLLOWING TWO (2) COURSES: (1) NORTH 00°50'13" EAST 552.34 FEET; (2) NORTH 74°48'18" WEST 39.49 FEET; THENCE NORTH 00°50'13" EAST 32.30 FEET TO THE SOUTHERLY LINE OF A RAIL SPUR; THENCE ALONG THE SOUTHERLY LINE OF SAID RAIL SPUR THE FOLLOWING FIVE (5) COURSES: (1) ALONG THE ARC OF A 434.56 FOOT RADIUS CURVE TO THE RIGHT 156.69 FEET, HAVING A CENTRAL ANGLE OF 20°39'33", CHORD BEARS SOUTH 63°04'21" EAST 155.84 FEET; (2) SOUTH 53°19'46" EAST 383.89 FEET; (3) ALONG THE ARC OF A 439.36 FOOT RADIUS CURVE TO THE RIGHT 219.45 FEET, HAVING A CENTRAL ANGLE OF 28°37'05", CHORD BEARS SOUTH 39°01'13" EAST 217.18 FEET; (4) SOUTH 23°46'59" EAST 93.00 FEET; (5) ALONG THE ARC OF A 570.67 FOOT RADIUS CURVE TO THE LEFT 22.11 FEET, HAVING A CENTRAL ANGLE OF 02°13'11", CHORD BEARS SOUTH 24°53'35" EAST 22.11 FEET TO SAID WEST RIGHT-OF-WAY LINE; THENCE ALONG SAID WEST RIGHT-OF-WAY LINE SOUTH 00°50'13" WEST 1.63 FEET TO THE POINT OF BEGINNING. CONTAINING 4.771 ACRES.

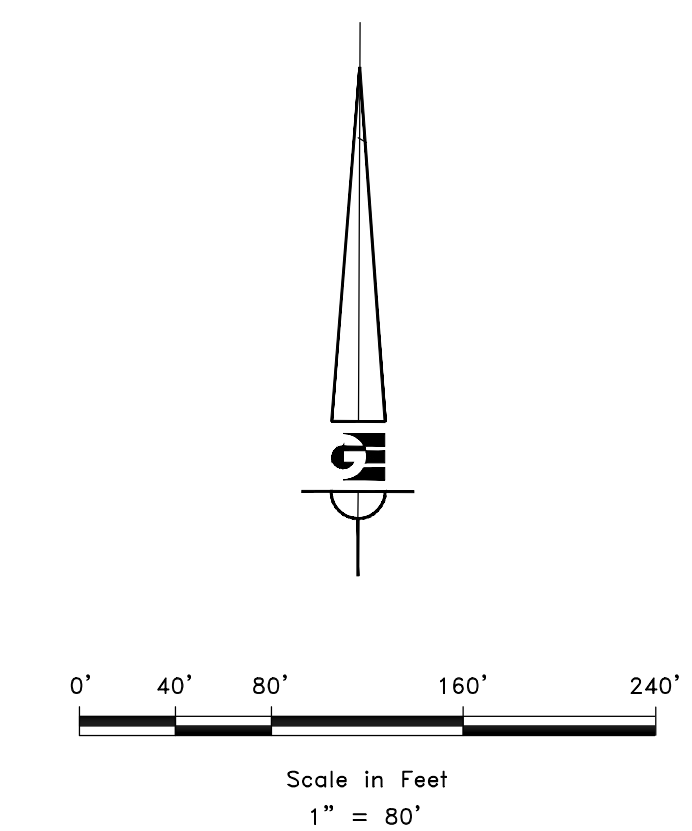

**LEGEND**

- ◆ WEBER COUNTY MONUMENT AS NOTED
- SET 24" REBAR AND CAP MARKED GARDNER ENGINEERING
- SUBDIVISION BOUNDARY
- LOT LINE
- - - ADJACENT PARCEL
- - - SECTION LINE
- - - EASEMENT
- - - EXISTING FENCE LINE

**NARRATIVE**

THE PURPOSE OF THIS SURVEY WAS TO ESTABLISH AND SET THE PROPERTY CORNERS OF THE PARCEL AS SHOWN AND DESCRIBED HEREON. THE SURVEY WAS ORDERED BY BRENT BAILEY. PARCEL "A" IS NOT APPROVED FOR DEVELOPMENT AT THIS TIME AND WILL NEED TO GO THROUGH THE WEST HAVEN CITY SUBDIVISION PROCESS TO RECEIVE BUILDING ENTITLEMENTS. THE BASIS OF BEARING IS THE EAST LINE OF THE NORTHEAST QUARTER OF SECTION 26, TOWNSHIP 6 NORTH, RANGE 2 WEST, WHICH BEARS NORTH 00°50'13" EAST, WEBER COUNTY, UTAH NORTH, NAD 83 STATE PLANE GRID BEARING. THE BOUNDARY WAS DETERMINED BY WARRANTY DEEDS RECORDED AS ENTRY NUMBERS 2791981, 1750506, AND DEEDS OF ADJOINING PROPERTY OWNERS. RECORD OF SURVEY NUMBERS 8566, 4000, 6376, AND THE DEDICATED PLATS OF NAMPIL SUBDIVISION WERE ALSO USED TO DETERMINE BOUNDARY LOCATION ALONG WITH THE FOUND MONUMENTS AS SHOWN AND DESCRIBED HEREON.

**SURVEYOR'S CERTIFICATE**

I, KLINT H. WHITNEY, DO HEREBY CERTIFY THAT I AM A LICENSED PROFESSIONAL LAND SURVEYOR IN THE STATE OF UTAH AND THAT I HOLD CERTIFICATE NO. 8227228 IN ACCORDANCE WITH TITLE 58, CHAPTER 22, OF THE PROFESSIONAL ENGINEERS AND LAND SURVEYORS ACT; I FURTHER CERTIFY THAT BY AUTHORITY OF THE OWNERS I HAVE COMPLETED A SURVEY OF THE PROPERTY DESCRIBED ON THIS RECORD OF SURVEY PLAT IN ACCORDANCE WITH SECTION 17-23-20 AND HAVE VERIFIED ALL MEASUREMENTS; THAT THE REFERENCE MONUMENTS SHOWN ON THIS RECORD OF SURVEY PLAT ARE LOCATED AS INDICATED AND ARE SUFFICIENT TO RETRACE OR REESTABLISH THIS SURVEY; AND THAT THE INFORMATION SHOWN HEREIN IS SUFFICIENT TO ACCURATELY ESTABLISH THE LATERAL BOUNDARIES OF THE HEREIN DESCRIBED TRACT OF REAL PROPERTY.

SIGNED THIS 13TH DAY OF SEPTEMBER, 2021.

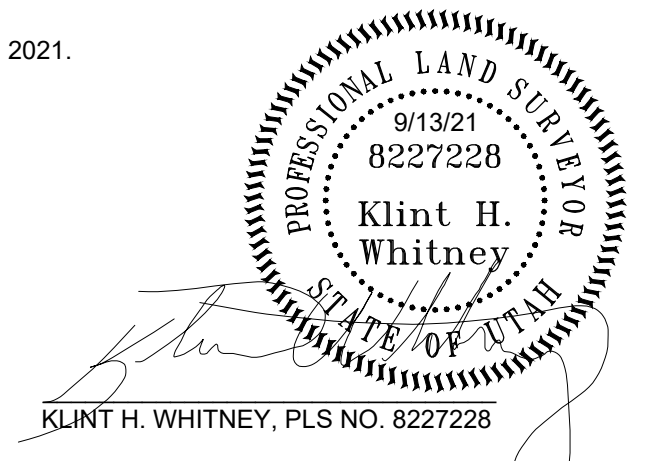

RECEIVED  
SEP 17 2021  
FILE # 6984

SCALE: 1" = 80'	DATE: 6/3/21	DESIGN: KHW	DRAWN: KHW	CHECKED: KHW
REVISIONS	DESCRIPTION			
DATE				

DWG. NO. 150710055-NORTH-BOUNDARY-EXHIBIT.DWG

PROPERTY SURVEY FOR BRENT BAILEY  
2100 SOUTH 1900 WEST, WEST HAVEN, UTAH  
LOCATED IN THE NORTHEAST QUARTER OF SECTION 26,  
TOWNSHIP 6 NORTH, RANGE 2 WEST, S.L.B. AND M.

**GARDNER ENGINEERING**  
CIVIL-LAND PLANNING  
MUNICIPAL-LAND SURVEYING  
5150 SOUTH 375 EAST OGDEN, UT  
OFFICE: 801.476.0202 FAX: 801.476.0066

S1  
1