

BOUNDARY DESCRIPTION

THE WEST 12.5 FEET OF THE SOUTH 101.10 FEET OF LOT 5 AND THE SOUTH 101.1 FEET OF LOT 6, BLOCK 9, TERRACE SUBDIVISION IN OGDEN CITY WEBER COUNTY MORE PARTICULARLY DESCRIBED AS FOLLOWS:

BEGINNING THE A POINT ON THE NORTH RIGHT-OF-WAY LINE OF CROSS STREET BEING LOCATED SOUTH 88°55'39" EAST 204.50 FEET ALONG THE MONUMENTED CENTERLINE OF CROSS STREET AND NORTH 01°10'02" EAST 25.00 FEET FROM THE CENTERLINE INTERSECTION MONUMENT AT GRANT AVENUE AND CROSS STREET; RUNNING THENCE NORTH 01°10'02" EAST 101.55 FEET; THENCE SOUTH 88°52'36" EAST 37.50 FEET; THENCE SOUTH 01°10'02" WEST 100.52 FEET; TO SAID NORTH RIGHT-OF-WAY LINE; THENCE ALONG SAID NORTH RIGHT-OF-WAY LINE NORTH 88°55'39" WEST 37.50 FEET TO THE POINT OF BEGINNING. CONTAINING 3791 SQUARE FEET.

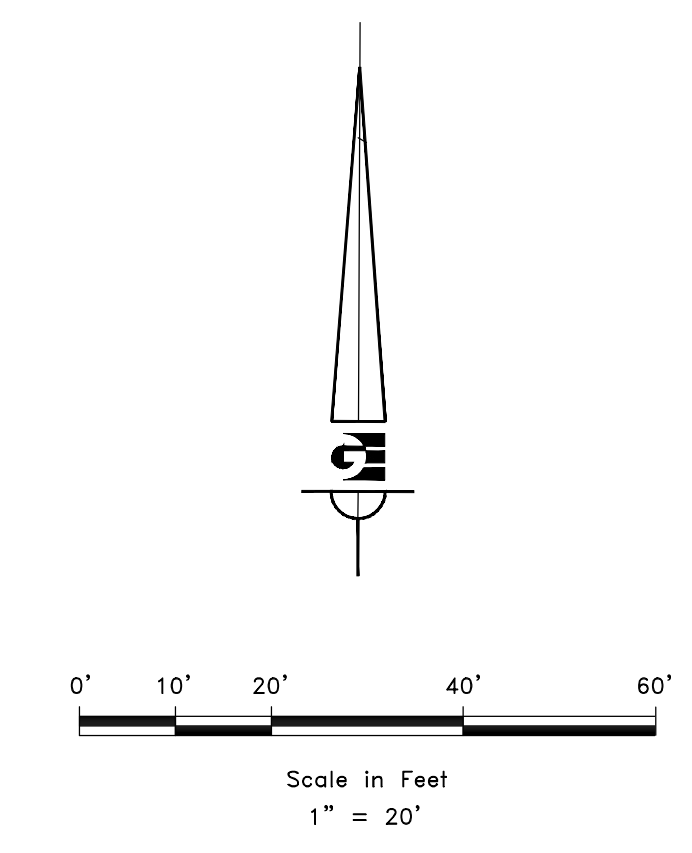

- LEGEND**
- ◆ OGDEN CITY MONUMENT AS NOTED
 - SET 24" REBAR AND CAP MARKED GARDNER ENGINEERING
 - SUBJECT PROPERTY BOUNDARY
 - LOT LINE
 - - - ADJACENT PARCEL
 - - - SECTION LINE
 - - - EASEMENT
 - - - EXISTING FENCE LINE

NARRATIVE

THE PURPOSE OF THIS SURVEY WAS TO ESTABLISH THE BOUNDARIES OF THE PARCEL AS SHOWN AND DESCRIBED HEREON. THE SURVEY WAS ORDERED BY KEVIN PEREZ, FINAL ORDER AND JUDGMENT CASE NO. 180900689 RECORDED AS ENTRY NUMBER 2923179, HISTORICAL DEED RECORDED AS ENTRY NUMBER 942201, THE DEDICATED PLAT OF THE TERRACE SUBDIVISION TO OGDEN CITY UTAH, FOUND OGDEN CITY CENTERLINE MONUMENTS AND FOUND PROPERTY CORNERS FROM RECORDED SURVEYS OF ADJOINING PROPERTIES WERE USED TO DETERMINE THE BOUNDARY. THE BASIS OF BEARING IS THE CENTERLINE OF 9TH STREET BETWEEN THE OGDEN CITY MONUMENTS AT THE INTERSECTION OF GRANT AVENUE AND WASHINGTON BOULEVARD WHICH BEAR SOUTH 88°49'33" EAST, WEBER COUNTY, UTAH NORTH, NAD 83 STATE PLANE GRID BEARING.

SURVEYOR'S CERTIFICATE

I, KLINT H. WHITNEY, DO HEREBY CERTIFY THAT I AM A LICENSED PROFESSIONAL LAND SURVEYOR IN THE STATE OF UTAH AND THAT I HOLD CERTIFICATE NO. 8227228 IN ACCORDANCE WITH TITLE 58, CHAPTER 22, OF THE PROFESSIONAL ENGINEERS AND LAND SURVEYORS ACT; I FURTHER CERTIFY THAT BY AUTHORITY OF THE OWNERS I HAVE COMPLETED A SURVEY OF THE PROPERTY DESCRIBED ON THIS RECORD OF SURVEY PLAT IN ACCORDANCE WITH SECTION 17-23-20 AND HAVE VERIFIED ALL MEASUREMENTS; THAT THE REFERENCE MONUMENTS SHOWN ON THIS RECORD OF SURVEY PLAT ARE LOCATED AS INDICATED AND ARE SUFFICIENT TO RETRACE OR REESTABLISH THIS SURVEY; AND THAT THE INFORMATION SHOWN HEREIN IS SUFFICIENT TO ACCURATELY ESTABLISH THE LATERAL BOUNDARIES OF THE HEREIN DESCRIBED TRACT OF REAL PROPERTY.

SIGNED THIS 7TH DAY OF SEPTEMBER, 2021.

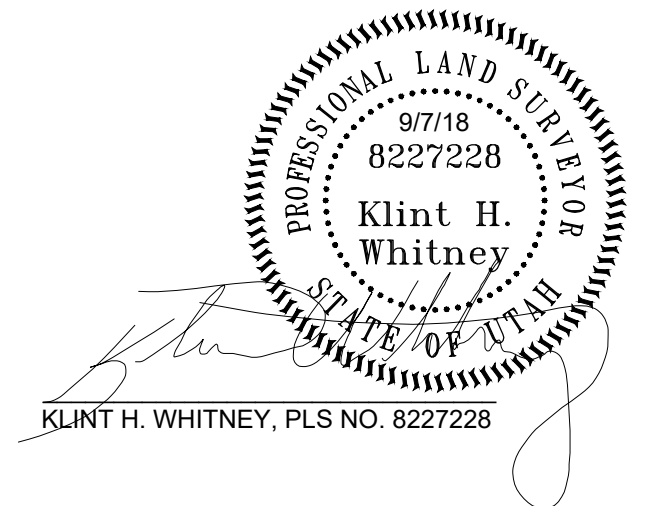

SCALE:	1:20, XREF
DATE:	4/16/15
DESIGN:	
DRAWN:	KHW
CHECKED:	KHW

REVISIONS	DESCRIPTION
DATE	

PROPERTY SURVEY FOR KEVIN PEREZ
 322 CROSS STREET, OGDEN, UTAH
 LOCATED IN THE NORTHEAST QUARTER OF SECTION 20,
 TOWNSHIP 6 NORTH, RANGE 1 WEST, S.L.B. AND M.

GARDNER ENGINEERING
 CIVIL-LAND PLANNING
 MUNICIPAL-LAND SURVEYING

5150 SOUTH 375 EAST OGDEN, UT
 OFFICE: 801.476.0202 FAX: 801.476.0066

S1
1

RECEIVED
 SEP 17 2021
 FILE # 6987