

RECORD PARCEL 150800028 BOUNDARY DESCRIPTION
 ALL OF LOT 1, J AND J SUBDIVISION, WEBER COUNTY, UTAH, EXCEPTING THE EAST 304.69 FEET.

RECORD PARCEL 150800049 BOUNDARY DESCRIPTION
 THE EAST 304.69 FEET OF LOT 1, J AND J SUBDIVISION, WEBER COUNTY, UTAH.

RECORD PARCEL 150800029 BOUNDARY DESCRIPTION
 PART OF THE NORTHEAST QUARTER OF SECTION 29, TOWNSHIP 6 NORTH, RANGE 2 WEST, SALT LAKE MERIDIAN, U. S. SURVEY; BEGINNING AT A POINT 829 FEET NORTH OF THE SOUTHWEST CORNER OF SAID NORTHEAST QUARTER; RUNNING THENCE NORTH 155 FEET; THENCE EAST 660 FEET; THENCE SOUTH 155 FEET; THENCE WEST 660 FEET TO THE PLACE OF BEGINNING.

RECORD PARCEL 150800014 BOUNDARY DESCRIPTION
 PART OF THE NORTHEAST QUARTER OF SECTION 29, TOWNSHIP 6 NORTH, RANGE 2 WEST, SALT LAKE MERIDIAN, U. S. SURVEY; BEGINNING AT A POINT 654 FEET NORTH OF THE SOUTHWEST CORNER OF SAID NORTHEAST QUARTER; RUNNING THENCE NORTH 175 FEET; THENCE EAST 660 FEET; THENCE SOUTH 175 FEET; THENCE WEST 660 FEET TO THE PLACE OF BEGINNING. EXCEPTING THEREFROM THAT PORTION INCLUDED WITHIN 4700 WEST STREET.

RECORD PARCEL 150800057 BOUNDARY DESCRIPTION
 PART OF THE NORTHEAST QUARTER OF SECTION 29, TOWNSHIP 6 NORTH, RANGE 2 WEST, SALT LAKE MERIDIAN, U. S. SURVEY; BEGINNING AT A POINT 40 RODS EAST AND 80 RODS SOUTH OF THE NORTHWEST CORNER OF SAID QUARTER SECTION AND RUNNING THENCE EAST 20 RODS, THENCE SOUTH 80 RODS, THENCE WEST 330.00 FEET, THENCE NORTH 629 FEET, MORE OR LESS, THENCE WEST 3 FEET, THENCE NORTH 691 FEET TO THE POINT OF BEGINNING. EXCEPTING THEREFROM ANY PORTION LYING WITHIN COUNTY ROAD.

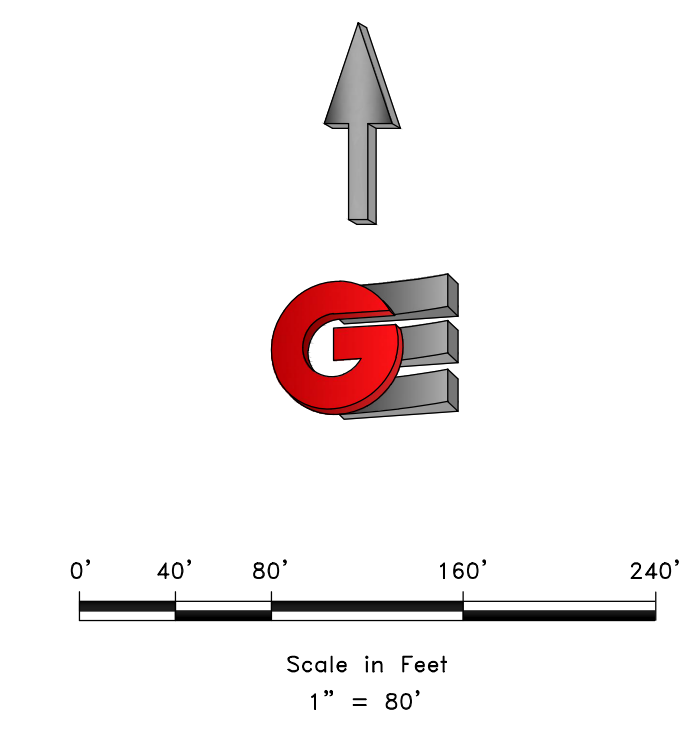

- LEGEND**
- ◆ WEBER COUNTY MONUMENT AS NOTED
 - SET 24" REBAR AND CAP MARKED GARDNER ENGINEERING
 - SUBJECT PROPERTY BOUNDARY
 - LOT LINE
 - - - ADJACENT PARCEL
 - - - SECTION LINE
 - - - EASEMENT
 - - - EXISTING FENCE LINE
 - FOUND PROPERTY CORNER AS NOTED

RECEIVED
 OCT 13 2021
 FILE # 7022

NARRATIVE

THE PURPOSE OF THIS SURVEY WAS TO ESTABLISH AND SET THE PROPERTY CORNERS OF THE PARCEL AS SHOWN AND DESCRIBED HEREON. THE SURVEY WAS ORDERED BY STEVE GRANGE. THE BASIS OF BEARING IS THE WEST LINE OF THE NORTHWEST QUARTER OF SECTION 29, WHICH BEARS NORTH 00°36'21" EAST, WEBER COUNTY, UTAH NORTH, NAD 83 STATE PLANE GRID BEARING. THE BOUNDARY WAS DETERMINED BY WARRANTY DEEDS RECORDED AS ENTRY NUMBERS 3124358, 3007299, 3007298, 3007297, 2356676 AND DEEDS OF ADJOINING PROPERTY OWNERS: RECORD OF SURVEY NUMBERS 209, 4, AND THE DEDICATED PLATS OF J AND J SUBDIVISION AND KIRBY ACRES WERE ALSO USED TO DETERMINE BOUNDARY LOCATION ALONG WITH THE FOUND MONUMENTS AS SHOWN AND DESCRIBED HEREON.

SURVEYOR'S CERTIFICATE

I, KLINT H. WHITNEY, DO HEREBY CERTIFY THAT I AM A LICENSED PROFESSIONAL LAND SURVEYOR IN THE STATE OF UTAH AND THAT I HOLD CERTIFICATE NO. 8227228 IN ACCORDANCE WITH TITLE 58, CHAPTER 22, OF THE PROFESSIONAL ENGINEERS AND LAND SURVEYORS ACT; I FURTHER CERTIFY THAT BY AUTHORITY OF THE OWNERS I HAVE COMPLETED A SURVEY OF THE PROPERTY DESCRIBED ON THIS RECORD OF SURVEY PLAT IN ACCORDANCE WITH SECTION 17-23-20 AND HAVE VERIFIED ALL MEASUREMENTS; THAT THE REFERENCE MONUMENTS SHOWN ON THIS RECORD OF SURVEY PLAT ARE LOCATED AS INDICATED AND ARE SUFFICIENT TO RETRACE OR REESTABLISH THIS SURVEY; AND THAT THE INFORMATION SHOWN HEREIN IS SUFFICIENT TO ACCURATELY ESTABLISH THE LATERAL BOUNDARIES OF THE HEREIN DESCRIBED TRACT OF REAL PROPERTY.

SIGNED THIS 13TH DAY OF OCTOBER, 2021.

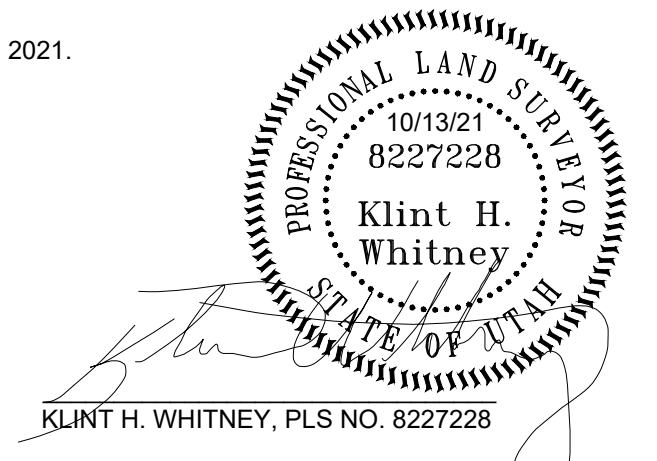

SCALE: 1" = 80'	DATE: 9/22/21	DESIGN: _____	DRAWN: KHW	CHECKED: KHW
REVISIONS		DESCRIPTION		
DATE	DESCRIPTION			
DWG. NO.: 1508000148 - STEVE GRANGE SURVEYING GRANGE 4700 WEST.DWG				

PROPERTY SURVEY FOR STEVE GRANGE
 +/- 4700 WEST 2200 SOUTH, WEBER COUNTY, UTAH
 LOCATED IN THE NORTHEAST QUARTER OF SECTION 29,
 TOWNSHIP 6 NORTH, RANGE 2 WEST, S.L.B. AND M.

GARDNER ENGINEERING
 CIVIL-LAND PLANNING
 MUNICIPAL-LAND SURVEYING
 5150 SOUTH 375 EAST OGDEN, UT
 OFFICE: 801.476.0202 FAX: 801.476.0066

S1
 1