

**BOUNDARY DESCRIPTION**

ALL OF LOT 17, SOUTH FORK RANCHETTES SUBDIVISION, WEBER COUNTY, UTAH ACCORDING TO THE OFFICIAL PLAT THEREOF ON FILE AT BOOK 17, PAGE 40 OF THE WEBER COUNTY RECORDS.

THOMAS GOMPERT  
210450003

325 SOUTH STREET

N90°00'00"E 1327.31'

N89°52'18"E 327.70'

WEST 1/4 COR. SECT. 15  
T6N, R2E, S.L.B.&M.

ASHMENT REVOCABLE  
LIVING TRUST  
210450010

JESSE ROWE  
210450008  
CONTAINING 5.49 ACRES

MICHAEL COSBY  
210450007

12.33' SHED AND FENCE  
ENCROACH

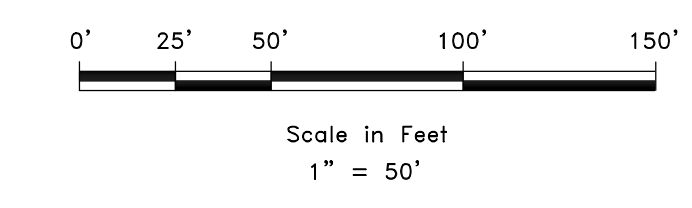
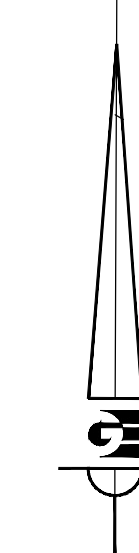

**LEGEND**

- ◆ WEBER COUNTY MONUMENT AS NOTED
- SET 24" REBAR AND CAP MARKED GARDNER ENGINEERING
- SUBJECT PROPERTY BOUNDARY
- LOT LINE
- - - ADJACENT PARCEL
- - - SECTION LINE
- - - EASEMENT
- x - EXISTING FENCE LINE

**RECEIVED**  
OCT 13 2021  
FILE # 7024

**NARRATIVE**

THE PURPOSE OF THIS SURVEY WAS TO ESTABLISH AND SET THE PROPERTY CORNERS OF THE PARCEL AS SHOWN AND DESCRIBED HEREON. THE SURVEY WAS ORDERED BY JESSE ROWE. THE BASIS OF BEARING IS THE WEST LINE OF THE SOUTHWEST QUARTER OF SECTION 15, TOWNSHIP 6 NORTH, RANGE 2 EAST OF THE SALT LAKE BASE AND MERIDIAN WHICH BEARS NORTH 00°03'49" EAST, WEBER COUNTY, UTAH NORTH, NAD 83 STATE PLANE GRID BEARING. THE BOUNDARY WAS DETERMINED BY WARRANTY DEED RECORDED AS ENTRY NUMBER 3092432, AND DEEDS OF ADJOINING PROPERTY OWNERS. THE DEDICATED PLAT OF SOUTH FORK RANCHETTES SUBDIVISION WAS ALSO USED TO DETERMINE BOUNDARY LOCATION ALONG WITH THE FOUND MONUMENTS AS SHOWN AND DESCRIBED HEREON.

**SURVEYOR'S CERTIFICATE**

I, KLINT H. WHITNEY, DO HEREBY CERTIFY THAT I AM A LICENSED PROFESSIONAL LAND SURVEYOR IN THE STATE OF UTAH AND THAT I HOLD CERTIFICATE NO. 8227228 IN ACCORDANCE WITH TITLE 58, CHAPTER 22, OF THE PROFESSIONAL ENGINEERS AND LAND SURVEYORS ACT; I FURTHER CERTIFY THAT BY AUTHORITY OF THE OWNERS I HAVE COMPLETED A SURVEY OF THE PROPERTY DESCRIBED ON THIS RECORD OF SURVEY PLAT IN ACCORDANCE WITH SECTION 17-23-20 AND HAVE VERIFIED ALL MEASUREMENTS; THAT THE REFERENCE MONUMENTS SHOWN ON THIS RECORD OF SURVEY PLAT ARE LOCATED AS INDICATED AND ARE SUFFICIENT TO RETRACE OR REESTABLISH THIS SURVEY; AND THAT THE INFORMATION SHOWN HEREIN IS SUFFICIENT TO ACCURATELY ESTABLISH THE LATERAL BOUNDARIES OF THE HEREIN DESCRIBED TRACT OF REAL PROPERTY.

SIGNED THIS 13TH DAY OF OCTOBER, 2021.

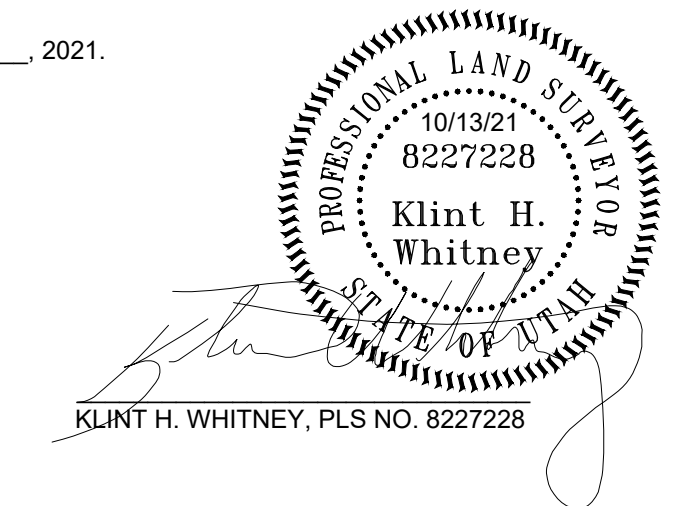

TOWN OF HUNTSVILLE  
210210014

DATE	REVISIONS DESCRIPTION

SCALE: 1" = 50'  
DATE: 10/13/21  
DESIGN:        
DRAWN: KHW  
CHECKED: KHW  
DWG.: PL001 - MISC SURVEY 15 - JESSE ROWE SURVEY FOR JESSE ROWE.DWG

PROPERTY SURVEY FOR JESSE ROWE  
9723 EAST 325 SOUTH, HUNTSVILLE, UTAH  
LOCATED IN SECTION 15,  
TOWNSHIP 6 NORTH, RANGE 2 EAST, S.L.B. AND M.

**GARDNER ENGINEERING**  
CIVIL - LAND PLANNING  
MUNICIPAL - LAND SURVEYING  
5150 SOUTH 375 EAST OGDEN, UT  
OFFICE: 801.476.0202 FAX: 801.476.0066

S1  
1