

BOUNDARY DESCRIPTION

A PART OF THE NORTHEAST QUARTER OF SECTION 29, TOWNSHIP 6 NORTH, RANGE 2 WEST, OF THE SALT LAKE BASE AND MERIDIAN, BEGINNING AT A POINT ON THE WEST RIGHT-OF-WAY LINE OF 4300 WEST BEING LOCATED NORTH 00°49'19" EAST 588.46 FEET ALONG THE EAST LINE OF SAID NORTHEAST QUARTER AND NORTH 90°00'00" WEST 33.00 FEET FROM THE SOUTHWEST CORNER OF SAID NORTHEAST QUARTER; RUNNING THENCE NORTH 89°11'53" WEST 228.50 FEET; THENCE SOUTH 00°49'20" WEST 176.00 FEET; THENCE NORTH 89°11'54" WEST 419.59 FEET; THENCE SOUTH 00°48'06" WEST 411.02 FEET TO THE SOUTH LINE OF SAID NORTHEAST QUARTER; THENCE ALONG SAID SOUTH LINE NORTH 89°17'11" WEST 635.66 FEET; THENCE NORTH 00°42'49" EAST 1982.21 FEET TO AN EXISTING FENCE LINE; THENCE ALONG SAID EXISTING FENCE LINE SOUTH 88°57'39" EAST 1320.37 FEET TO THE EAST LINE OF SAID NORTHEAST QUARTER; THENCE ALONG SAID EAST LINE SOUTH 00°49'19" WEST 647.15 FEET; THENCE NORTH 89°06'58" WEST 33.00 FEET TO THE WEST RIGHT-OF-WAY LINE OF SAID 4300 WEST STREET; THENCE ALONG SAID WEST RIGHT-OF-WAY LINE SOUTH 00°49'19" WEST 741.63 FEET TO THE POINT OF BEGINNING. CONTAINING 51.84 ACRES.

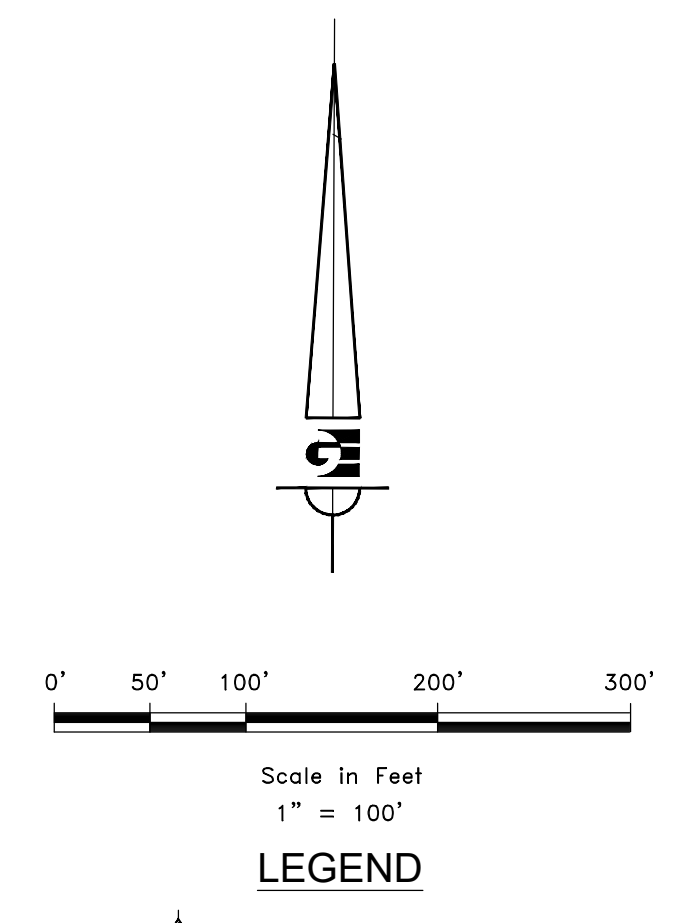

- LEGEND**
- ◆ WEBER COUNTY MONUMENT AS NOTED
 - SET 24" REBAR AND CAP MARKED GARDNER ENGINEERING
 - SUBDIVISION BOUNDARY
 - LOT LINE
 - - - ADJACENT PARCEL
 - - - SECTION LINE
 - - - EASEMENT
 - - - EXISTING FENCE LINE
 - - - EXISTING WATER LINE
 - - - EXISTING IRRIGATION LINE
 - - - EXISTING STORM DRAIN
 - - - EXISTING SANITARY SEWER
 - - - EXISTING OVERHEAD POWER
 - - - EXISTING GAS LINE
 - ⊕ EXISTING WATER METER
 - ⊙ EXISTING WATER MANHOLE
 - ⊕ EXISTING FIRE HYDRANT
 - ⊕ EXISTING WATER VALVE
 - ⊕ EXISTING STORM MANHOLE
 - ⊕ EXISTING CATCH BASIN
 - ⊕ EXISTING SEWER MANHOLE

RECEIVED
DEC 6 2021
FILE # 7072

NARRATIVE

THE PURPOSE OF THIS SURVEY WAS TO CONDUCT A TOPOGRAPHIC SURVEY, ESTABLISH AND SET THE PROPERTY CORNERS OF THE PARCEL AS SHOWN AND DESCRIBED HEREON. THE SURVEY WAS ORDERED BY WEBER SCHOOL DISTRICT. THE BASIS OF BEARING IS THE EAST LINE OF THE NORTHEAST QUARTER OF SECTION 29, TOWNSHIP 6 NORTH, RANGE 2 WEST, OF THE SALT LAKE BASE AND MERIDIAN WHICH BEARS NORTH 00°49'19" EAST, WEBER COUNTY, UTAH NORTH, NAD 83 STATE PLANE GRID BEARING. THE BOUNDARY WAS DETERMINED BUY WARRANTY DEED RECORDED AS ENTRY NUMBER 254667, AND DEEDS OF ADJOINING PROPERTY OWNERS. THE DEDICATED PLATS OF RACKLIFF SUBDIVISION, HADLEY HOMESTEAD, AND SUNSET EQUESTRIAN CLUSTER SUBDIVISION WERE ALSO USED TO DETERMINE BOUNDARY LOCATION ALONG WITH THE FOUND MONUMENTS AS SHOWN AND DESCRIBED HEREON.

SURVEYOR'S CERTIFICATE

I, KLINT H. WHITNEY, DO HEREBY CERTIFY THAT I AM A LICENSED PROFESSIONAL LAND SURVEYOR IN THE STATE OF UTAH AND THAT I HOLD CERTIFICATE NO. 8227228 IN ACCORDANCE WITH TITLE 58, CHAPTER 22, OF THE PROFESSIONAL ENGINEERS AND LAND SURVEYORS ACT; I FURTHER CERTIFY THAT BY AUTHORITY OF THE OWNERS I HAVE COMPLETED A SURVEY OF THE PROPERTY DESCRIBED ON THIS RECORD OF SURVEY PLAT IN ACCORDANCE WITH SECTION 17-23-20 AND HAVE VERIFIED ALL MEASUREMENTS; THAT THE REFERENCE MONUMENTS SHOWN ON THIS RECORD OF SURVEY PLAT ARE LOCATED AS INDICATED AND ARE SUFFICIENT TO RETRACE OR REESTABLISH THIS SURVEY; AND THAT THE INFORMATION SHOWN HEREIN IS SUFFICIENT TO ACCURATELY ESTABLISH THE LATERAL BOUNDARIES OF THE HEREIN DESCRIBED TRACT OF REAL PROPERTY.

SIGNED THIS 2nd DAY OF DECEMBER, 2020.

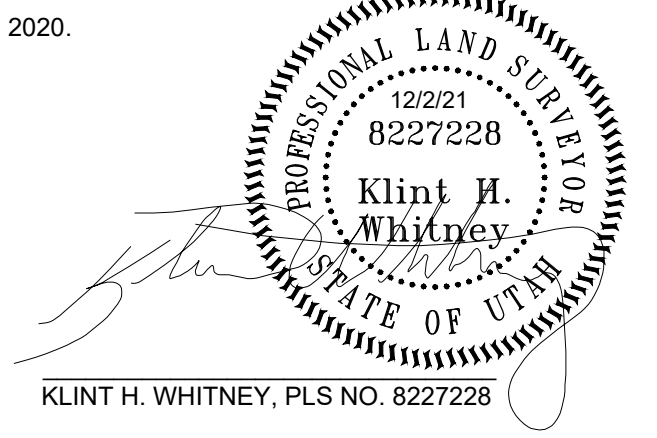

SCALE:	1:100 XREF
DATE:	2/28/20
DESIGN:	
DRAWN:	KHW
CHECKED:	KHW
DWG. NO.:	10311 - WEBER SCHOOL DISTRICT (SEE: WEBER COUNTY RECORDS SECTION 29, TOWNSHIP 6 NORTH, RANGE 2 WEST, S.L.B. AND M.)

REVISIONS	DESCRIPTION
DATE	

BOUNDARY TOPOGRAPHIC SURVEY FOR WEBER SCHOOL DISTRICT +/2200 S. 4300 W., WEBER COUNTY LOCATED IN THE NORTHEAST QUARTER OF SECTION 29, TOWNSHIP 6 NORTH, RANGE 2 WEST, S.L.B. AND M.

GARDNER ENGINEERING
CIVIL-LAND PLANNING
MUNICIPAL-LAND SURVEYING

5150 SOUTH 375 EAST OGDEN, UT
OFFICE: 801.476.0202 FAX: 801.476.0066

S1

1