

Northwest Corner Section 8, West Salt Lake Base and Meridian, Find Weber County Brass Cap condition above surface in good condition

$N89^{\circ}53'47''W$ 5597.36' (Meas)
 $N89^{\circ}50'43''W$ 5597.19' (Rec)

Northwest Corner Section 8, West Salt Lake Base and Meridian, Find Weber County Brass Cap flush with surface in good condition

NARRATIVE:
 Boundary Consultants was retained by Barbara Adams to survey the subject parcel and retroce the Nealys Subdivision prepared by Doug L. Grohm, Landmark Surveying and Engineering, recorded in Book 62 at Page 002 of the Weber County Records.
 This survey was carried out using a Trimble RRS GPS System, with ground control points established in the area. The survey is North 000°21'34" East 2650.59 feet measured between the Weber County Brass Cap Monument monumenting the East line of the Northeast Quarter of Section 8, Township 7 North, Range 2 West, Salt Lake Base and Meridian. Two corners of the subject parcel have not been set as they fall in areas of water retention. Evidence of prior surveys have been noted on the survey hereon.

DESCRIPTION:

WARRANTY DEED- ENTRY #2653729:
 Lot 1, NEALYS SUBDIVISION AMENDED LOT 1, according to the Official Plat thereof as recorded in the Office of the Weber County Recorder, State of Utah.

RUSSELL ACRES
 BOOK 84, PAGE 035

ROS 899A

RUSSELL, SHAWN & WF JAIME
 15-427-0003

HAPPER, JAMES R
 15-027-0010

SUBJECT PARCEL
 Contains 5.97 acres
 259,897 sq. ft.

LOT 1

NEALYS SUBDIVISION AMENDED
 LOT 2

KRUTBOSCH, GEORGE & DARCY
 15-402-0002

HANCOCK, BLAIR & SUSAN
 15-027-0028

MCCOLLOCH, HEIDI H
 15-027-0049

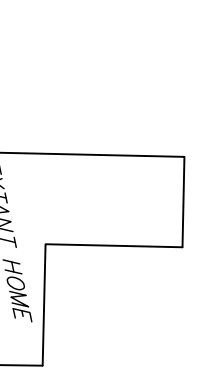

4700 West Street / SR-40

BASIS OF BEARING
 $N00^{\circ}44'18''E$ 2650.51' (Rec)
 $N00^{\circ}21'34''E$ 2650.59' (Meas)

RECEIVED
 DEC 21 2021
 FILE # 7088

SCALE OF FEET
 0 60 120

LEGEND

- 6 | 5 = SECTION CORNER & SECTION LINE
- 7 | 8 = BOUNDARY LINE BAR & CAP STAMPED T/S 359548*
- = RIGHT OF HWY LINES
- = ADJOINING PARCELS DEED LINES
- = DIMENSION LINES
- = FOUND EVIDENCE AS NOTED
- = EXHIBIT WATER/MARSH
- = R.O.W. MONUMENT
- (Rec) = RECORDED DISTANCE
- (Meas) = MEASURED DISTANCE

DESIGNED	MGD
DRAFTED	MGD
CHECKED	DEH
SHEET	1
OF	1

Boundary Consultants
 Professional Land Surveyors
 5554 West 1425 North, Hooper, Utah
 801-792-1569

RECORD OF SURVEY OF
TAX PARCEL 15-402-0001
ARCHULETA, KEVIN & WF RHONDA
 LYING AND SITUATE IN THE SOUTH HALF NORTHWEST QUARTER OF SECTION 8,
 TOWNSHIP 6 NORTH, RANGE 2 WEST, SALT LAKE BASE AND MERIDIAN

DATE:	12-19-19
SCALE:	1"=60'
PROJECT NUMBER:	1931001

