

BOUNDARY DESCRIPTION

ALL OF LOT 30, RIVER VALLEY ESTATES SUBDIVISION NUMBER 7, RIVERDALE CITY, WEBER COUNTY, ACCORDING TO THE OFFICIAL PLAT THEREOF. CONTAINING 10,400 SQ.FT.

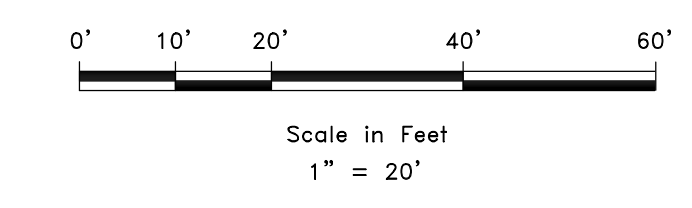
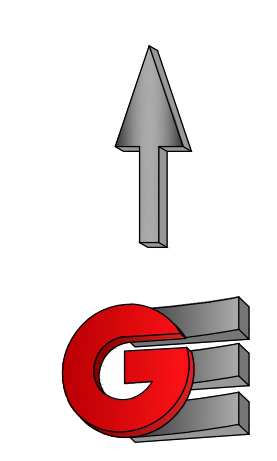

LEGEND

- ◆ WEBER COUNTY MONUMENT AS NOTED
- SET 24" REBAR AND CAP MARKED GARDNER ENGINEERING
- SUBJECT PROPERTY BOUNDARY
- LOT LINE
- - - ADJACENT PARCEL
- - - SECTION LINE
- - - EASEMENT
- - - EXISTING FENCE LINE

NARRATIVE

THE PURPOSE OF THIS SURVEY WAS TO ESTABLISH AND SET THE PROPERTY CORNERS OF THE PARCEL AS SHOWN AND DESCRIBED HEREON. THE SURVEY WAS ORDERED BY KAYLYNN BLAKESLEE. THE BASIS OF BEARING IS THE SOUTH LINE OF THE SOUTHWEST QUARTER OF SECTION 6, TOWNSHIP 5 NORTH, RANGE 1 WEST, OF THE SALT LAKE BASE AND MERIDIAN WHICH BEARS NORTH 88°38'19" WEST, WEBER COUNTY, UTAH NORTH, NAD 83 STATE PLANE GRID BEARING. THE BOUNDARY WAS DETERMINED BY WARRANTY DEED RECORDED AS ENTRY NUMBER 3079920, AND DEEDS OF ADJOINING PROPERTY OWNERS. THE DEDICATED PLAT OF RIVER VALLEY ESTATES SUBDIVISION NUMBER 7 WAS ALSO USED TO DETERMINE BOUNDARY LOCATION ALONG WITH THE FOUND MONUMENTS AND EXISTING FENCES WITHIN SAID SUBDIVISION AS SHOWN AND DESCRIBED HEREON.

SURVEYOR'S CERTIFICATE

I, KLINT H. WHITNEY, DO HEREBY CERTIFY THAT I AM A LICENSED PROFESSIONAL LAND SURVEYOR IN THE STATE OF UTAH AND THAT I HOLD CERTIFICATE NO. 8227228 IN ACCORDANCE WITH TITLE 58, CHAPTER 22, OF THE PROFESSIONAL ENGINEERS AND LAND SURVEYORS ACT; I FURTHER CERTIFY THAT BY AUTHORITY OF THE OWNERS I HAVE COMPLETED A SURVEY OF THE PROPERTY DESCRIBED ON THIS RECORD OF SURVEY PLAT IN ACCORDANCE WITH SECTION 17-23-20 AND HAVE VERIFIED ALL MEASUREMENTS; THAT THE REFERENCE MONUMENTS SHOWN ON THIS RECORD OF SURVEY PLAT ARE LOCATED AS INDICATED AND ARE SUFFICIENT TO RETRACE OR REESTABLISH THIS SURVEY; AND THAT THE INFORMATION SHOWN HEREIN IS SUFFICIENT TO ACCURATELY ESTABLISH THE LATERAL BOUNDARIES OF THE HEREIN DESCRIBED TRACT OF REAL PROPERTY.

SIGNED THIS 5TH DAY OF NOVEMBER, 2021.

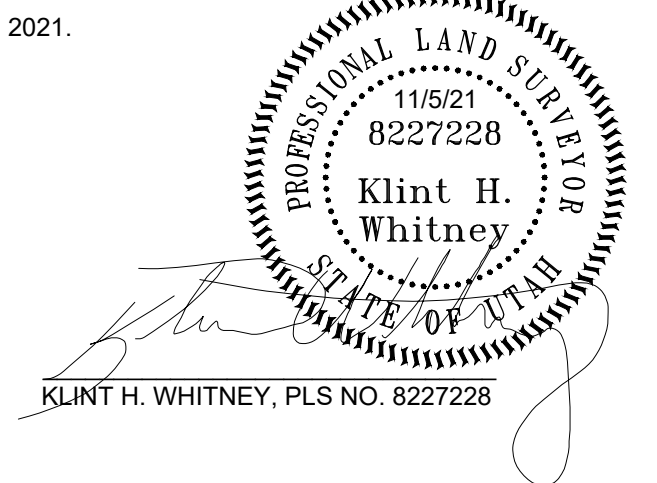

RECEIVED
DEC 28 2021
FILE # 7095

DATE	REVISIONS DESCRIPTION

SCALE: 1/20_XREF
DATE: 11/5/21
DESIGN: _____
DRAWN: KHW
CHECKED: KHW
DWG.: R2001 - MISC SURVEY 11/2 - KAYLYNN BLAKESLEE SURVEY FOR KAYLYNN BLAKESLEE.DWG

PROPERTY SURVEY FOR KAYLYNN BLAKESLEE
825 WEST 3800 SOUTH, RIVERDALE, UTAH
LOCATED IN THE SOUTHWEST QUARTER OF SECTION 6,
TOWNSHIP 5 NORTH, RANGE 1 WEST, S.L.B. AND M.

GARDNER ENGINEERING
CIVIL-LAND PLANNING
MUNICIPAL-LAND SURVEYING
5150 SOUTH 375 EAST OGDEN, UT
OFFICE: 801.476.0202 FAX: 801.476.0066

S1
1