

BOUNDARY DESCRIPTION

ALL OF LOT 25, CAUSEY ESTATES SUBDIVISION NUMBER 1, WEBER COUNTY, UTAH, ACCORDING TO THE OFFICIAL PLAT THEREOF. CONTAINING 161,004 SQUARE FEET.

SCALE:	1" = 50'
DATE:	11/30/21
DESIGN:	
DRAWN:	KHW
CHECKED:	KHW

REVISIONS	DESCRIPTION
DATE	

DWG.: R2001 - MISC SURVEY 1113 - PASEN ANDERSON CAUSEY SURVEY 2021.DWG

PROPERTY SURVEY FOR RICH JACKSON
 455 SOUTH PINE DRIVE #25, HUNTSVILLE, UTAH
 LOCATED IN SECTION 14,
 TOWNSHIP 6 NORTH, RANGE 3 EAST, S.L.B. AND M.

GARDNER ENGINEERING
 CIVIL - LAND PLANNING
 MUNICIPAL - LAND SURVEYING
 5150 SOUTH 375 EAST OGDEN, UT
 OFFICE: 801.476.0202 FAX: 801.476.0066

S1
 1

CAUSEY ESTATES LOT OWNERS ASSOC.
 230570001

LOT 25
 230600001
 CONTAINING 161,004 SQ.FT.

E H BROWN ENTERPRISES LLC
 230600002

J.D. GURULE
 230590016

RANDY JONES
 230590015

JD REDEVELOPMENT LLC
 230590014

PHILIPP WHITEHEAD
 230590013

TRACY HARPER
 230590001

CAUSEY ESTATES
 LOT OWNERS ASSOC.
 230570001

CAUSEY ESTATES LOT OWNERS ASSOC.
 230570001

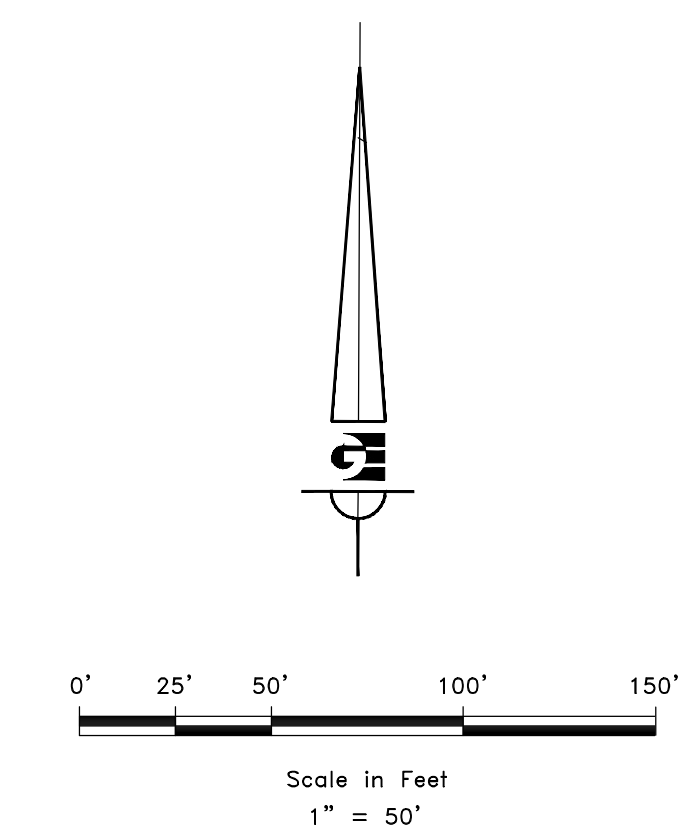

- LEGEND**
- ◆ WEBER COUNTY MONUMENT AS NOTED
 - SET 24" REBAR AND CAP MARKED GARDNER ENGINEERING
 - SUBJECT PROPERTY BOUNDARY
 - LOT LINE
 - - - ADJACENT PARCEL
 - - - SECTION LINE
 - - - EASEMENT
 - - - X EXISTING FENCE LINE

NARRATIVE

THE PURPOSE OF THIS SURVEY WAS TO ESTABLISH AND SET THE PROPERTY CORNERS OF THE PARCEL AS SHOWN AND DESCRIBED HEREON. THE SURVEY WAS ORDERED BY RICH JACKSON, THE BASIS OF BEARING IS THE SOUTHWESTERLY LINE OF THE LOT 25 BETWEEN THE FOUND REEVES REBAR, WHICH BEARS NORTH 57°30'42" EAST, WEBER COUNTY, UTAH NORTH, NAD 83 STATE PLANE GRID BEARING. THE BOUNDARY WAS DETERMINED BY WARRANTY DEED RECORDED AS ENTRY NUMBER 2743482, AND DEEDS OF ADJOINING PROPERTY OWNERS. RECORD OF SURVEY NUMBERS 6917, 6597, AND THE DEDICATED PLATS OF CAUSEY ESTATES SUBDIVISION NUMBER 1 WERE ALSO USED TO DETERMINE BOUNDARY LOCATION ALONG WITH THE FOUND MONUMENTS AS SHOWN AND DESCRIBED HEREON.

SURVEYOR'S CERTIFICATE

I, KLINT H. WHITNEY, DO HEREBY CERTIFY THAT I AM A LICENSED PROFESSIONAL LAND SURVEYOR IN THE STATE OF UTAH AND THAT I HOLD CERTIFICATE NO. 8227228 IN ACCORDANCE WITH TITLE 58, CHAPTER 22, OF THE PROFESSIONAL ENGINEERS AND LAND SURVEYORS ACT; I FURTHER CERTIFY THAT BY AUTHORITY OF THE OWNERS I HAVE COMPLETED A SURVEY OF THE PROPERTY DESCRIBED ON THIS RECORD OF SURVEY PLAT IN ACCORDANCE WITH SECTION 17-23-20 AND HAVE VERIFIED ALL MEASUREMENTS; THAT THE REFERENCE MONUMENTS SHOWN ON THIS RECORD OF SURVEY PLAT ARE LOCATED AS INDICATED AND ARE SUFFICIENT TO RETRACE OR REESTABLISH THIS SURVEY; AND THAT THE INFORMATION SHOWN HEREIN IS SUFFICIENT TO ACCURATELY ESTABLISH THE LATERAL BOUNDARIES OF THE HEREIN DESCRIBED TRACT OF REAL PROPERTY.

SIGNED THIS 30TH DAY OF NOVEMBER, 2021.

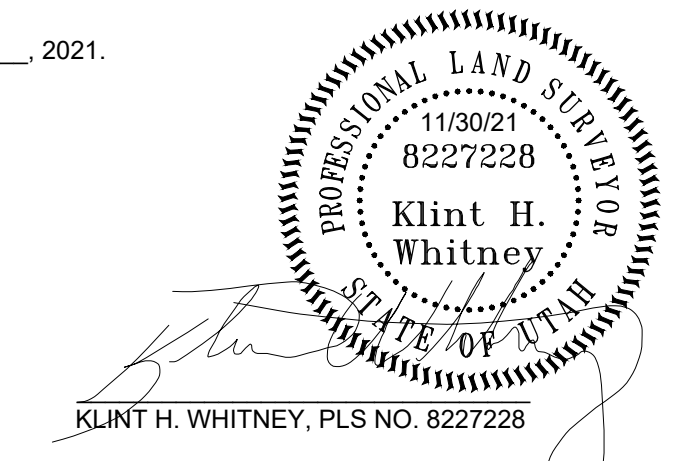

RECEIVED
 DEC 28 2021
 FILE # 7098

