

BOUNDARY DESCRIPTION

ALL OF LOT 304R, PARK PLAZA PHASE 3, FARR WEST CITY, WEBER COUNTY, UTAH ACCORDING TO THE OFFICIAL PLAT THEREOF.

GOLDEN LAND
MANAGEMENT INC
194220003

JEFFERY AND DEDDEH JOHNSON
LOT 304R
194220004
CONT. 10,350 SQ.FT.

CHRISTIAN MCCULLOUGH
194220005

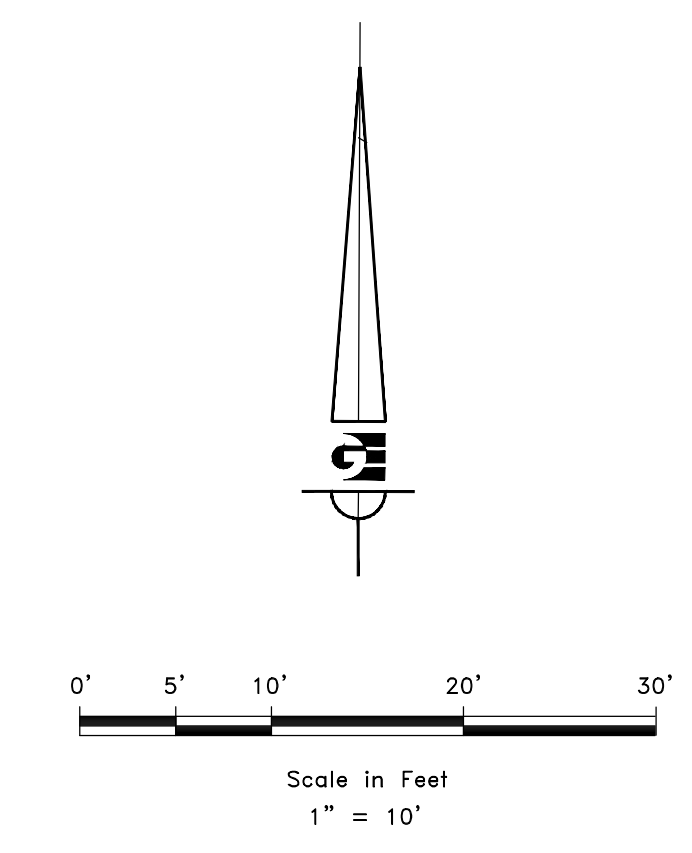

LEGEND

- ◆ CENTERLINE MONUMENT AS NOTED
- SET 24" REBAR AND CAP MARKED GARDNER ENGINEERING
- SUBJECT PROPERTY BOUNDARY
- LOT LINE
- - - ADJACENT PARCEL
- - - SECTION LINE
- - - EASEMENT
- - - X - - - EXISTING FENCE LINE

RECEIVED
JAN 21 2022
FILE # 7117

NARRATIVE

THE PURPOSE OF THIS SURVEY WAS TO ESTABLISH AND SET THE PROPERTY CORNERS OF THE PARCEL AS SHOWN AND DESCRIBED HEREON. THE SURVEY WAS ORDERED BY KIRK NELSON. THE BASIS OF BEARING IS THE NORTH LINE OF THE NORTHWEST QUARTER OF SECTION 23, WHICH BEARS NORTH 89°15'20" WEST, WEBER COUNTY, UTAH NORTH, NAD 83 STATE PLANE GRID BEARING. THE BOUNDARY WAS DETERMINED BY WARRANTY DEED RECORDED AS ENTRY NUMBER 3187500, AND DEEDS OF ADJOINING PROPERTY OWNERS. THE DEDICATED PLAT OF PARK PLAZA PHASE 3 WAS ALSO USED TO DETERMINE BOUNDARY LOCATION ALONG WITH THE FOUND MONUMENTS AS SHOWN AND DESCRIBED HEREON.

SURVEYOR'S CERTIFICATE

I, KLINT H. WHITNEY, DO HEREBY CERTIFY THAT I AM A LICENSED PROFESSIONAL LAND SURVEYOR IN THE STATE OF UTAH AND THAT I HOLD CERTIFICATE NO. 8227228 IN ACCORDANCE WITH TITLE 58, CHAPTER 22, OF THE PROFESSIONAL ENGINEERS AND LAND SURVEYORS ACT; I FURTHER CERTIFY THAT BY AUTHORITY OF THE OWNERS I HAVE COMPLETED A SURVEY OF THE PROPERTY DESCRIBED ON THIS RECORD OF SURVEY PLAT IN ACCORDANCE WITH SECTION 17-23-20 AND HAVE VERIFIED ALL MEASUREMENTS; THAT THE REFERENCE MONUMENTS SHOWN ON THIS RECORD OF SURVEY PLAT ARE LOCATED AS INDICATED AND ARE SUFFICIENT TO RETRACE OR REESTABLISH THIS SURVEY; AND THAT THE INFORMATION SHOWN HEREIN IS SUFFICIENT TO ACCURATELY ESTABLISH THE LATERAL BOUNDARIES OF THE HEREIN DESCRIBED TRACT OF REAL PROPERTY.

SIGNED THIS 20TH DAY OF JANUARY, 2022.

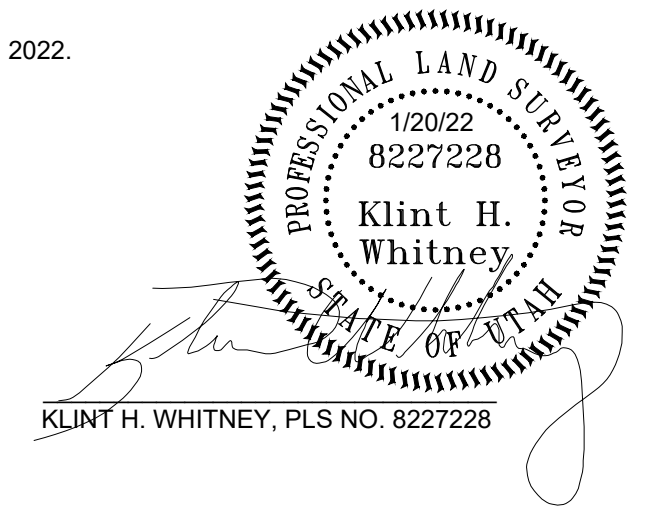

DATE	REVISIONS DESCRIPTION

SCALE: 1"=10' XREF
DATE: 1/20/22
DESIGN: KHW
DRAWN: KHW
CHECKED: KHW
DWG.: R:\2001-MISC SURVEY\2001-JEFF JOHNSON SURVEY\2001-PARK PLAZA.DWG

PROPERTY SURVEY FOR JEFF JOHNSON
3854 NORTH 2550 WEST, FARR WEST, UTAH
LOCATED IN THE NORTHWEST QUARTER OF SECTION 23,
TOWNSHIP 7 NORTH, RANGE 2 WEST, S.L.B. AND M.

GARDNER ENGINEERING
CIVIL-LAND PLANNING
MUNICIPAL-LAND SURVEYING
5150 SOUTH 375 EAST OGDEN, UT
OFFICE: 801.476.0202 FAX: 801.476.0066

S1
1