

BOUNDARY DESCRIPTION

ALL OF LOT 92, BRIER POINTE NO. 2, SOUTH OGDEN CITY, WEBER COUNTY, UTAH.

SOUTH OGDEN CITY
070810008

LOT 93
ANDREW & MARY KONRAD
JOINT FAMILY TRUST
076340008

LOT 92
SAMUEL & STACY
MCCANDLESS
076340007

LOT 91
AL-SADAT,
AHMAD N & RASHA SULTAN
076350012

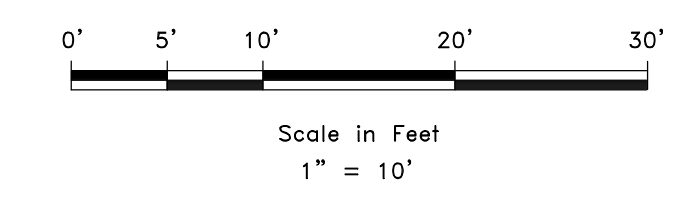
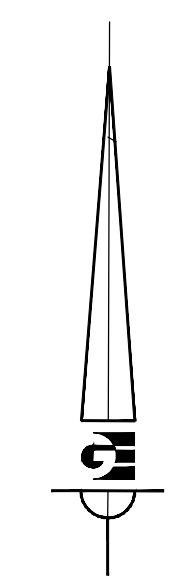

LEGEND

- WEBER COUNTY MONUMENT AS NOTED
- SET 24" REBAR AND CAP MARKED GARDNER ENGINEERING
- SUBJECT PROPERTY BOUNDARY
- LOT LINE
- ADJACENT PARCEL
- SECTION LINE
- EASEMENT
- EXISTING FENCE LINE

RECEIVED
MAR 03 2022
FILE # 7145

NARRATIVE

THE PURPOSE OF THIS SURVEY WAS TO ESTABLISH AND SET THE PROPERTY CORNERS OF THE PARCEL AS SHOWN AND DESCRIBED HEREON. THE SURVEY WAS ORDERED BY SAMUEL MCCANDLESS. THE BASIS OF BEARING IS THE LINE BETWEEN THE STREET CENTERLINE MONUMENT AT THE INTERSECTION OF 6000 SOUTH AND 1150 EAST AND THE STREET CENTER LINE MONUMENT AT THE INTERSECTION OF 6000 SOUTH AND 1200 EAST, WHICH BEARS SOUTH 48°03'00" WEST, WEBER COUNTY, UTAH NORTH, NAD 83 STATE PLANE GRID BEARING. THE BOUNDARY WAS DETERMINED BY WARRANTY DEED RECORDED AS ENTRY NUMBER 3206048, AND DEEDS OF ADJOINING PROPERTY OWNERS. THE DEDICATED PLAT OF BRIER POINTE NO. 2 WAS ALSO USED TO DETERMINE BOUNDARY LOCATION ALONG WITH THE FOUND MONUMENTS AS SHOWN AND DESCRIBED HEREON.

SURVEYOR'S CERTIFICATE

I, KLINT H. WHITNEY, DO HEREBY CERTIFY THAT I AM A LICENSED PROFESSIONAL LAND SURVEYOR IN THE STATE OF UTAH AND THAT I HOLD CERTIFICATE NO. 8227228 IN ACCORDANCE WITH TITLE 58, CHAPTER 22, OF THE PROFESSIONAL ENGINEERS AND LAND SURVEYORS ACT; I FURTHER CERTIFY THAT BY AUTHORITY OF THE OWNERS I HAVE COMPLETED A SURVEY OF THE PROPERTY DESCRIBED ON THIS RECORD OF SURVEY PLAT IN ACCORDANCE WITH SECTION 17-23-20 AND HAVE VERIFIED ALL MEASUREMENTS; THAT THE REFERENCE MONUMENTS SHOWN ON THIS RECORD OF SURVEY PLAT ARE LOCATED AS INDICATED AND ARE SUFFICIENT TO RETRACE OR REESTABLISH THIS SURVEY; AND THAT THE INFORMATION SHOWN HEREIN IS SUFFICIENT TO ACCURATELY ESTABLISH THE LATERAL BOUNDARIES OF THE HEREIN DESCRIBED TRACT OF REAL PROPERTY.

SIGNED THIS 18 DAY OF FEBRUARY, 2022.

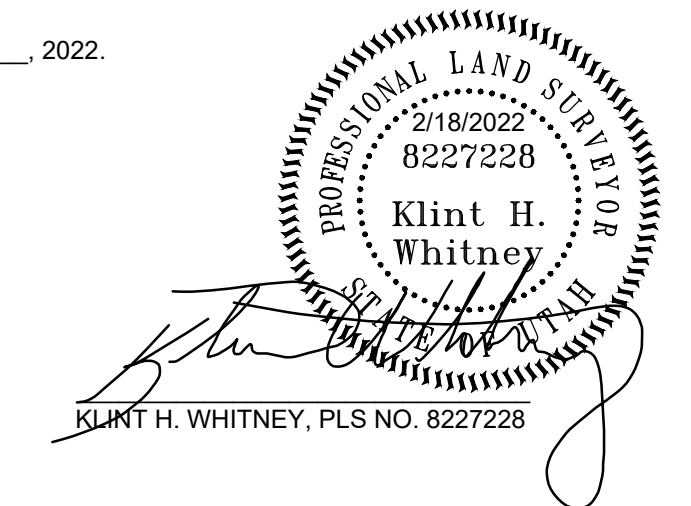

REVISIONS	DESCRIPTION

SCALE:	1:10, XREF
DATE:	2/18/22
DESIGN:	
DRAWN:	KHW
CHECKED:	KHW

PROPERTY SURVEY FOR SAMUEL MCCANDLESS
1154 EAST 6000 SOUTH, SOUTH OGDEN, UTAH
LOCATED IN THE SOUTHWEST QUARTER OF SECTION 22,
TOWNSHIP 5 NORTH, RANGE 1 WEST, S.L.B. AND M.

GARDNER ENGINEERING
CIVIL-LAND PLANNING
MUNICIPAL-LAND SURVEYING
5150 SOUTH 375 EAST OGDEN, UT
OFFICE: 801.476.0202 FAX: 801.476.0066

S1
1