

- LEGEND**
- ▲ Set Nail & Washer
 - Set 5/8 x 24" Rebar & GBE Cap
 - ◆ Section Corner
 - ◆ Calculated Section Position
 - ◆ Reference Monument
 - (Rec) Record
 - (WCS) Weber County Surveyor
 - Centerline Road
 - Existing Parcel Line
 - Survey Monument Line
 - Easement Line
 - Lot Line
 - Boundary Line
 - Existing Fence Line

NARRATIVE

This Survey was requested by Jeffrey Morse for the purpose of retracing the boundaries of Lot 58 of Shadow Valley Estates No. 8.

Basis of Bearing for this survey is S 89°10'53" E Measured from the Northeast corner and the Northwest corner of said section.

The re-tracement of the Northwest Corner of the Southwest Quarter of the Northeast Quarter of Section 15 was applied as shown on this plat. The position being calculated from found monuments and holding record bearings as published by Weber County. It was found that in holding the record bearings and distances from the calculated position representing the Northwest Corner of the Southwest Quarter of the Northeast Quarter of Section 15 that the measured occupation was missed by 11 feet. A Plug set in the curb at the extension of the property line was found near the Southeast corner of the property and was held as controlling over the calculated Quarter Quarter Corner. Record Bearing and distances were held from said position.

Corners were set as shown on this plat.

DESCRIPTION
All of Lot 58, Shadow Valley Estates No. 8, Ogden City, Weber County, Utah.

Surveyor's Certificate

I, Andy Hubbard do hereby certify that I am a Professional Land Surveyor, and that I hold Certificate no. 6242920, in accordance with Title 58, Chapter 22, of the Professional Engineers and Professional Land Surveyors Licensing Act, and I have made a survey of the above described property according to Section 17-23-17 and that the above plat correctly shows the true dimensions of the property surveyed.

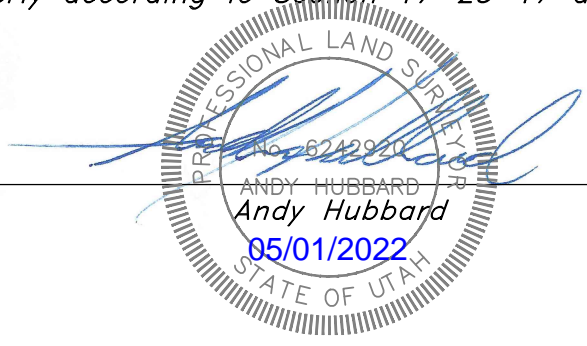

RECEIVED
JUN 03 2022
FILE # 7261

	RECORD OF SURVEY SHADOW VALLEY ESTATES ROS 1837 Navajo Drive Ogden City, Weber County, Utah A part of Section 15, T5N, R1W, SLB&M, U.S. Survey
June, 2021	1
SHEET NO.	21N727 ROS