

BRANDON M LLOYD
154200056

BOB EISENMANN TRUST
151050010

JEFFREY TRIMBLE
151050003

MARIA MOORE
150610038
2378 W 1800 S
CONTAINS: 44,162 SF
1.01 ACRES

JOHN & JANET HARRISON
150610063

CANDACE R WENTLAND
151050011

BOUNDARY DESCRIPTION

A PART OF THE SOUTHWEST QUARTER OF SECTION 23, TOWNSHIP 7 NORTH, RANGE 2 WEST, OF THE SALT LAKE BASE AND MERIDIAN, BEGINNING AT A POINT ON THE SOUTH LINE OF SAID QUARTER SECTION BEING LOCATED NORTH 89°16'49" WEST 408.00 FEET FROM THE SOUTH QUARTER CORNER OF SAID SECTION, RUNNING THENCE ALONG SAID SOUTH LINE NORTH 89°16'49" WEST 120.00 FEET; THENCE NORTH 0°04'49" WEST 367.74 FEET TO SOUTH LOT LINE OF LOT 4, HILL ACRES SUBDIVISION; THENCE ALONG THE SOUTH LOT LINE OF LOT 4, HILL ACRES SUBDIVISION SOUTH 89°33'49" EAST 120.00 FEET TO THE WEST BOUNDARY LINE OF HILL ACRES SUBDIVISION; THENCE ALONG SAID WEST BOUNDARY LINE SOUTH 0°04'43" EAST 368.33 FEET TO THE POINT OF BEGINNING, CONTAINING 44,162 SQUARE FEET OR 1.01 ACRES MORE OR LESS.

SCALE: 1" = 20'	DATE: 7/28/20	DESIGN: _____	DRAWN: KHW	CHECKED: KHW
REVISIONS	DATE	DESCRIPTION		
DWG.: PL001 - MISC SURVEY078 - MARIA MOORE SURVEY FOR MARIA MOORE.DWG				

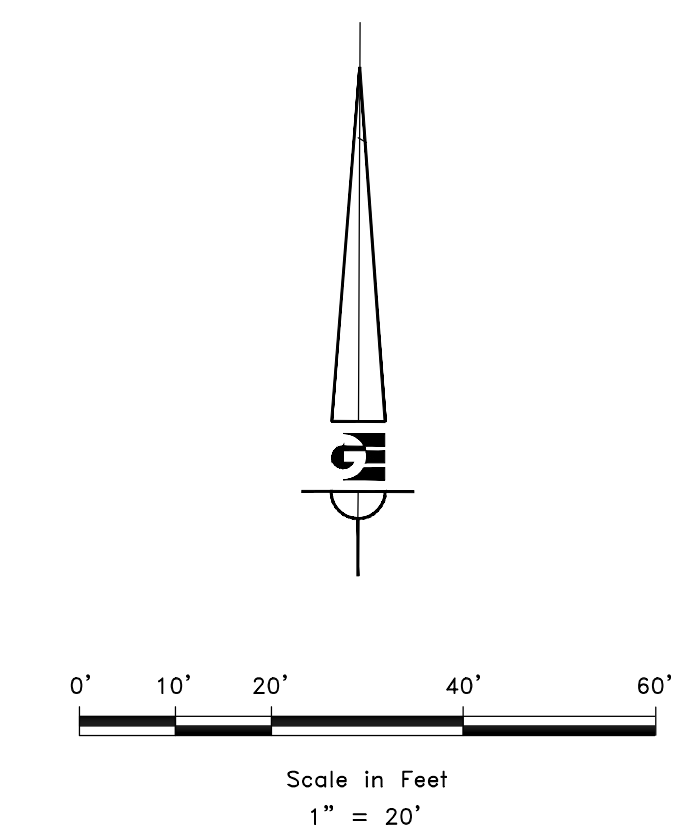

LEGEND

- ◆ WEBER COUNTY MONUMENT AS NOTED
- SET 24" REBAR AND CAP MARKED GARDNER ENGINEERING
- SUBJECT PROPERTY BOUNDARY
- - - ADJACENT PARCEL
- SECTION LINE
- - - EASEMENT
- - - EXISTING FENCE LINE

RECEIVED
JUL 21 2022
FILE # 7303

NARRATIVE

THE PURPOSE OF THIS SURVEY WAS TO ESTABLISH AND SET THE PROPERTY CORNERS OF THE PARCEL AS SHOWN AND DESCRIBED HEREON. THE SURVEY WAS ORDERED BY MARIA MOORE. THE BASIS OF BEARING IS THE SOUTH LINE OF THE SOUTHWEST QUARTER OF SECTION 23, WHICH BEARS NORTH 89°16'49" EAST, WEBER COUNTY, UTAH NORTH, NAD 83 STATE PLANE GRID BEARING. THE BOUNDARY WAS DETERMINED BY WARRANTY DEED RECORDED AS ENTRY NUMBER 2969053, AND DEEDS OF ADJOINING PROPERTY OWNERS ALONG WITH THE DEDICATED PLATS OF HILL ACRES SUBDIVISION AND HOLMES ESTATES SUBDIVISION PHASE 2 WERE ALSO USED TO DETERMINE BOUNDARY LOCATION ALONG WITH THE FOUND MONUMENTS AS SHOWN AND DESCRIBED HEREON.

SURVEYOR'S CERTIFICATE

I, KLINT H. WHITNEY, DO HEREBY CERTIFY THAT I AM A LICENSED PROFESSIONAL LAND SURVEYOR IN THE STATE OF UTAH AND THAT I HOLD CERTIFICATE NO. 8227228 IN ACCORDANCE WITH TITLE 58, CHAPTER 22, OF THE PROFESSIONAL ENGINEERS AND LAND SURVEYORS ACT; I FURTHER CERTIFY THAT BY AUTHORITY OF THE OWNERS I HAVE COMPLETED A SURVEY OF THE PROPERTY DESCRIBED ON THIS RECORD OF SURVEY PLAT IN ACCORDANCE WITH SECTION 17-23-20 AND HAVE VERIFIED ALL MEASUREMENTS; THAT THE REFERENCE MONUMENTS SHOWN ON THIS RECORD OF SURVEY PLAT ARE LOCATED AS INDICATED AND ARE SUFFICIENT TO RETRACE OR REESTABLISH THIS SURVEY; AND THAT THE INFORMATION SHOWN HEREIN IS SUFFICIENT TO ACCURATELY ESTABLISH THE LATERAL BOUNDARIES OF THE HEREIN DESCRIBED TRACT OF REAL PROPERTY.

SIGNED THIS 2ND DAY OF JULY, 2022.

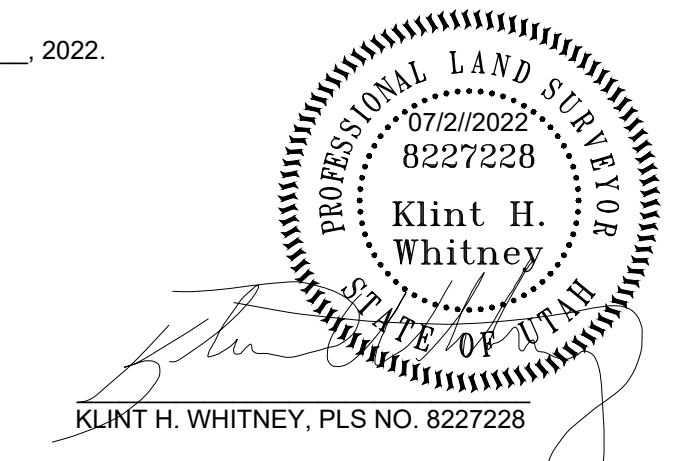

GARDNER ENGINEERING
CIVIL-LAND PLANNING
MUNICIPAL-LAND SURVEYING

5150 SOUTH 375 EAST OGDEN, UT
OFFICE: 801.476.0202 FAX: 801.476.0066

PROPERTY SURVEY FOR MARIA MOORE
2378 WEST 1800 SOUTH, WEST HAVEN UTAH
LOCATED IN THE SOUTHWEST QUARTER OF SECTION 23,
TOWNSHIP 7 NORTH, RANGE 2 WEST, S.L.B. AND M.

S1
1

SOUTHWEST CORNER
SEC. 23 T6N, R2W, SLB&M
FOUND WEBER COUNTY 3"
BRASS CAP MONUMENT 2.0'
BELOW ROAD SURFACE,
FAIR CONDITION DATED 1960.

SOUTH QUARTER CORNER
SEC. 23 T6N, R2W, SLB&M
FOUND WEBER COUNTY 3"
BRASS CAP MONUMENT 0.65"
BELOW GROUND, FAIR CONDITION
DATED 2004.

SET NAIL IN CONCRETE

