

**ORIGINAL BOUNDARY DESCRIPTION PARCEL 150800043**  
 PART OF THE NORTHEAST QUARTER OF SECTION 29, TOWNSHIP 6 NORTH, RANGE 2 WEST, SALT LAKE BASE AND MERIDIAN, U.S. SURVEY, BEGINNING AT A POINT 264 FEET NORTH OF THE SOUTHEAST CORNER FROM SOUTHEAST CORNER OF SAID NORTHEAST QUARTER SECTION 29; THENCE WEST 261.5 FEET; THENCE NORTH 148 FEET; THENCE EAST 261.5 FEET; THENCE SOUTH 148 FEET TO THE POINT OF BEGINNING.

**ORIGINAL BOUNDARY DESCRIPTION PARCEL 150800041**  
 PART OF THE NORTHEAST QUARTER OF SECTION 29, TOWNSHIP 6 NORTH, RANGE 2 WEST, SALT LAKE BASE AND MERIDIAN, U.S. SURVEY, BEGINNING AT A POINT 264 FEET NORTH OF THE SOUTHEAST CORNER FROM SOUTHEAST CORNER OF SAID NORTHEAST QUARTER SECTION 29; THENCE WEST 261.5 FEET; THENCE NORTH 148 FEET; THENCE EAST 261.5 FEET; THENCE SOUTH 148 FEET TO THE POINT OF BEGINNING.

**ORIGINAL BOUNDARY DESCRIPTION PARCEL 150800005**  
 PART OF THE NORTHEAST QUARTER OF SECTION 29, TOWNSHIP 6 NORTH, RANGE 2 WEST, SALT LAKE BASE AND MERIDIAN, U.S. SURVEY, BEGINNING 330 FEET WEST FROM THE SOUTHEAST CORNER OF NORTHEAST QUARTER OF SECTION 29, RUNNING THENCE WEST 1.5 FEET, THENCE NORTH 264 FEET, THENCE EAST 1.5 FEET, THENCE SOUTH 264 FEET TO BEGINNING, EXCEPT ROAD.

**ORIGINAL BOUNDARY DESCRIPTION PARCEL 150800044**  
 COMMENCING AT A POINT 331.5 FEET WEST FROM THE SOUTHEAST CORNER OF THE NORTHEAST QUARTER OF SECTION 29, TOWNSHIP 6 NORTH, RANGE 2 WEST, SALT LAKE MERIDIAN, AND RUNNING THENCE WEST 345 FEET; THENCE NORTH 412 FEET; THENCE EAST 415 FEET; THENCE SOUTH 148 FEET; THENCE WEST 70 FEET; THENCE SOUTH 264 FEET TO PLACE OF BEGINNING, EXCEPTING THEREFROM THE FOLLOWING PARCEL: COMMENCING A POINT 570.8 FEET WEST AND 16.5 FEET NORTH OF THE SOUTHEAST CORNER OF THE NORTHEAST QUARTER OF SECTION 29, TOWNSHIP 6 NORTH, RANGE 2 WEST, SALT LAKE MERIDIAN, RUNNING THENCE WEST 110.14 FEET; THENCE NORTH 395.5 FEET; THENCE EAST 110.14 FEET; THENCE SOUTH 395.5 FEET TO POINT OF BEGINNING.

**ORIGINAL BOUNDARY DESCRIPTION PARCEL 150800042**  
 BEGINNING AT A POINT 565 FEET WEST AND 25 FEET NORTH OF THE SOUTHEAST CORNER OF THE NORTHEAST QUARTER OF SECTION 29, TOWNSHIP 6 NORTH, RANGE 2 WEST, U.S. SURVEY; AND RUNNING THENCE WEST 5.8 FEET; THENCE NORTH 387 FEET; THENCE EAST 5.8 FEET; THENCE SOUTH 387 FEET TO THE POINT OF BEGINNING.

**ORIGINAL BOUNDARY DESCRIPTION PARCEL 150800006**  
 COMMENCING AT A POINT 570.8 FEET WEST AND 16.5 FEET NORTH OF THE SOUTHEAST CORNER OF THE NORTHEAST QUARTER OF SECTION 29, TOWNSHIP 6 NORTH, RANGE 2 WEST, SALT LAKE MERIDIAN; RUNNING THENCE WEST 110.14 FEET; THENCE NORTH 395.5 FEET; THENCE EAST 110.14 FEET; THENCE SOUTH 395.5 FEET TO POINT OF BEGINNING.

**ADJUSTED BOUNDARY DESCRIPTION PARCEL "A"**  
 A PART OF THE NORTHEAST QUARTER OF SECTION 29, TOWNSHIP 6 NORTH, RANGE 2 WEST, OF THE SALT LAKE BASE AND MERIDIAN MORE PARTICULARLY DESCRIBED AS FOLLOWS: BEGINNING AT A POINT ON THE NORTH RIGHT-OF-WAY LINE OF 2200 SOUTH STREET BEING LOCATED NORTH 89°11'54" WEST 680.94 FEET ALONG THE SOUTH LINE OF SAID NORTHEAST QUARTER AND NORTH 00°48'06" EAST 33.00 FEET FROM THE EAST QUARTER CORNER OF SAID SECTION 29; RUNNING THENCE NORTH 00°48'06" EAST 33.00 FEET; THENCE SOUTH 89°11'54" EAST 287.73 FEET; THENCE SOUTH 00°48'24" WEST 206.00 FEET; THENCE NORTH 89°11'54" WEST 137.84 FEET; THENCE SOUTH 00°48'06" WEST 173.00 FEET TO SAID NORTH RIGHT-OF-WAY LINE; THENCE ALONG SAID NORTH RIGHT-OF-WAY LINE NORTH 89°11'54" WEST 150.00 FEET TO THE POINT OF BEGINNING. CONTAINING 1.957 ACRES.

**ADJUSTED BOUNDARY DESCRIPTION PARCEL "B"**  
 A PART OF THE NORTHEAST QUARTER OF SECTION 29, TOWNSHIP 6 NORTH, RANGE 2 WEST, OF THE SALT LAKE BASE AND MERIDIAN MORE PARTICULARLY DESCRIBED AS FOLLOWS: BEGINNING AT A POINT ON THE NORTH RIGHT-OF-WAY LINE OF 2200 SOUTH STREET BEING LOCATED NORTH 89°11'54" WEST 680.94 FEET ALONG THE SOUTH LINE OF SAID NORTHEAST QUARTER AND NORTH 00°48'06" EAST 33.00 FEET FROM THE EAST QUARTER CORNER OF SAID SECTION 29; RUNNING THENCE NORTH 00°48'06" EAST 173.00 FEET; THENCE SOUTH 89°11'54" EAST 137.84 FEET; THENCE NORTH 00°46'24" EAST 206.00 FEET; THENCE SOUTH 89°11'54" EAST 360.35 FEET TO THE WEST RIGHT-OF-WAY LINE OF 4300 WEST STREET; THENCE ALONG SAID WEST RIGHT-OF-WAY LINE SOUTH 00°49'19" WEST 379.00 FEET TO SAID NORTH RIGHT-OF-WAY LINE; THENCE ALONG SAID NORTH RIGHT-OF-WAY LINE NORTH 89°11'54" WEST 497.95 FEET TO THE POINT OF BEGINNING. CONTAINING 3.667 ACRES.

**QUIT CLAIM PARCEL "C" DESCRIPTION**  
 A PART OF THE NORTHEAST QUARTER OF SECTION 29, TOWNSHIP 6 NORTH, RANGE 2 WEST, OF THE SALT LAKE BASE AND MERIDIAN MORE PARTICULARLY DESCRIBED AS FOLLOWS: BEGINNING AT A POINT ON THE SOUTH LINE OF SAID NORTHEAST QUARTER BEING LOCATED NORTH 89°11'54" WEST 330.00 FEET ALONG SAID SOUTH LINE FROM THE EAST QUARTER CORNER OF SAID SECTION 29; RUNNING THENCE NORTH 89°11'54" WEST 350.94 FEET; THENCE NORTH 00°48'06" EAST 33.00 FEET; THENCE SOUTH 89°11'54" EAST 350.95 FEET; THENCE SOUTH 00°49'19" WEST 33.00 FEET TO THE POINT OF BEGINNING. CONTAINING 11,581 SQ. FT.

**QUIT CLAIM PARCEL "D" DESCRIPTION**  
 A PART OF THE NORTHEAST QUARTER OF SECTION 29, TOWNSHIP 6 NORTH, RANGE 2 WEST, OF THE SALT LAKE BASE AND MERIDIAN MORE PARTICULARLY DESCRIBED AS FOLLOWS: BEGINNING AT A POINT ON THE EAST LINE OF SAID NORTHEAST QUARTER BEING LOCATED NORTH 00°49'19" EAST 264.00 FEET ALONG SAID EAST LINE FROM THE EAST QUARTER CORNER OF SAID SECTION 29; RUNNING THENCE NORTH 89°11'54" WEST 33.00 FEET; THENCE NORTH 00°49'19" EAST 148.00 FEET; THENCE SOUTH 89°11'54" EAST 33.00 FEET TO SAID EAST LINE; THENCE ALONG SAID EAST LINE SOUTH 00°49'19" WEST 148.00 FEET TO THE POINT OF BEGINNING. CONTAINING 4,877 SQUARE FEET.

**LEGEND**

- ◆ WEBER COUNTY MONUMENT AS NOTED
- SET 24" REBAR AND CAP MARKED GARDNER ENGINEERING
- SUBJECT PROPERTY BOUNDARY
- ORIGINAL PARCEL BOUNDARY
- - - ADJACENT PARCEL
- SECTION LINE
- - - EASEMENT
- × EXISTING FENCE LINE

**NARRATIVE**

THE PURPOSE OF THIS SURVEY WAS TO CONDUCT A TOPOGRAPHIC SURVEY, ESTABLISH AND SET THE PROPERTY CORNERS OF THE PARCEL AS SHOWN AND DESCRIBED HEREON. THE SURVEY WAS ORDERED BY WEBER SCHOOL DISTRICT. THE BASIS OF BEARING IS THE EAST LINE OF THE NORTHEAST QUARTER OF SECTION 29, TOWNSHIP 6 NORTH, RANGE 2 WEST, OF THE SALT LAKE BASE AND MERIDIAN WHICH BEARS NORTH 00°49'19" EAST, WEBER COUNTY, UTAH NORTH, NAD 83 STATE PLANE GRID BEARING. THE BOUNDARY WAS DETERMINED BY WARRANTY DEED(S) RECORDED AS ENTRY NUMBER(S) 254667, 1178272 AND DEEDS OF ADJOINING PROPERTY OWNERS. THE DEDICATED PLATS OF RACKLIFF SUBDIVISION, HADLEY HOMESTEAD, AND SUNSET EQUESTRIAN CLUSTER SUBDIVISION WERE ALSO USED TO DETERMINE BOUNDARY LOCATION ALONG WITH THE FOUND MONUMENTS AS SHOWN AND DESCRIBED HEREON.

RECEIVED  
 AUG 19 2022  
 FILE # 7334

**SURVEYOR'S CERTIFICATE**

I, KLINT H. WHITNEY, DO HEREBY CERTIFY THAT I AM A LICENSED PROFESSIONAL LAND SURVEYOR IN THE STATE OF UTAH AND THAT I HOLD CERTIFICATE NO. 8227228 IN ACCORDANCE WITH TITLE 58, CHAPTER 22, OF THE PROFESSIONAL ENGINEERS AND LAND SURVEYORS ACT; I FURTHER CERTIFY THAT BY AUTHORITY OF THE OWNERS I HAVE COMPLETED A SURVEY OF THE PROPERTY DESCRIBED ON THIS RECORD OF SURVEY PLAT IN ACCORDANCE WITH SECTION 17-23-20 AND HAVE VERIFIED ALL MEASUREMENTS; THAT THE REFERENCE MONUMENTS SHOWN ON THIS RECORD OF SURVEY PLAT ARE LOCATED AS INDICATED AND ARE SUFFICIENT TO RETRACE OR REESTABLISH THIS SURVEY; AND THAT THE INFORMATION SHOWN HEREIN IS SUFFICIENT TO ACCURATELY ESTABLISH THE LATERAL BOUNDARIES OF THE HEREIN DESCRIBED TRACT OF REAL PROPERTY.

SIGNED THIS 16TH DAY OF AUGUST, 2022.

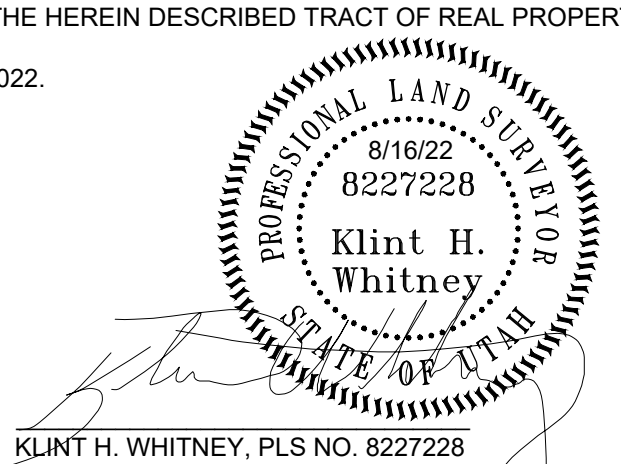

SCALE:	1:40, XREF
DATE:	2/28/20
DESIGN:	
DRAWN:	KHW
CHECKED:	KHW

REVISIONS	DESCRIPTION
DATE	

**BOUNDARY ADJUSTMENT SURVEY**  
 +/-2200 S. 4300 W., WEBER COUNTY  
 LOCATED IN THE NORTHEAST QUARTER OF SECTION 29,  
 TOWNSHIP 6 NORTH, RANGE 2 WEST, S.L.B. AND M.

**GARDNER ENGINEERING**  
 CIVIL-LAND PLANNING  
 MUNICIPAL-LAND SURVEYING  
 5150 SOUTH 375 EAST OGDEN, UT  
 OFFICE: 801-476-0202 FAX: 801-476-0066

**S1**  
**1**