

**BOUNDARY DESCRIPTION 010120063**

PART OF LOT 6, BLOCK 14, PLAT A, OGDEN CITY SURVEY, WEBER COUNTY, UTAH MORE PARTICULARLY DESCRIBED AS FOLLOWS: BEGINNING AT A POINT WHICH LIES SOUTH 00D58'00" WEST 132.00 FEET FROM THE NORTHWEST CORNER OF LOT 6, BLOCK 14, PLAT A, OGDEN CITY SURVEY, SAID POINT ALSO BEING NORTH 00D58'00" EAST 200.54 FEET FROM THE SOUTHWEST CORNER OF SAID LOT 6 AND RUNNING THENCE SOUTH 89D02'00" EAST 132.00 FEET MORE OR LESS TO THE EAST LINE OF SAID LOT 6, THENCE SOUTH 00D58'00" WEST ALONG SAID EAST LINE 43.00 FEET; THENCE NORTH 89D02'00" WEST 18.00 FEET; THENCE SOUTH 00D58'00" WEST 22.45 FEET THENCE NORTH 89D02'00" WEST 114.00 FEET; THENCE NORTH 00D58'00" EAST 65.45 FEET TO THE POINT OF BEGINNING. CONTAINS 8.235 SQ FEET OR 0.189 ACRES. SUBJECT TO RIGHT OF WAY DESCRIBED AS FOLLOWS: BEGINNING AT A POINT WHICH LIES SOUTH 00D58'00" WEST 151.23 FEET FROM THE NORTHWEST CORNER OF LOT 6, BLOCK 14, PLAT A, OGDEN CITY SURVEY, AND RUNNING THENCE SOUTH 89D02'00" EAST 114.00 FEET; THENCE SOUTH 00D58'00" WEST 46.22 FEET; THENCE NORTH 89D02'00" WEST 28.42 FEET; THENCE NORTH 00D58'00" EAST 22.22 FEET; THENCE NORTH 89D02'00" WEST 85.85 FEET; THENCE NORTH 00D58'00" EAST 24.00 FEET TO THE POINT OF BEGINNING. (# 2612086)

**BOUNDARY DESCRIPTION 010120060**

PART OF LOT 6, BLOCK 14, PLAT A, OGDEN CITY SURVEY, WEBER COUNTY, UTAH; BEGINNING AT THE NORTHWEST CORNER OF SAID LOT 6, AND RUNNING THENCE (EAST) SOUTH 89D02'21" EAST 97.86 FEET; THENCE SOUTH 01D08'35" WEST 132.00 FEET; THENCE (WEST) NORTH 89D02'00" WEST 97.45 FEET; THENCE (NORTH) NORTH 0D58'00" EAST 131.99 FEET TO THE POINT OF BEGINNING. CONTAINING 12890 SQUARE FEET.

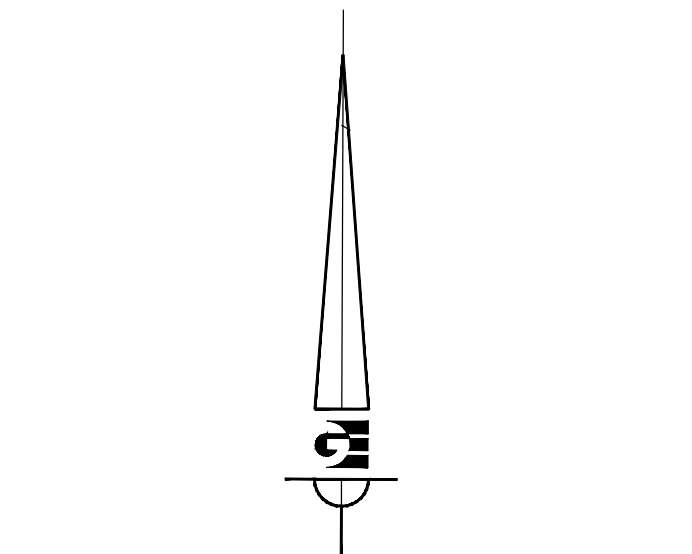

Scale in Feet  
1" = 20'

- LEGEND**
- ◆ OGDEN CITY SURVEY MONUMENT AS NOTED
  - SET 2" REBAR AND CAP MARKED GARDNER ENGINEERING
  - SUBJECT PROPERTY BOUNDARY
  - LOT LINE
  - - - ADJACENT PARCEL
  - - - SECTION LINE
  - - - EASEMENT
  - x EXISTING FENCE LINE

**NARRATIVE**

THE PURPOSE OF THIS SURVEY WAS TO ESTABLISH AND SET THE PROPERTY CORNERS OF THE PARCEL AS SHOWN AND DESCRIBED HEREON. THE SURVEY WAS ORDERED BY REBECCA SATO. THE BASIS OF BEARING IS THE MONUMENTED STREET CENTERLINE OF JEFFERSON AVENUE BETWEEN 26TH STREET AND 27TH STREET, WHICH BEARS NORTH 1°18'33" EAST, WEBER COUNTY, UTAH NORTH, NAD 83 STATE PLANE GRID BEARING. THE BOUNDARY WAS DETERMINED BY WARRANTY DEED RECORDED AS ENTRY NUMBER 2968737, AND DEEDS OF ADJOINING PROPERTY OWNERS. RECORD OF SURVEY NUMBERS 3789, 5544 WERE ALSO USED TO DETERMINE THE BOUNDARY ALONG WITH THE FOUND MONUMENTS AS SHOWN AND DESCRIBED HEREON.

**SURVEYOR'S CERTIFICATE**

I, KLINT H. WHITNEY, DO HEREBY CERTIFY THAT I AM A LICENSED PROFESSIONAL LAND SURVEYOR IN THE STATE OF UTAH AND THAT I HOLD CERTIFICATE NO. 8227228 IN ACCORDANCE WITH TITLE 58, CHAPTER 22, OF THE PROFESSIONAL ENGINEERS AND LAND SURVEYORS ACT; I FURTHER CERTIFY THAT BY AUTHORITY OF THE OWNERS I HAVE COMPLETED A SURVEY OF THE PROPERTY DESCRIBED ON THIS RECORD OF SURVEY PLAT IN ACCORDANCE WITH SECTION 17-23-20 AND HAVE VERIFIED ALL MEASUREMENTS; THAT THE REFERENCE MONUMENTS SHOWN ON THIS RECORD OF SURVEY PLAT ARE LOCATED AS INDICATED AND ARE SUFFICIENT TO RETRACE OR REESTABLISH THIS SURVEY; AND THAT THE INFORMATION SHOWN HEREIN IS SUFFICIENT TO ACCURATELY ESTABLISH THE LATERAL BOUNDARIES OF THE HEREIN DESCRIBED TRACT OF REAL PROPERTY.

SIGNED THIS 26TH DAY OF AUGUST, 2022.

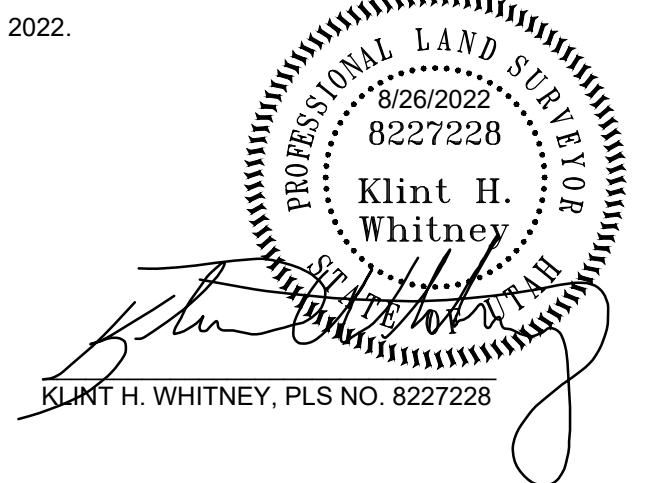

RECEIVED  
AUG 29 2022  
FILE # 7339

SCALE:	1:20_XREF
DATE:	7/1/20
DESIGN:	
DRAWN:	KHW
CHECKED:	KHW

REVISIONS	DESCRIPTION
DATE	

PROPERTY SURVEY FOR REBECCA SATO  
OGDEN UTAH  
LOCATED IN THE NORTHEAST QUARTER OF SECTION 33,  
TOWNSHIP 6 NORTH, RANGE 1 WEST, S.L.B. AND M.

**GARDNER ENGINEERING**  
CIVIL-LAND PLANNING  
MUNICIPAL-LAND SURVEYING  
5150 SOUTH 375 EAST OGDEN, UT  
OFFICE: 801.476.0202 FAX: 801.476.0066

S1  
1