

WEST QUARTER CORNER
SECTION 19 T6N R1W S.L.B.&M.

N90°00'00"E
2173.68'

COREY D COMBE REV. TRUST
121020031

COREY D COMBE REV. TRUST
121020003

SOUTHERN PACIFIC COMPANY
121020029

COREY D COMBE REV. TRUST
121020051

VAUGHN D ASHLEY REV. TRUST
121010062

BOUNDARY DESCRIPTION
A PART OF THE SOUTHWEST QUARTER OF SECTION 19, TOWNSHIP 6 NORTH, RANGE 1 WEST, OF THE SALT LAKE BASE AND MERIDIAN, BEGINNING AT A POINT BEING LOCATED NORTH 02°21'52" EAST 1992.18 FEET ALONG THE WEST LINE OF SAID SOUTHWEST QUARTER, AND NORTH 90°00'00" EAST 2173.68 FEET FROM THE SOUTHWEST QUARTER CORNER OF SECTION 19, RUNNING THENCE SOUTHEASTERLY ALONG THE ARC OF A 4095.80 FOOT CURVE TO THE LEFT THROUGH A CENTRAL ANGLE OF 02°19'21" A DISTANCE OF 166.02 FEET TO A POINT OF TANGENCY (CHORD BEARS: SOUTH 76°07'21" EAST 166.01 FEET); THENCE SOUTH 00°28'05" 961.84 FEET TO A POINT OF CURVATURE ON THE NORTH RIGHT OF WAY OF 17TH STREET; THENCE ALONG SAID RIGHT OF WAY NORTHWESTERLY ALONG THE ARC OF A 150.00 FOOT CURVE TO THE RIGHT THROUGH A CENTRAL ANGLE OF 15°19'33" A DISTANCE OF 40.12 FEET TO A POINT OF TANGENCY (CHORD BEARS: NORTH 81°24'14" WEST 40.00 FEET); THENCE NORTH 89°04'00" 90.55 FEET; THENCE NORTH 01°20'14" WEST 994.45 FEET TO THE POINT OF BEGINNING. CONTAINS 3.26 ACRES.

SCALE	1:50, XREF
DATE	10/25/22
DESIGN	JTN
DRAWN	JTN
CHECKED	KHW
DWG.	R 2001 - MBS SURVEY2202 - MENT SCHOFIELD SURVEYORMENT SCHOFIELD.DWG

REVISIONS	DATE	DESCRIPTION

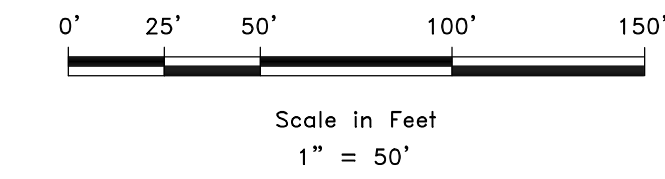
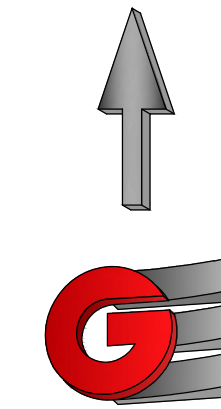

RECEIVED
OCT 28 2022
FILE # 7386

LEGEND

- ◆ WEBER COUNTY MONUMENT AS NOTED
- SET 24" REBAR AND CAP MARKED GARDNER ENGINEERING
- SUBJECT PROPERTY BOUNDARY
- LOT LINE
- - - ADJACENT PARCEL
- - - SECTION LINE
- - - EASEMENT
- x - EXISTING FENCE LINE

NARRATIVE

THE PURPOSE OF THIS SURVEY WAS TO ESTABLISH AND SET THE PROPERTY CORNERS OF THE PARCEL AS SHOWN AND DESCRIBED HEREON. THE SURVEY WAS ORDERED BY KENT SCHOFIELD. THE BASIS OF BEARING IS THE WEST LINE OF THE NORTHWEST QUARTER OF SECTION 19, WHICH BEARS NORTH 02°21'52" EAST, WEBER COUNTY, UTAH NORTH, NAD 83 STATE PLANE GRID BEARING. THE BOUNDARY WAS DETERMINED BY QUIT CLAIM DEED RECORDED AS ENTRY NUMBER 1397075, AND DEEDS OF ADJOINING PROPERTY OWNERS. THE FOUND MONUMENTS AS SHOWN AND DESCRIBED HEREON WERE ALSO USED TO DETERMINE BOUNDARY LOCATION.

SURVEYOR'S CERTIFICATE

I, KLINT H. WHITNEY, DO HEREBY CERTIFY THAT I AM A LICENSED PROFESSIONAL LAND SURVEYOR IN THE STATE OF UTAH AND THAT I HOLD CERTIFICATE NO. 8227228 IN ACCORDANCE WITH TITLE 58, CHAPTER 22, OF THE PROFESSIONAL ENGINEERS AND LAND SURVEYORS ACT; I FURTHER CERTIFY THAT BY AUTHORITY OF THE OWNERS I HAVE COMPLETED A SURVEY OF THE PROPERTY DESCRIBED ON THIS RECORD OF SURVEY PLAT IN ACCORDANCE WITH SECTION 17-23-20 AND HAVE VERIFIED ALL MEASUREMENTS; THAT THE REFERENCE MONUMENTS SHOWN ON THIS RECORD OF SURVEY PLAT ARE LOCATED AS INDICATED AND ARE SUFFICIENT TO RETRACE OR REESTABLISH THIS SURVEY; AND THAT THE INFORMATION SHOWN HEREIN IS SUFFICIENT TO ACCURATELY ESTABLISH THE LATERAL BOUNDARIES OF THE HEREIN DESCRIBED TRACT OF REAL PROPERTY.

SIGNED THIS 25TH DAY OF OCTOBER, 2022.

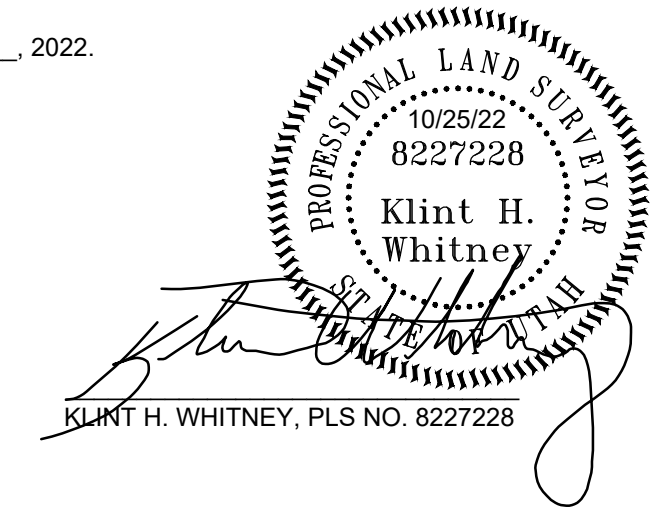

PROPERTY SURVEY FOR KENT SCHOFIELD
826 WEST 17TH STREET, OGDEN, UTAH
LOCATED IN THE SOUTHWEST QUARTER OF SECTION 19,
TOWNSHIP 6 NORTH, RANGE 1 WEST, S.L.B. AND M.

GARDNER ENGINEERING
CIVIL-LAND PLANNING
MUNICIPAL-LAND SURVEYING
5150 SOUTH 375 EAST OGDEN, UT
OFFICE: 801.476.0202 FAX: 801.476.0066

S1
1

MODEL LINEN INC
121020074

COREY D COMBE REV. TRUST
121020076

KENT & ROBYN
SCHOFIELD
121020002
CONT. 3.26 ACRES

GREEN MARRIOTT
INVESTMENTS LLC
121020004

RED RUBY LAND TRUST
121020005

WHITE PEAR
LAND TRUST
121010025

ASHLEY VAUGHN
121010038

OLGA J BARKER
FAMILY TRUST
122420001

R=150.00'
L=40.12'
Δ=15°19'33"
CHB=N81°24'14"W
CH=40.00'

N89°04'00"W
1.47' 90.55'

17TH STREET

SOUTHWEST QUARTER CORNER
SECTION 19 T6N R1W S.L.B.&M.

N02°21'52"E 2725.09' (BASIS OF BEARING)
1992.18'