

30 + 29  
31 + 32  
SOUTHWEST CORNER SECTION 29, T7N, R1W, SLB&M (FOUND 3" BRASS CAP MONUMENT)

N 89°21'16" W 5449.79' (MEASURED)  
N 88°50'32" W 5449.84' (WEBER COUNTY ARP)

29 + 28  
32 + 33  
SOUTHEAST CORNER SECTION 29, T7N, R1W, SLB&M (FOUND 3" BRASS CAP MONUMENT)

Surveyor's Certificate

I, Nathan B. Weber, certify that I am a Professional Land Surveyor as prescribed under the laws of the state of Utah and that I hold license no. 5152762. I further certify that a land survey was made of the property described below, and the findings of that survey are as shown hereon.

Deed Description  
Entry#2446124

ALL OF LOT 12, NORTH OGDEN RANCHETTES, UNIT 1, NORTH OGDEN CITY, WEBER COUNTY, UTAH.

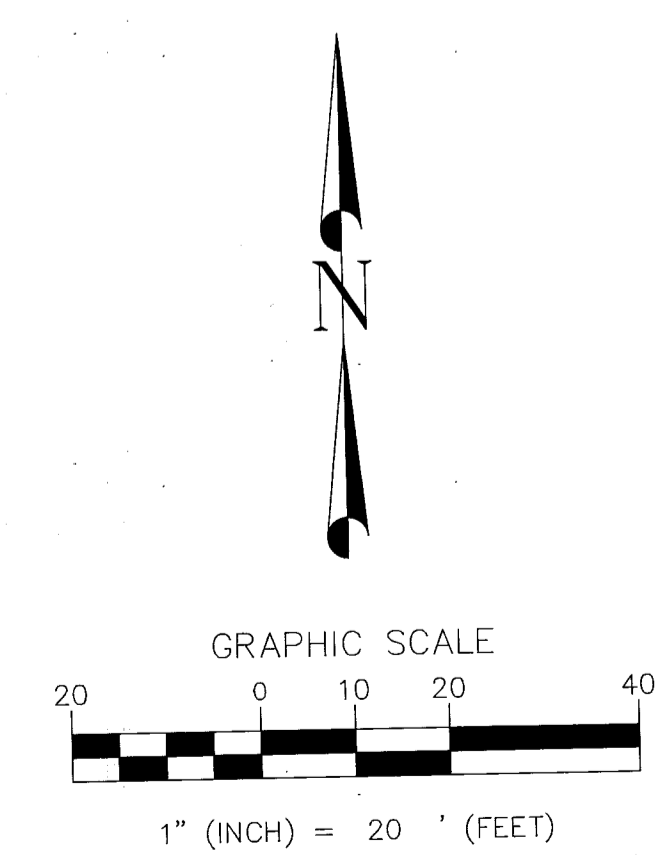

LEGEND	
	Easement Line
	Street Centerline
	Subdivision Boundary Line
	Adjoiner Line
	Section Line
	Tie Line
	Right-of-Way Line
	Fence Line
	Property Corner Set Rebar and Cap PLS 5152762
	Found Property Corner
	Tree
	Section Corner

Narrative:

The basis of bearing is North 02°57'10" East between the found property corners along the west right of way line of 200 East Street (per North Ogdan Ranchettes Unit 1) at the northeast corner of Lot 12 and the Northeast corner of Lot 15, North Ogdan Ranchettes Unit 1, located in the South Half of Section 29, Township 7 North, Range 1 West, Salt Lake Base and Meridian as shown.

The purpose of this survey is to retrace and monument the boundary of the above described property according to the official records and the location of pertinent existing improvements located on the ground.

RECEIVED  
MAR 06 2023  
BY: 7498

LOCATED IN THE SOUTH HALF OF SECTION 29, TOWNSHIP 7 NORTH, RANGE 1 WEST, SALT LAKE BASE AND MERIDIAN

NO.	DATE	REVISIONS

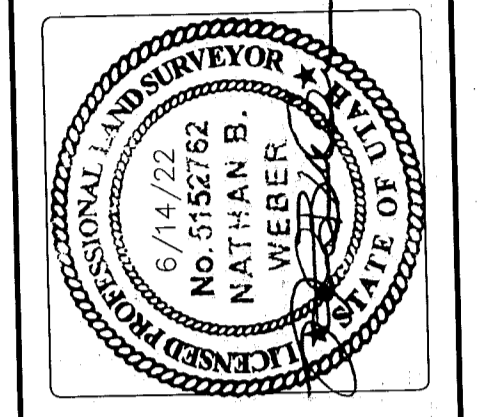

**DIAMOND LAND SURVEYING**  
 Boundary Surveys  
 Topography Surveys  
 Subdivisions  
 Construction Staking  
 A.L.T.A. & A.C.S.M. Surveys

6801 South 700 West Ste. 150  
 Moab, Utah 84047  
 Phone (801) 266-5099 Fax (801) 266-5032  
 office@diamondlandsurveying.com  
 www.diamondlandsurveying.com

BOUNDARY SURVEY  
 2647 NORTH 200 EAST  
 OGDEN, UT

ROXANNE SKINNER

DATE PLOTTED	6/14/22
JOB No.	22-082
SHEET	1 OF 1

BY: MGO  
 SURVEY DATE: 3/23/22