

- LEGEND**
- ▲ Set Nail & Washer
 - Set Rebar & Cap w/ Fencepost
 - ⊙ Set Hub & Tack
 - ⊕ Monument to be set
 - (Rad.) Radial Line
 - (N/R) Non-Radial Line

NARRATIVE

This Survey was requested by Mrs. Rosanne Bates for the purpose of establishing the boundaries of these parcels. Witness Corners were found at the Northwest Corner of the North 1/4 Corner, the Center Corner and the West 1/4 Corner of the Northwest 1/4 Corner of Section 18, T5N, R2W, SLB&M, U.S. Survey. The Section Corner Locations were positioned using the information on the Tie Sheets from the Weber County Surveyors Office. A line bearing N 0°58'16" E between the Witness Corners for the Center Corner and the North 1/4 Corner was used as the Basis of Bearings. Property Corners were monumented as depicted on this plat.

BOUNDARY DESCRIPTION

Parcel 1
Part of the Northwest Quarter of Section 18, Township 5 North, Range 2 West, Salt Lake Meridian, U.S. Survey; beginning at a point 15.50 chains South, 896.86 feet East and 476 feet South from the Northwest Corner of said Quarter Section, running thence East 74.0 feet; thence South 217.0 feet; thence West 119.0 feet; thence North 217.0 feet; thence East 45.0 feet to the point of beginning. Excepting public road to the south.

Parcel 2
A part of the Northwest Quarter of Section 18, Township 5 North, Range 2 West, Salt Lake Meridian, U.S. Survey; beginning at a point 15.50 chains South and 10.71 chains East of the Northwest Corner of said Quarter Section and running thence South 540 feet; thence East 142 feet; thence North 64 feet; thence East 45 feet; thence North 476 feet; thence West 190 feet to the place of beginning.

Parcel 3
Part of the Northwest Quarter of Section 18, Township 5 North, Range 2 West, Salt Lake Meridian, U.S. Survey; beginning at a point 15.50 chains South and 896.86 feet East of the Northwest Corner of said Quarter Section; running thence South 476 feet; thence East 74 feet; thence North 476 feet; thence West 74 feet to the place of beginning.

Parcel 4
Part of the Northwest Quarter of Section 18, Township 5 North, Range 2 West, Salt Lake Meridian, U.S. Survey; beginning at a point 15.50 chains south and 1104.18 feet East of the Northwest Corner of said Quarter Section, running thence South 10.50 chains, thence West 133.32 feet, thence North 10.50 chains, thence East 133.32 feet to the place of beginning.

SURVEYOR'S CERTIFICATE

I, Andy Hubbard, do hereby certify that I am a Professional Land Surveyor, and that I hold License No. 6242920, in accordance with Title 58, Chapter 22, of the Professional Engineers and Surveyors Licensing Act, and I have made a survey of the above described property according to Section 17-23-17 and that the above plat correctly shows the true dimensions of the property surveyed.

RECEIVED
MAY 17 2023
FILE # 7547

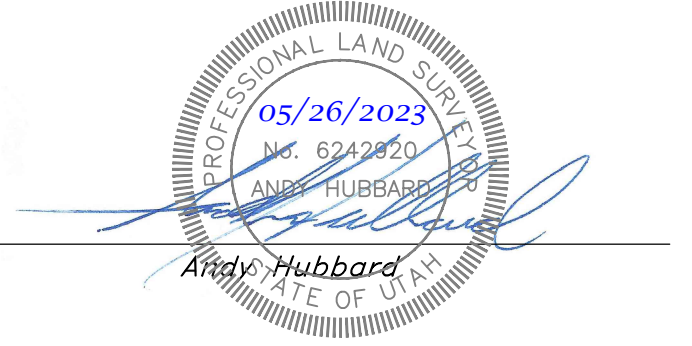

Record of Survey		Rosanne Bates Property 5760 West 5100 South, Hooper, Utah A part of the Northwest 1/4 of Section 18, T5N, R2W, SLB&M, US Survey	
	SCALE: 1" = 50'	DATE: 26 Aug, 2009	DRWG. NO.
	DRAWN: AH	REVISIONS: 26 May, 2023	09N719
<small>5746 SOUTH 1475 EAST OGDEN, UTAH 84403 MAIN (801) 394-4215 BLDG (801) 521-0222 FAX (801) 392-7544 WWW.GREATABASINENGINEERING.COM</small>			