

VICINITY MAP
(Not to Scale)

NARRATIVE

This survey was requested by John Hemmersmeier to retrace his property boundary. Basis of bearing for this survey is South S 00°40'34" W measured between the Northwest Corner and West Quarter Corner of Section 23, Township 5 North, Range 1 West Salt Lake Basin on Meridian.

Original Property corners were located throughout the lot, some of which were disturbed. This survey held the undisturbed positions without error.

Resources used in boundary retracement are as follows: Bonneville Terrace Subdivision No 3 found in Book 32, Page 77, Bonneville Terrace Subdivision No. 2 Book 18, Page 95, and Woodland Estates Subdivision Unit 3 Book 15, Page 33.

During the survey, a paved access route was found as an encroachment, and prescriptive rights across said access may have formed. The beneficiary of said potential easement has the burden of proof of possible prescriptive easement.

RECORD BOUNDARY DESCRIPTIONS
Parcel 12-120-0012

ALL OF LOT 1, BONNEVILLE TERRACE SUBDIVISION NO.3, WEBER COUNTY, UTAH.

SURVEYOR'S CERTIFICATE

I, Tyler R. Harper do hereby certify that I am a Professional Land Surveyor, and that I hold License No. 12542803, in accordance with Title 58, Chapter 22, of the Professional Engineers and Surveyors Licensing Act, and I have made a survey of the above described property according to Section 17-23-17 and that the above plat correctly shows the true dimensions of the property surveyed.

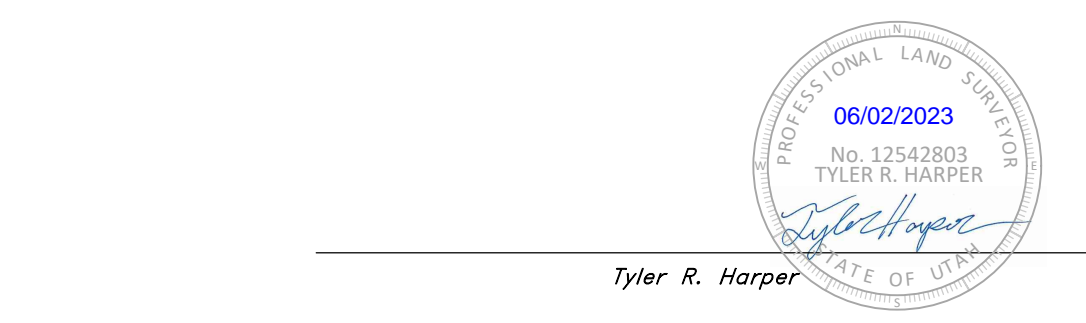

Legend
(Note: All items may not appear on drawing)

Existing Asphalt		Light Pole	
Existing Concrete		Centerline Road	
Existing Building		Existing Parcel Line	
Set 5/8"x 24" Long Rebar & Cap w/ Lath		Survey Monument Line	
A Nail set in Curb at Extension of Property		Easement Line	
Found Public Land Monument		Boundary Line	
Calculated Section Position		Existing Fence Line	
Found Survey Monument		Existing Concrete	
Calculated Survey Position		Existing Ditch	
		Record Measurement	
		Measured Record	
		Weber County Nad83 Bearing Sheet	
			W.C.S. 83

RECEIVED
JUN 05 2023
FILE # 7557

<p>GREAT BASIN ENGINEERING</p> <p>5746 SOUTH 1475 EAST OGDEN, UTAH 84403 MAIN (801)394-4515 S.L.L.C. (801)521-0222 FAX (801)392-7544 WWW.GREATBASINENGINEERING.COM</p>	<p>Record of Survey</p> <p>Bonneville Terrace</p> <p>Approx. 2500 East 5700 South Ogdens City, Weber County, Utah A part of Section 23, T5N, R1W, SLB&M, U.S. Survey</p>
<p>24 May, 2023</p>	<p>SHEET NO.</p> <p>C1</p>
<p>23N012</p>	<p>DATE</p> <p>REV</p> <p>DESCRIPTION</p>