

BOUNDARY DESCRIPTION
 ALL OF LOT 36, WOODLAND ESTATES SUBDIVISION - UNIT NO. 2, WEBER COUNTY, UTAH, AND THE SOUTHEASTERLY 20 FEET OF LOT 35, WOODLAND ESTATES SUBDIVISION UNIT NO. 2, WEBER COUNTY UTAH, ADJACENT TO THE NORTHWESTERLY BOUNDARY OF LOT 36 OF SAID SUBDIVISION.

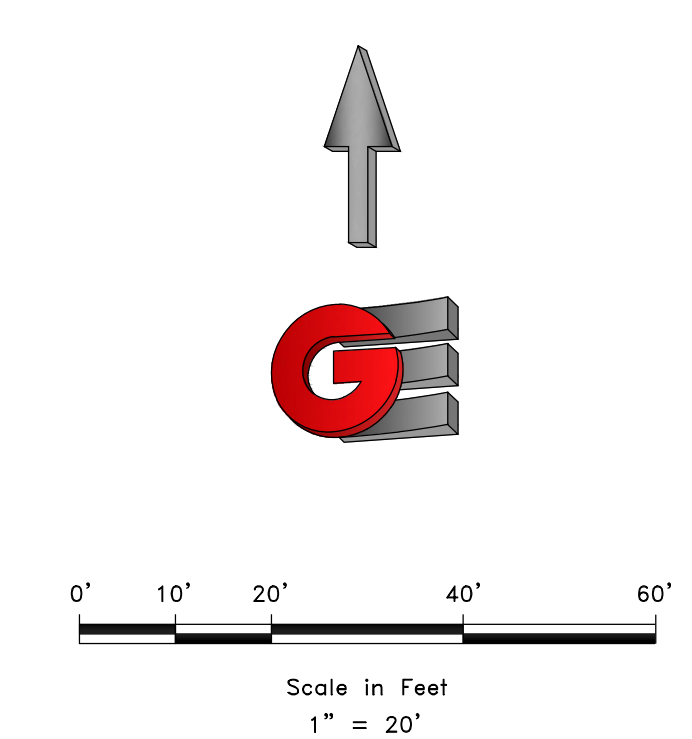

- LEGEND**
- ◆ WEBER COUNTY MONUMENT AS NOTED
 - SET 24" REBAR AND CAP MARKED GARDNER ENGINEERING
 - SUBJECT PROPERTY BOUNDARY
 - LOT LINE
 - - - ADJACENT PARCEL
 - - - SECTION LINE
 - - - EASEMENT
 - x - EXISTING FENCE LINE

NARRATIVE

THE PURPOSE OF THIS SURVEY WAS TO ESTABLISH AND SET THE PROPERTY CORNERS OF THE PARCEL AS SHOWN AND DESCRIBED HEREON. THE SURVEY WAS ORDERED BY KARL LUNDIN. THE BASIS OF BEARING IS THE CENTERLINE OF 5950 SOUTH BETWEEN TWO MONUMENTS, ONE BEING LOCATED AT THE INTERSECTION OF WOODLAND DRIVE AND THE OTHER AT A POINT OF CURVATURE ON 5950 SOUTH, WHICH BEARS SOUTH 39°08'55" WEST, WEBER COUNTY, UTAH NORTH, NAD 83 STATE PLANE GRID BEARING. THE BOUNDARY WAS DETERMINED BY WARRANTY DEED RECORDED AS ENTRY NUMBER 2524178, AND DEEDS OF ADJOINING PROPERTY OWNERS. RECORD OF SURVEY NUMBER 3311, AND THE DEDICATED PLATS OF WOODLAND ESTATES SUBDIVISION - UNIT 2 WERE ALSO USED TO DETERMINE BOUNDARY LOCATION ALONG WITH THE FOUND MONUMENTS AS SHOWN AND DESCRIBED HEREON.

SURVEYOR'S CERTIFICATE

I, KLINT H. WHITNEY, DO HEREBY CERTIFY THAT I AM A LICENSED PROFESSIONAL LAND SURVEYOR IN THE STATE OF UTAH AND THAT I HOLD CERTIFICATE NO. 8227228 IN ACCORDANCE WITH TITLE 58, CHAPTER 22, OF THE PROFESSIONAL ENGINEERS AND LAND SURVEYORS ACT; I FURTHER CERTIFY THAT BY AUTHORITY OF THE OWNERS I HAVE COMPLETED A SURVEY OF THE PROPERTY DESCRIBED ON THIS RECORD OF SURVEY PLAT IN ACCORDANCE WITH SECTION 17-23-20 AND HAVE VERIFIED ALL MEASUREMENTS; THAT THE REFERENCE MONUMENTS SHOWN ON THIS RECORD OF SURVEY PLAT ARE LOCATED AS INDICATED AND ARE SUFFICIENT TO RETRACE OR REESTABLISH THIS SURVEY; AND THAT THE INFORMATION SHOWN HEREIN IS SUFFICIENT TO ACCURATELY ESTABLISH THE LATERAL BOUNDARIES OF THE HEREIN DESCRIBED TRACT OF REAL PROPERTY.

SIGNED THIS 25TH DAY OF MAY, 2023.

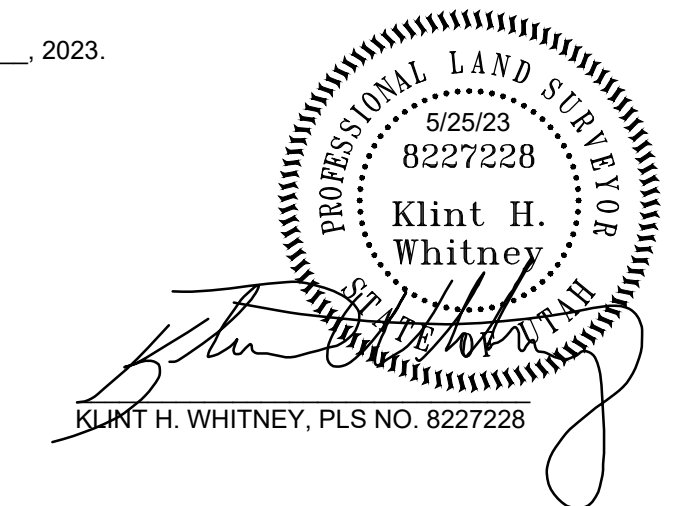

REVISIONS	DESCRIPTION
DATE	

SCALE: 1:20_XREF
 DATE: 5/25/23
 DESIGN: JTN
 DRAWN: JTN
 CHECKED: KHV
 DWG.: R1222 - LUNDIN, KARL LUNDIN - 5919 WOODLAND DRIVE SURVEY 070890014 WOODLAND DRIVE

PROPERTY SURVEY FOR KARL LUNDIN
 5919 SOUTH WOODLAND DRIVE, OGDEN, UTAH
 LOCATED IN THE NORTHEAST QUARTER OF SECTION 23,
 TOWNSHIP 5 NORTH, RANGE 1 WEST, S.L.B. AND M.

GARDNER ENGINEERING
 CIVIL - LAND PLANNING
 MUNICIPAL - LAND SURVEYING
 1800 W 2100S, WEST HAVEN, UT 84403
 P 801.476.0202 F 801.476.0066

S1
1

RECEIVED
 JUN 07 2023
 FILE # 7561