

RECEIVED
JUN 20 2023
FILE # 7568

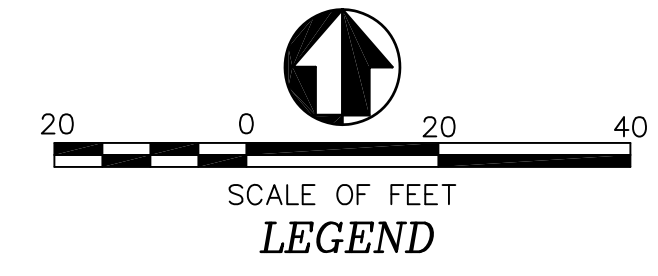

- LEGEND**
- = BOUNDARY
 - = ROAD CENTER LINE
 - = RIGHT OF WAY LINES
 - = ADJOINING LOT LINES
 - = VINYL FENCE
 - = DIMENSION LINES
 - = CURB AND GUTTER
 - = FOUND MONUMENT
 - = FOUND CURB NAIL

NARRATIVE:

Boundary Consultants was retained by Michelle and Mark Pingeton to survey the subject parcel, and determine the relationship between the vinyl fence separating the Subject Parcel from Weber County Tax Parcel 08-465-0014 and the platted common lot line.

This survey was carried out using a Trimble R8S GPS System, with ground distances being determined by GEIOD Model CONUS 12B @ height 4274.199 feet and no calibration. Basis of Bearing for this survey is Geodetic NORTH as determined by GPS or North 37°42'04" East 257.88 feet measured between the Center Line Intersection Monument located at the intersection of 4525 South Street and P.I. monument in 3600 West Street which lies northerly of said 4525 South Street.

Monumentation was located as depicted hereon and found to match the record plat. The plat was retraced with curb nails being found as depicted hereon in their record location. NO DISCREPANCIES WERE FOUND BETWEEN THE RECORD PLAT AND FOUND MONUMENTATION.

The fence lines which separate the Subject Parcel from the adjoining Lots to the North and South have been constructed on the platted lot lines. The fence which separated the Subject Parcel from the Layton Canal deviates from the platted boundary ±0.7' at the Subject Parcel's northeast corner.

DESCRIPTION:

SPECIAL WARRANTY DEED: ENTRY #3237622:

All of Lot 101, Barlow Subdivision, Phase 3, West Haven City, Weber County, Utah

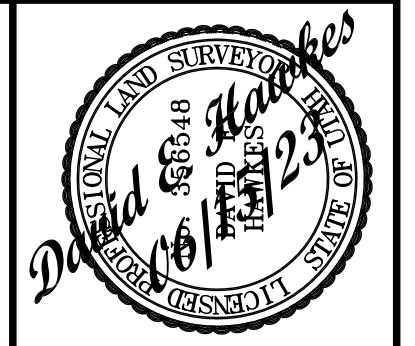

DATE: 06-15-23
SCALE: 1"=20'
PROJECT NUMBER: 2309001

RECORD OF SURVEY OF
WEBER COUNTY TAX PARCEL 08-465-0013
MICHELE and MARK PINGETON
 LYING AND SITUATE IN THE SOUTHEAST QUARTER OF SECTION 9,
 TOWNSHIP 4 NORTH, RANGE 2 WEST, SALT LAKE BASE AND MERIDIAN

Boundary Consultants
 Professional Land Surveyors
 5554 West 2425 North, Hooper, Utah
 801-792-1569
 dave@boundaryconsultants.biz

DESIGNED: DEH
DRAWN: DEH
CHECKED: DEH

SHEET 1
OF 1