

NORTH QUARTER CORNER
SEC. 29, T.7.N. R.3.E. S.L.B.&M.

N89°12'34"W 2640.94' (BASIS OF BEARING)

1180.00'

NORTHEAST CORNER
SEC. 29 T.7.N. R.3.E. S.L.B.&M.

RECORD BOUNDARY DESCRIPTION

ALL OF LOTS 670 & 671, EVERGREEN PARK SUBDIVISION NO. 1 IN WEBER COUNTY, UTAH, ACCORDING TO THE OFFICIAL PLAT THEREOF.

PARCEL "A" BOUNDARY DESCRIPTION

A PART OF THE NORTHEAST QUARTER OF SECTION 29, TOWNSHIP 7 NORTH, RANGE 3 EAST, SALT LAKE BASE & MERIDIAN, MORE PARTICULARLY DESCRIBED AS FOLLOWS: BEGINNING AT A POINT BEING LOCATED NORTH 89°12'34" WEST 1180.00 FEET ALONG THE NORTH LINE OF SAID NORTHEAST QUARTER AND SOUTH 30°23'34" WEST 814.84 FEET AND SOUTH 27°47'26" EAST 85.45 FEET, RUNNING THENCE SOUTH 27°47'26" EAST 45.48 FEET; THENCE SOUTH 33°20'27" EAST 136.46 FEET; THENCE SOUTH 89°17'08" EAST 5.15 FEET; THENCE SOUTH 09°28'40" EAST 187.18 FEET; THENCE SOUTH 71°45'52" WEST 284.06 FEET; THENCE NORTH 34°37'23" WEST 303.39 FEET; THENCE NORTH 60°06'48" EAST 357.54 FEET TO THE POINT OF BEGINNING, CONTAINING 111,932 SQ. FT. OR 2.57 ACRES.

PARCEL "B" BOUNDARY DESCRIPTION

A PART OF THE NORTHEAST QUARTER OF SECTION 29, TOWNSHIP 7 NORTH, RANGE 3 EAST, SALT LAKE BASE & MERIDIAN, MORE PARTICULARLY DESCRIBED AS FOLLOWS: BEGINNING AT A POINT BEING LOCATED NORTH 89°12'34" WEST 1180.00 FEET ALONG THE NORTH LINE OF SAID NORTHEAST QUARTER AND SOUTH 30°23'34" WEST 814.84 FEET AND SOUTH 27°47'26" EAST 85.45 FEET AND SOUTH 60°06'48" WEST 357.54 FEET AND SOUTH 34°37'23" EAST 303.39 FEET; RUNNING THENCE NORTH 71°45'52" EAST 284.06 FEET; THENCE SOUTH 09°28'40" EAST 281.06 FEET; THENCE SOUTH 65°03'32" WEST 206.05 FEET; THENCE NORTH 19°21'42" WEST 190.01 FEET; THENCE NORTH 34°37'23" WEST 116.61 FEET TO THE POINT OF BEGINNING, CONTAINING 67,863 SQ. FT. OR 1.56 ACRES.

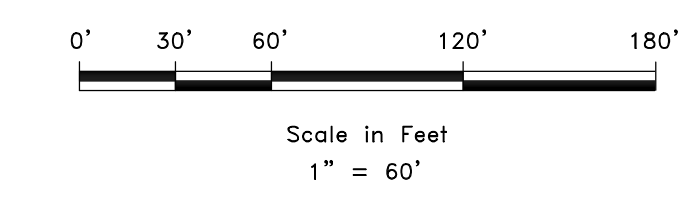
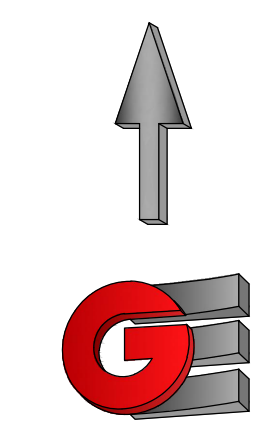

LEGEND

- WEBER COUNTY MONUMENT AS NOTED
- SET 24" REBAR AND CAP MARKED GARDNER ENGINEERING
- SUBJECT PROPERTY BOUNDARY
- LOT LINE
- ADJACENT PARCEL
- SECTION LINE
- EASEMENT
- EXISTING FENCE LINE

NARRATIVE

THE PURPOSE OF THIS SURVEY WAS TO ADJUST AND ESTABLISH THE PROPERTY LINES OF THE PARCELS AS SHOWN AND DESCRIBED HEREON. THE SURVEY WAS ORDERED BY DON CUMMINS. THE BASIS OF BEARING IS THE NORTH LINE OF THE NORTHEAST QUARTER OF SECTION 29, WHICH BEARS NORTH 89°12'34" WEST, WEBER COUNTY, UTAH NORTH, NAD 83 STATE PLANE GRID BEARING. THE BOUNDARY WAS DETERMINED BY WARRANTY DEED RECORDED AS ENTRY NUMBER 2729801, AND DEEDS OF ADJOINING PROPERTY OWNERS. THE DEDICATED PLAT OF EVERGREEN PARK SUBDIVISION NO. 1 WAS ALSO USED TO DETERMINE BOUNDARY LOCATION ALONG WITH THE FOUND MONUMENTS AS SHOWN AND DESCRIBED HEREON.

SURVEYOR'S CERTIFICATE

I, KLINT H. WHITNEY, DO HEREBY CERTIFY THAT I AM A LICENSED PROFESSIONAL LAND SURVEYOR IN THE STATE OF UTAH AND THAT I HOLD CERTIFICATE NO. 8227228 IN ACCORDANCE WITH TITLE 58, CHAPTER 22, OF THE PROFESSIONAL ENGINEERS AND LAND SURVEYORS ACT; I FURTHER CERTIFY THAT BY AUTHORITY OF THE OWNERS I HAVE COMPLETED A SURVEY OF THE PROPERTY DESCRIBED ON THIS RECORD OF SURVEY PLAT IN ACCORDANCE WITH SECTION 17-23-20 AND HAVE VERIFIED ALL MEASUREMENTS; THAT THE REFERENCE MONUMENTS SHOWN ON THIS RECORD OF SURVEY PLAT ARE LOCATED AS INDICATED AND ARE SUFFICIENT TO RETRACE OR REESTABLISH THIS SURVEY; AND THAT THE INFORMATION SHOWN HEREIN IS SUFFICIENT TO ACCURATELY ESTABLISH THE LATERAL BOUNDARIES OF THE HEREIN DESCRIBED TRACT OF REAL PROPERTY.

SIGNED THIS 7TH DAY OF AUGUST, 2023.

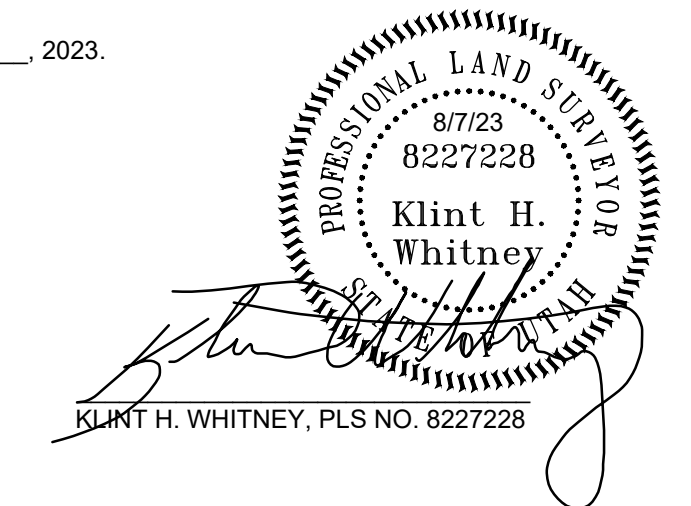

SCALE: 1" = 60'	DATE: 8/7/23	DESIGN: JTN	DRAWN: JTN	CHECKED: KHV
REVISIONS	DESCRIPTION			
DATE				
DWG. NO.: 82001 - MISC SURVEY 03101 - DON CUMMINS SURVEY/EVERGREEN DWS				

BOUNDARY ADJUSTMENT FOR DON CUMMINS
 3315 NORTH WATER CANYON AVENUE, HUNTSVILLE, UTAH
 LOCATED IN THE NORTHEAST QUARTER OF SECTION 29,
 TOWNSHIP 7 NORTH, RANGE 3 EAST, S.L.B. AND M.

GARDNER ENGINEERING
 CIVIL & LAND PLANNING
 MUNICIPAL & LAND SURVEYING
 1580 W 2100S, WEST HAVEN, UT 84005
 P 801.476.0202 F 801.476.0066

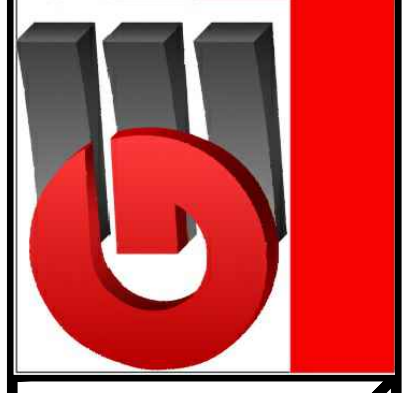

S1
 1

