

# MIDA - SDL #11-2

Record of Survey  
 A part of the North Half of Section 24 & South Half of Section 13,  
 T5N, R2W, SLB&M, U.S. Survey  
 December 2023

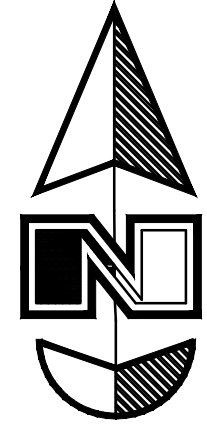

### Legend

- ▲ Set Nail & Washer
- Set Rebar & Cap w/ Fencepost
- Set Hub & Tack
- ⊕ Monument to be set (Rad.) Radial Line
- E.U.L. Enhanced Use Lease (N/R) Non-Radial Line
- Fence
- Boundary line

Scale: 1" = 50'

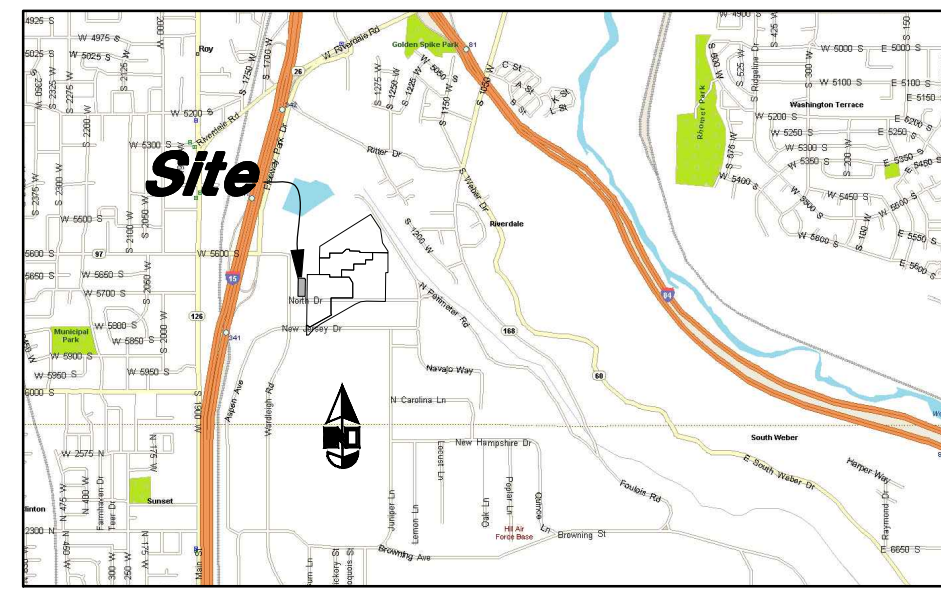
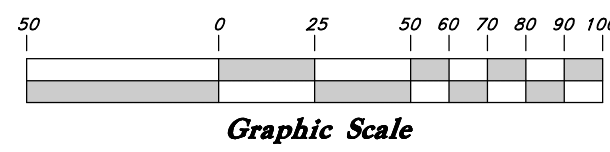

VICINITY MAP  
Not to Scale

Northwest Corner of Section 24, T5N, R2W, SLB&M, U.S. Survey (Found Brass Cap Monument)

Northeast Corner of Section 24, T5N, R2W, SLB&M, U.S. Survey (Found GLO Monument Good Condition Dated 1941)

S 89°20'36" E

5295.94'

2640.91'

S 0°47'33" W

909.88'

S 0°47'33" W

S 0°47'33" W

S 0°47'33" W

S 0°47'33" W

S 0°47'33" W

S 0°47'33" W

S 0°47'33" W

S 0°47'33" W

United States of America

United States of America

United States of America

Basis of Bearing Section Line

S 0°47'30" W

West Quarter Corner of Section 24, T5N, R2W, SLB&M, U.S. Survey (Found Brass Cap Monument)

POINT OF BEGINNING

1582.56' S 89°12'33" E

S 89°19'15" E 137.05'

Δ = 49°14'59"  
 L = 38.68'  
 R = 45.00'  
 LC = 37.50'  
 S 23°56'44" E

387.00'

N 0°43'39" E

N 89°19'15" W 153.00'

S 0°40'45" W

352.91'

**SDL #11-2**  
 58,985 Sq. Ft.  
 or 1.354 Acres

### NARRATIVE

This Survey and Recordation Plan was requested by Mr. Gary Stewart for purposes preparing a Recordation Plat for this site. Brass Cap Monuments were found at the West 1/4 Corner and Northwest Corner of Section 24 as shown on this Map. A line bearing S 0°47'33" W (UTM 12 North WGS84) between these two monuments was used as the basis of bearings. The Center of Section 36 and East Quarter Corner, South Quarter Corner, and Southeast Corner of Section 36 were calculated based on information provided by Davis County Surveyor. This Survey is being filed to show the updated Section Line Bearings and Distances in UTM 12 North Geodetic System WGS84. The Bearings and Position of the Parcel Boundary has not changed, and fits the improvements and infrastructure it was intended to encompass.

### BOUNDARY DESCRIPTION

A part of the North Half of Section 24 & South Half of Section 13 Township 5 North, Range 2 West, Salt Lake Base and Meridian, U.S. Survey: Beginning at a point 909.88 feet South 0°47'33" West along the Section line and 1582.56 feet South 89°12'27" East from the Northwest corner of said Section 24, and running thence South 89°19'15" East 137.05 feet to a point on a 45.00 foot radius curve to the right; thence Southeasterly along said curve a distance of 38.68 feet (Central Angle equals 49°14'59" and Long Chord bears South 23°56'44" East 37.50 feet); thence South 0°40'45" West 352.91 feet; thence North 89°19'15" West 153.00 feet; thence North 0°43'39" East 387.00 feet to the point of beginning. Contains 1.354 acres.

### SURVEYOR'S CERTIFICATE

I, Andy Hubbard, do hereby certify that I am a Professional Land Surveyor in the State of Utah, and that I hold Certificate No. 6242920 in accordance with Title 58, Chapter 22, of the Professional Engineers and Land Surveyors Licensing Act. I also certify to: Western Osprey L.L.C.; Stewart Title Company, Zions Bancorporation, N.A. dba Zions First National Bank, and the Secretary of the Air Force, that I have made a survey of the above described property according to the Utah State Code Section 17-23-17 and that the above plat correctly shows the true dimensions of the property surveyed.

Signed this \_\_\_\_\_ day of \_\_\_\_\_, 20\_\_

6242920  
 License No.

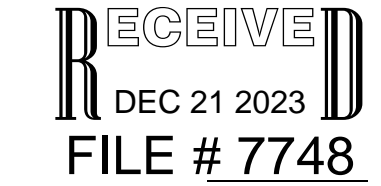
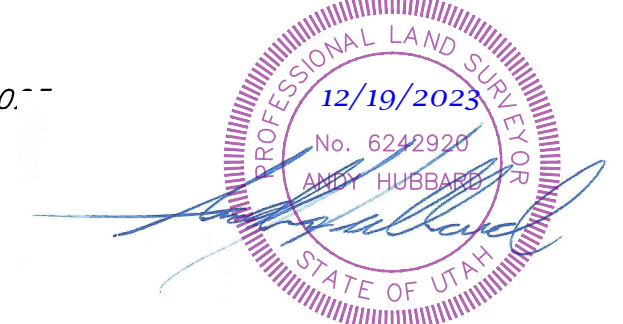

**GREAT BASIN ENGINEERING**  
 5746 SOUTH 1475 EAST, OGDEN, UTAH 84403  
 MAIN (801) 994-4511 S.L.C. (801) 521-0222 FAX (801) 992-7544  
 WWW.GREATBASINENGINEERING.COM

**Record of Survey**  
**Falcon Hill - SDL #11-2**  
 North Street and Cottonwood Street  
 Hill Air Force Base, Utah  
 A part of the North Half of Section 24, T5N, R2W, SLB&M, U.S. Survey

December, 2023  
 SHEET NO.  
**C1**  
 191903