

MONUMENTS
This Survey was requested by Mr. Neal Weaver of Mendocero Investments, Inc. in order to provide an A.L.T.A. Survey on the existing Bourn's Plant at the Weber Industrial Park. Monuments were found at the intersections of Eccles Street with Rulon White Boulevard and Breeze Way with Rulon White Boulevard. A line bearing South 4 22 29 East between these two monuments was used as the basis of bearings. No Property Corners were monumented.

- Legend**
- Catch Basin or Sump
 - Electrical Manhole
 - Water Manhole
 - Manhole (Type Unknown)
 - Fire Hydrant
 - Valve
 - Transformer Pad
 - Conduit Junction Box
 - Light Pole
 - Street Light Pole
 - Building Foundation
 - Edge of Asphalt
 - Stone Wall
 - Concrete
 - Asphalt

- ITEMS AS LISTED IN SCHEDULE B**
- Item 10 Subject to a Right To Use Any and All Existing Irrigation Ditches, Book 1353, Page 446 (Affects Parcel 3) None Found
 - Item 11 Protective and Amended Protective Comments (Affects All Parcels)
 - Item 12 Subject to the Interest of Margaret J. Berden, Per Quit Claim Deed Recorded October 29, 1990, Entry #1122390, Book 1588, Page 2668 (Affects All Parcels)

RECEIVED
OCT 21 1992
Weber County Surveyor

CERTIFICATE
To Security Union Title Insurance and Wells Fargo Bank, WA, a national banking association acting as collateral agent
This is to certify that this map or plat and the survey on which it is based were made in accordance with Minimum Standard Detail requirements for ALTA/ACSM Land Title Surveys, jointly established and adopted by ALTA and ACSM in 1986, meets the accuracy requirements of a Class A Survey, as defined therein, and includes Items 2, 5, 8, 9, 11 and 13 of Table 3 thereof

Robert J. Berden
Registered Land Surveyor
Utah #4778

PARCEL 1.
All of Lot 17, Weber Industrial Park, Plat 'A', Weber County Utah

PARCEL 2.
All of Lot 18, Weber Industrial Park, Plat 'A', Weber County, Utah

PARCEL 3.
A part of the Northwest Quarter of Section 36, Township 7 North, Range 2 West, Salt Lake Base and Meridian, U S Survey, Weber County, Utah Beginning at a point which is the Northwest Corner of Lot No. 18, Weber Industrial Park Subdivision, Plat 'A', said point also being North 89 01' East 2378.53 feet and South 934.13 feet from the Northwest Corner of said Section 36, running thence South 4 22 29' East 593.21 feet along the West line of the Weber Industrial Park Subdivision, Plat 'A', to the Northeast Corner of Lot 23 in said Subdivision, thence along the North line of said Lot 23, South 81 59' West 286.34 feet, thence North 4 22 29' West 626.23 feet, thence North 88 35 49' East 286.16 feet to the point of beginning

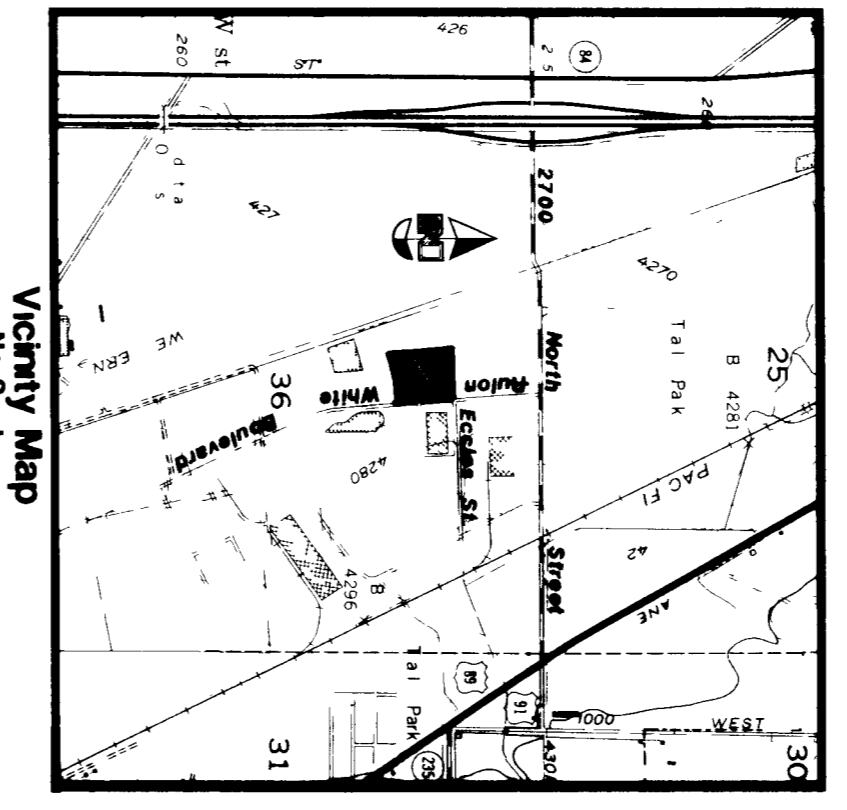

Received 10/20/92

GREAT BASIN ENGINEERING, INC.
REGISTERED PROFESSIONAL ENGINEERS
ODDSEN & SALT LAKE CITY, UTAH

Certificate of Survey
for
Bourn's Inc

DATE	BY	SCALE	PROJECT
JULY 23, 1991	RJB	1" = 40'	CS 91 39