

PARCEL 10-040-0086
WESTSIDE INVESTMENTS
ENTRY #2613541 Parcel 4
ENTRY #2258982

±896.15' deed
896.57' Meas.

974.19' Meas.
1013.02' deed

±50046.01' W 168.35' deed
N01'42'04" E 170.09'

PARCEL 10-040-0084
WESTSIDE INVESTMENTS
ENTRY #2613541 Parcel 7
ENTRY #2338533
REMAINDER PARCEL
WESTSIDE INVESTMENTS
Contains 3.69 acres
±160,783 sq. ft.

PARCEL 10-040-0082
WESTSIDE INVESTMENTS
ENTRY #

PARCEL 10-040-0080
WESTSIDE INVESTMENTS, L.C.
ENTRY #2613541 Parcel 3
ENTRY #2103034

PARCEL 10-040-0087
ENTRY #2889720
ROS 7770

P.O.B. PURCHASE PARCEL

1011.55' Deed
972.54' Meas.

39.00'

Fnd. Bar/Cap stamped "P.L.S. 356548" set by Boundary Consultants in 2019

PARCEL 10-040-0093
HIMES
ENTRY #2415860

PARCEL 10-040-0079
ENTRY #1038083

PARCEL 10-040-0075
ENTRY #103014

PARCEL 10-040-0078
ENTRY #1030212

PARCEL 10-040-0087
ENTRY #3273232
ROS 7770
SUBJECT PARCEL ADJUSTED
MATTHEWS
Contains 1.31 acres
±57,258 sq. ft.

PARCEL 10-040-0095
MATTHEWS
ENTRY #3187336

P.O.B. ADJUSTED PARCEL

Fnd. Bar/Cap stamped "P.L.S. 356548" set by Boundary consultants in 2019

N89°37'51"W 2685.64' (Meas.)
N89°36'39"W 2685.19' per Weber County Surveyor

N89°02'28"W 2751.11' (Meas.)
N89°01'43"W per Gardner Engineering
N89°01'43"W 2751.29 per ROS 4158
N89°01'32"W 2751.25 per Weber County Surveyor

CORPORATION OF THE PRESIDING BISHOP OF THE
CHURCH OF JESUS CHRIST OF LATTERDAY SAINTS

PARCEL 10-040-0076
ENTRY #1028302

PARCEL 10-040-0049
ENTRY #1030014

PARCEL 10-040-0077
ENTRY #1030221

SR-126
2000 west

RECEIVED
MAY 7 2024
FILE # 7821

N00°02'00"E 2639.41' Meas.
N00°03'09"E 2339.44' per Weber County Surveyor
BASIS OF BEARING

FARR WEST CITY

Sta. 349+16.7 per UDOT Plans
696.7' per UDOT Plans
705.39' (Calc'd)
755.39'

South East Corner Section 35, Township 7 North, Range 2 West, Salt Lake Base and Meridian. Fnd. Weber County Brass Cap Well Monument.

East Quarter Corner Section 35, Township 7 North, Range 2 West, Salt Lake Base and Meridian. Fnd. Weber County Brass Cap Monument.

Sta. 402+38.5 per UDOT Plans
641.53' (Calc'd)
632.9' per UDOT Plans

Northeast Corner Section 35, Township 7 North, Range 2 West, Salt Lake Base and Meridian. Fnd. Weber County Brass Cap Monument.

NARRATIVE:

Boundary Consultants were retained by Julie and Joseph Matthews, to adjust the common boundary between the depicted parcels. This survey was carried out using a Trimble R8S GPS System with ground distances being determined by GEIOD Model CONUS 12B at height 4225.484 with no calibration. Basis of Bearing for this survey is North 00°02'00" East 2639.41 feet measured between the Weber County brass cap monuments marking East line of the Southeast Quarter of Section 35, Township 7 North, Range 2 West, Salt Lake Base and Meridian. See Record of Survey 7770, filed in the Weber County Surveyor's Office which depicts the surveyed boundary of the Matthews parcel prior to this adjustment.

CURRENT DESCRIPTIONS:

MATTHEWS PARCEL: WARRANTY DEED: ENTRY #3273232:

Part of the Southeast Quarter of Section 35, Township 7 North, Range 2 West, Salt Lake Meridian, U.S. Survey, Beginning 36.5 rods [45.78 rods, meas.] WEST [North 89°01'03" West, measured] and 1314.5 feet [1309.09 feet, meas.] NORTH [North 01°26'15" East, meas.] from the Southeast Corner of said Southeast Quarter; Thence NORTH 146.17 feet [North 01°26'15" East 144.49 feet, meas.]; Thence WEST 133 feet [North 89°24'35" West 129.01 feet, meas.]; Thence NORTH 20 feet [North 00°29'01" East 19.66 feet, meas.]; Thence WEST 1206.5 feet [North 89°18'41" West 1208.61 feet, meas.]; Thence SOUTH 166.17 feet [South 00°47'37" West 167.46 feet, meas.]; Thence EAST 1339.5 feet [South 89°27'47" East 1336.12 feet, meas.] to the point of beginning.

Except [LESS AND EXCEPTING THEREFROM]:

Part of the Southeast Quarter of Section 35, Township 7 North, Range 2 West, Salt Lake Meridian, Beginning at a point located North 00°03'07" East 1322.05 feet [North 00°02'00" East 1320.90 feet, Meas.] along the east line of said Southeast Quarter and North 90°00'00" West 723.42 feet [North 89°58'00" West 723.42 feet, meas.] to a point described as being located 602.25 feet WEST and 1314.5 NORTH from the Southeast Corner of said Southeast Quarter; and North 89°27'57" West 324.65 feet [North 89°26'50" West 324.57 feet, meas.] from the Southeast Corner of said Southeast Quarter; Running thence North 89°27'57" West 1011.55 feet [North 89°26'50" West 1011.54 feet, meas.] to an existing fence line; Thence North 01°00'02" East 166.17 feet [North 00°47'37" East 167.10 feet, meas.] along said fence; Thence South 89°27'57" East 1013.02 feet [South 89°18'41" East 1013.02 feet, meas.]; Thence South 01°30'32" West 166.19 feet [South 01°18'31" West 164.70 feet, meas.] to the point of beginning.

WESTSIDE INVESTMENTS PARCEL: WARRANTY DEED: ENTRY #2613541, PARCEL 7:

Part of the Southeast Quarter of Section 35, Township 7 North, Range 2 West, of the Salt Lake Base & Meridian, Beginning at a point located North 00°03'07" East 1322.05 feet along the east line of said Southeast Quarter and North 90°00'00" West 723.42 feet (to a point described as being located 302.25 feet WEST and 1314.5 feet NORTH from the Southeast Corner of said Southeast Quarter) and North 89°27'57" West 324.65 feet from the Southeast Corner of said Southeast Quarter; Running thence North 89°27'57" West 1011.55 feet to an existing fence line; Thence North 01°00'02" East 166.17 feet along said fence; Thence South 89°27'57" East 1013.02 feet; Thence South 01°30'32" West 166.19 feet to the point of beginning.

DESCRIPTION OF PURCHASE PARCEL:

Part of the Southeast Quarter of Section 35, Township 7 North, Range 2 West, of the Salt Lake Base & Meridian, Commencing at the 2005 Weber County Brass Cap Monument marking the Southeast Corner of said Section 35, thence North 00°02'00" East 1320.90 feet coincident with the east line of said Section 35; thence North 89°58'00" West 723.22 feet to a point on the east right of way of SR-126 (2000 West Street); Thence North 89°26'50" West 363.57 feet to a number five rebar and cap stamped "PLS 356548" and the True Point of Beginning; Thence North 01°18'31" East 164.80 feet to a number five rebar and cap stamped "PLS 356548"; Thence South 89°18'41" East 39.00 feet; Thence South 01°18'31" West 164.71 feet; Thence North 89°26'50" West 39.00 feet to the point of beginning.

ADJUSTED DESCRIPTIONS:

MATTHEWS PARCEL COMBINED:

A parcel of land lying and situate in the Southeast Quarter of the Section 35, Township 7 North, Range 2 West, Salt Lake Base and Meridian. Basis of Bearing being North 00°02'00" East 2639.41 feet, measured, between the 2005 Weber County brass cap monument marking the Southeast Corner, and the 1974 Weber County brass cap monument marking the East Quarter Corner of said Section 35;

Beginning at the Southeast Corner of said Section 35, thence North 00°02'00" East 1320.90 feet coincident with the east line of the Southeast Quarter of said Section 35; Thence North 89°58'00" West 723.22 feet to a point on the west right of way line of SR-126 (2000 West) and the True Point of Beginning; Thence North 89°26'50" West 363.57 feet along a fence line to a number five rebar and cap stamped "PLS 356548"; Thence North 01°18'31" East 164.80 feet to a number five rebar and cap stamped "PLS 356548"; Thence the following three (3) courses coincident with an agreement line, described in that certain Boundary Line Agreement recorded as Entry 3313110, in the Office of the Weber county Recorder, and the prolongation thereof, 1) South 89°18'41" East 234.60 feet; 2) South 00°29'01" West 19.66 feet; 3) South 89°24'35" East 129.01 feet to a point on said west right of way line; Thence South 01°26'15" West 144.49 feet coincident with said right of way to the point of beginning. Contains 1.31 acres, ±57,258 sq. ft.

WESTSIDE INVESTMENTS REMAINDER PARCEL. (NOT SURVEYED):

Part of the Southeast Quarter of Section 35, Township 7 North, Range 2 West, of the Salt Lake Base & Meridian, Beginning at a point located North 00°03'07" East 1322.05 feet along the east line of said Southeast Quarter and North 90°00'00" West 723.42 feet (to a point described as being located 302.25 feet WEST and 1314.5 feet NORTH from the Southeast Corner of said Southeast Quarter) and North 89°27'57" West 324.65 feet from the Southeast Corner of said Southeast Quarter; Running thence North 89°27'57" West 1011.55 feet to an existing fence line; Thence North 01°00'02" East 166.17 feet along said fence; Thence South 89°27'57" East 1013.02 feet; Thence South 01°30'32" West 166.19 feet to the point of beginning.

LESS AND EXCEPTING THEREFROM:

Part of the Southeast Quarter of Section 35, Township 7 North, Range 2 West, of the Salt Lake Base & Meridian, Commencing at the 2005 Weber County Brass Cap Monument marking the Southeast Corner of said Section 35, thence North 00°02'00" East 1320.90 feet coincident with the east line of said Section 35; Thence North 89°58'00" West 723.22 feet to a point on the east right of way of SR-126 (2000 West Street); Thence North 89°26'50" West 363.57 feet to a number five rebar and cap stamped "PLS 356548" and the True Point of Beginning; Thence North 01°18'31" East 164.80 feet to a number five rebar and cap stamped "PLS 356548"; Thence South 89°18'41" East 39.00 feet; Thence South 01°18'31" West 164.71 feet; Thence North 89°26'50" West 39.00 feet to the point of beginning. Contains 3.69 acres, ±160,783 sq. ft.

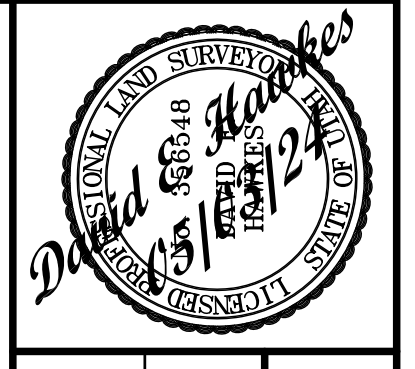

DATE: 05-03-24
SCALE: 1"=30'
PROJECT NUMBER: 2402001

PARCEL ADJUSTMENT OF WEBER COUNTY
TAX PARCELS 19-040-0087, -0094
LYING AND SITUATE IN THE SOUTHEAST QUARTER OF SECTION 35,
TOWNSHIP 7 NORTH, RANGE 2 WEST, SALT LAKE BASE AND MERIDIAN

Boundary Consultants
Professional Land Surveyors
5554 West 2425 North, Hooper, Utah
801-792-1569
dave@boundaryconsultants.biz

DESIGNED	DEH
DRAWN	DEH
CHECKED	DEH
SHEET	1
OF	1