

**BOUNDARY DESCRIPTION**  
 ALL OF LOT 33, LEWIS PEAK P.R.U.D. PHASE 2, NORTH OGDEN CITY, WEBER COUNTY, UTAH, ACCORDING TO THE OFFICIAL PLAT THEREOF.

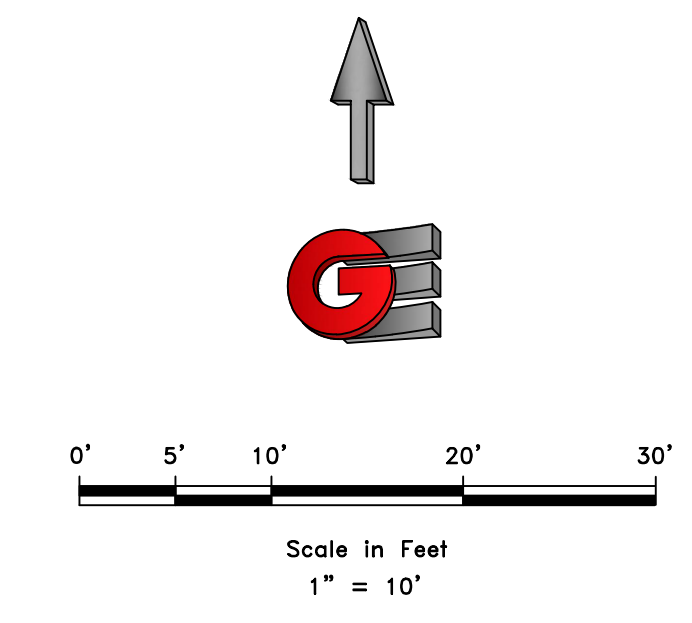

- LEGEND**
- ◆ CENTERLINE MONUMENT AS NOTED
  - SET 24\"/>

**NARRATIVE**

THE PURPOSE OF THIS SURVEY WAS TO ESTABLISH AND SET THE PROPERTY CORNERS OF THE PARCEL AS SHOWN AND DESCRIBED HEREON. THE SURVEY WAS ORDERED BY JASON WESTBROEK. THE BASIS OF BEARING IS THE CENTERLINE OF 825 EAST BETWEEN TWO FOUND MONUMENTS AT THE INTERSECTION OF 1525 NORTH AND 825 EAST AND THE INTERSECTION OF 1550 NORTH AND 825 EAST, WHICH BEARS NORTH 00°40'48\"/>

**SURVEYOR'S CERTIFICATE**

I, KLINT H. WHITNEY, DO HEREBY CERTIFY THAT I AM A LICENSED PROFESSIONAL LAND SURVEYOR IN THE STATE OF UTAH AND THAT I HOLD CERTIFICATE NO. 8227228 IN ACCORDANCE WITH TITLE 58, CHAPTER 22, OF THE PROFESSIONAL ENGINEERS AND LAND SURVEYORS ACT; I FURTHER CERTIFY THAT BY AUTHORITY OF THE OWNERS I HAVE COMPLETED A SURVEY OF THE PROPERTY DESCRIBED ON THIS RECORD OF SURVEY PLAT IN ACCORDANCE WITH SECTION 17-23-20 AND HAVE VERIFIED ALL MEASUREMENTS; THAT THE REFERENCE MONUMENTS SHOWN ON THIS RECORD OF SURVEY PLAT ARE LOCATED AS INDICATED AND ARE SUFFICIENT TO RETRACE OR REESTABLISH THIS SURVEY; AND THAT THE INFORMATION SHOWN HEREIN IS SUFFICIENT TO ACCURATELY ESTABLISH THE LATERAL BOUNDARIES OF THE HEREIN DESCRIBED TRACT OF REAL PROPERTY.

SIGNED THIS 8TH DAY OF MAY, 2024.

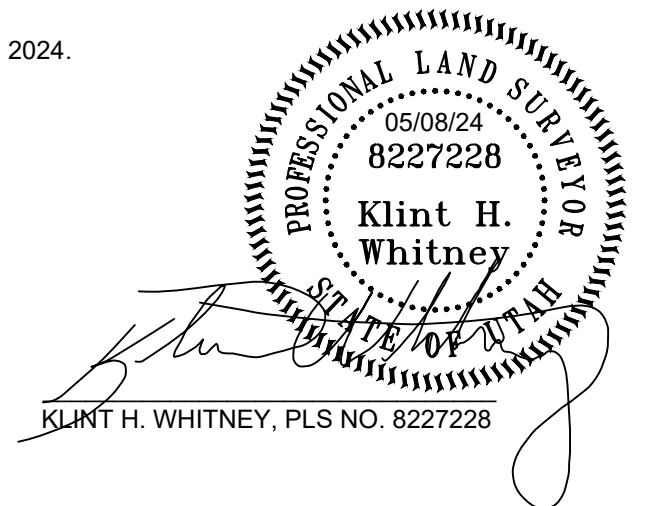

RECEIVED  
 MAY 09 2024  
 FILE # 7826

DATE	REVISIONS DESCRIPTION

SCALE: 1:10\_XREF  
 DATE: 5/8/24  
 DESIGN: JTN  
 DRAWN: JTN  
 CHECKED: KHV  
 DWG.: 14030013-ASCS SURVEY-0466-JASON WESTBROEK\HOUSES\SURVEY\DWG\ASCS\WESTBROEK.DWG

PROPERTY SURVEY FOR JASON WESTBROEK  
 1528 NORTH 825 EAST, NORTH OGDEN, UTAH  
 LOCATED IN THE NORTHEAST QUARTER OF SECTION 4,  
 TOWNSHIP 6 NORTH, RANGE 1 WEST, S.L.B. AND M.

**GARDNER ENGINEERING**  
 CIVIL & LAND PLANNING  
 MUNICIPAL & LAND SURVEYING  
 1580 W 2100S, WEST HAVEN, UT 84401  
 P 801.476.0202 F 801.476.0066

S1  
 1