

RECORD BOUNDARY DESCRIPTION

A PART OF THE SOUTHWEST QUARTER OF SECTION 29, TOWNSHIP 7 NORTH, RANGE 1 EAST, OF THE PART OF THE SOUTHWEST QUARTER OF SECTION 29, AND THE NORTHWEST QUARTER OF SECTION 32, TOWNSHIP 7 NORTH, RANGE 1 EAST, SALT LAKE BASE AND MERIDIAN, U.S. SURVEY, BEGINNING AT THE NORTHEAST CORNER OF LOT 102, SILVER BELL ESTATES NO. 2, WEBER COUNTY, UTAH: RUNNING THENCE WEST 285.00 FEET, THENCE SOUTH55D00' WEST 506.45 FEET, THENCE NORTH 35D00' WEST 80.00 FEET, THENCE NORTH 61D45'23" EAST 517.64 FEET, THENCE EAST 289.74 FEET, THENCE SOUTH 20.00 FEET TO THE POINT OF BEGINNING. CONTAINING 0.715 ACRES. (NOTE: BEARINGS SHOWN HEREON ARE ROTATED TO UTAH NORTH NAD 83 STATE PLANE BEARINGS)

SCALE:	1" = 50'
DATE:	7/1/20
DESIGN:	
DRAWN:	KHW
CHECKED:	KHW

REVISIONS	DESCRIPTION
DATE	

PROPERTY SURVEY FOR NORDIC MOUNTAIN WATER
 +/-2700 NORTH 3500 EAST, EDEN, UTAH
 LOCATED IN THE SW 1/4 OF SEC. 29, AND THE NW 1/4 SEC. 32
 TOWNSHIP 7 NORTH, RANGE 1 EAST, S.L.B. AND M.

GARDNER ENGINEERING
 CIVIL - LAND PLANNING
 MUNICIPAL - LAND SURVEYING
 1580 W 2100S, WEST HAVEN, UT 84401
 P 801.476.0202 F 801.476.0066

S1
 1

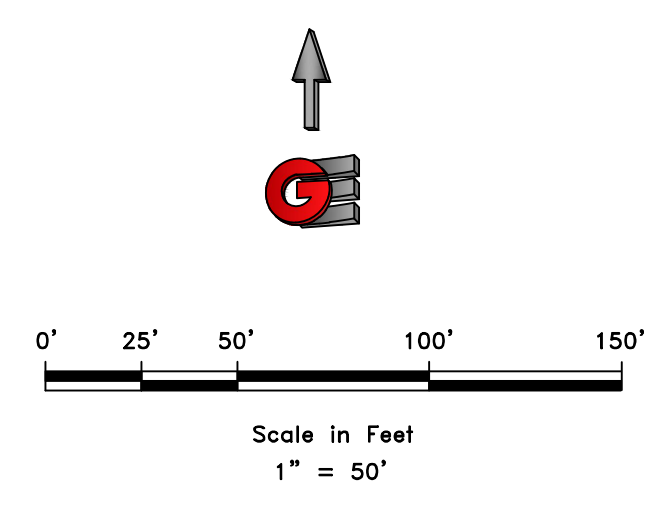

- LEGEND**
- ◆ WEBER COUNTY MONUMENT AS NOTED
 - SET 24" REBAR AND CAP MARKED GARDNER ENGINEERING
 - FOUND PROPERTY CORNER
 - SUBJECT PROPERTY BOUNDARY
 - LOT LINE
 - - - ADJACENT PARCEL
 - - - SECTION LINE
 - - - EASEMENT
 - - - EXISTING FENCE LINE

NARRATIVE

THE PURPOSE OF THIS SURVEY WAS TO ESTABLISH AND SET THE PROPERTY CORNERS OF THE PARCEL AS SHOWN AND DESCRIBED HEREON. THE SURVEY WAS ORDERED BY NORDIC MOUNTAIN WATER. THE BASIS OF BEARING IS THE SOUTH LINE OF THE SOUTHWEST QUARTER OF SECTION 29, TOWNSHIP 7 NORTH, RANGE 1 EAST, OF THE SALT LAKE BASE AND MERIDIAN WHICH BEARS NORTH 87°58'09" WEST, WEBER COUNTY, UTAH NORTH, NAD 83 STATE PLANE GRID BEARING. THE BOUNDARY WAS DETERMINED BY WARRANTY DEED RECORDED AS ENTRY NUMBER 1776658, AND DEEDS OF ADJOINING PROPERTY OWNERS. RECORD OF SURVEY NUMBERS 7486, 2028, AND THE DEDICATED PLAT OF SILVER BELL ESTATES NUMBER 2 WAS ALSO USED TO DETERMINE BOUNDARY LOCATION ALONG WITH THE FOUND MONUMENTS AS SHOWN AND DESCRIBED HEREON.

SURVEYOR'S CERTIFICATE

I, KLINT H. WHITNEY, DO HEREBY CERTIFY THAT I AM A LICENSED PROFESSIONAL LAND SURVEYOR IN THE STATE OF UTAH AND THAT I HOLD CERTIFICATE NO. 8227228 IN ACCORDANCE WITH TITLE 58, CHAPTER 22, OF THE PROFESSIONAL ENGINEERS AND LAND SURVEYORS ACT; I FURTHER CERTIFY THAT BY AUTHORITY OF THE OWNERS I HAVE COMPLETED A SURVEY OF THE PROPERTY DESCRIBED ON THIS RECORD OF SURVEY PLAT IN ACCORDANCE WITH SECTION 17-23-20 AND HAVE VERIFIED ALL MEASUREMENTS; THAT THE REFERENCE MONUMENTS SHOWN ON THIS RECORD OF SURVEY PLAT ARE LOCATED AS INDICATED AND ARE SUFFICIENT TO RETRACE OR REESTABLISH THIS SURVEY; AND THAT THE INFORMATION SHOWN HEREIN IS SUFFICIENT TO ACCURATELY ESTABLISH THE LATERAL BOUNDARIES OF THE HEREIN DESCRIBED TRACT OF REAL PROPERTY.

SIGNED THIS 7TH DAY OF MAY, 2024.

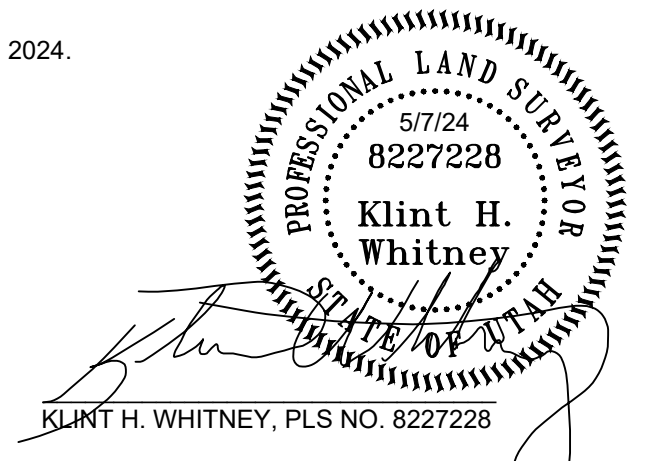

RECEIVED
 MAY 24 2024
 FILE # 7829

