

RECORD PARCEL 070920034 BOUNDARY DESCRIPTION

PART OF THE SOUTHEAST QUARTER OF SECTION 23, TOWNSHIP 5 NORTH, RANGE 1 WEST, SALT LAKE BASE & MERIDIAN, US SURVEY, DESCRIBED AS FOLLOWS: BEGINNING AT A POINT THAT IS NORTH 89°42'41" WEST ALONG THE SOUTH SECTION LINE 838.00 FEET FROM THE SOUTHEAST CORNER OF SAID SECTION 23, THENCE NORTH 89°42'41" WEST 178.90 FEET TO THE EAST LINE OF EASTWOOD SUBDIVISION, THENCE ALONG SAID EAST LINE NORTH 30°04'34" EAST 70.60 FEET, THENCE ALONG SAID EAST LINE NORTH 10°43'41" WEST 129.11 FEET, THENCE SOUTH 89°42'41" EAST 128.43 FEET, THENCE SOUTH 00°17'19" WEST 79.00 FEET, THENCE SOUTH 89°42'41" EAST 40.00 FEET, THENCE SOUTH 00°17'19" WEST 109.00 FEET TO THE POINT OF BEGINNING.

RECORD PARCEL 070920056 BOUNDARY DESCRIPTION

PART OF THE SOUTHEAST QUARTER OF SECTION 23, TOWNSHIP 5 NORTH, RANGE 1 WEST, SALT LAKE BASE & MERIDIAN, US SURVEY, DESCRIBED AS FOLLOWS: BEGINNING AT A POINT THAT IS NORTH 89°42'41" WEST ALONG THE SOUTH SECTION LINE 780.00 FEET FROM THE SOUTHEAST CORNER OF SAID SECTION 23, THENCE NORTH 89°42'41" WEST 58.00 FEET THENCE NORTH 00°17'19" EAST 109.00 FEET, THENCE NORTH 89°42'41" WEST 40.00 FEET, THENCE NORTH 00°17'19" EAST 79.00 FEET, THENCE SOUTH 89°42'41" EAST 98.07 FEET, THENCE SOUTH 00°17'19" WEST 188.00 FEET TO THE POINT OF BEGINNING.

RECORD PARCEL 070920055 BOUNDARY DESCRIPTION

PART OF THE SOUTHEAST QUARTER OF SECTION 23, TOWNSHIP 5 NORTH, RANGE 1 WEST, SALT LAKE BASE & MERIDIAN, US SURVEY, DESCRIBED AS FOLLOWS: BEGINNING AT A POINT THAT IS NORTH 89°42'41" WEST ALONG THE SOUTH SECTION LINE 754.28 FEET, FROM THE SOUTHEAST CORNER OF SAID SECTION 23, THENCE NORTH 89°42'41" WEST 25.72 FEET, THENCE NORTH 00°17'19" EAST 188.00 FEET, THENCE SOUTH 89°42'41" EAST 54.00 FEET, THENCE SOUTH 00°17'19" WEST 113.00 FEET, THENCE SOUTH 57°13'24" WEST 27.86 FEET, THENCE SOUTH 05°00'00" WEST 60.00 FEET TO THE POINT OF BEGINNING.

ADJUSTED PARCEL 070920056 BOUNDARY DESCRIPTION

A PART OF THE SOUTHEAST QUARTER OF SECTION 23, TOWNSHIP 5 NORTH, RANGE 1 WEST, OF THE SALT LAKE BASE AND MERIDIAN, BEGINNING AT A POINT ON THE SOUTH LINE OF SAID SOUTHEAST QUARTER BEING LOCATED NORTH 89°42'41" WEST 837.77 FEET ALONG SAID SOUTH LINE FROM THE SOUTHEAST CORNER OF SAID SOUTHEAST QUARTER; RUNNING THENCE NORTH 00°35'01" EAST 44.83 FEET; THENCE NORTH 89°42'41" WEST 13.68 FEET; THENCE NORTH 02°01'43" EAST 10.67 FEET; THENCE NORTH 88°10'26" WEST 8.88 FEET; THENCE NORTH 03°21'19" EAST 53.34 FEET; THENCE NORTH 00°17'19" EAST 79.00 FEET, THENCE SOUTH 89°42'41" EAST 131.15 FEET; THENCE SOUTH 00°17'26" WEST 113.00 FEET; THENCE SOUTH 57°13'24" WEST 27.86 FEET; THENCE SOUTH 05°00'00" WEST 60.00 FEET TO SAID SOUTH LINE; THENCE ALONG SAID SOUTH LINE NORTH 89°42'41" WEST 83.72 FEET TO THE POINT OF BEGINNING, CONTAINING 0.51 ACRES.

ADJUSTED PARCEL 070920034 BOUNDARY DESCRIPTION

A PART OF THE SOUTHEAST QUARTER OF SECTION 23, TOWNSHIP 5 NORTH, RANGE 1 WEST, OF THE SALT LAKE BASE AND MERIDIAN, BEGINNING AT A POINT ON THE SOUTH LINE OF SAID SOUTHEAST QUARTER BEING LOCATED NORTH 89°42'41" WEST 837.77 FEET ALONG SAID SOUTH LINE FROM THE SOUTHEAST CORNER OF SAID SOUTHEAST QUARTER; RUNNING THENCE NORTH 89°42'41" WEST 78.50 FEET ALONG SAID SOUTH LINE; THENCE NORTH 30°04'34" EAST 70.60 FEET; THENCE NORTH 10°43'41" WEST 129.11 FEET; THENCE SOUTH 89°42'41" EAST 149.35 FEET; THENCE SOUTH 00°17'19" WEST 79.00 FEET; THENCE SOUTH 03°21'19" WEST 53.34 FEET; THENCE SOUTH 88°10'26" EAST 8.88 FEET; THENCE SOUTH 02°01'43" WEST 10.67 FEET; THENCE SOUTH 89°42'41" EAST 13.68 FEET; THENCE SOUTH 00°35'01" WEST 44.83 FEET TO THE POINT OF BEGINNING, CONTAINING 0.61 ACRES.

AREA "A" BOUNDARY DESCRIPTION

A PART OF THE SOUTHEAST QUARTER OF SECTION 23, TOWNSHIP 5 NORTH, RANGE 1 WEST, OF THE SALT LAKE BASE AND MERIDIAN, BEGINNING AT A POINT BEING LOCATED NORTH 89°42'41" WEST 837.77 FEET ALONG SAID SOUTH LINE AND NORTH 00°35'01" EAST 44.83 FEET AND NORTH 89°42'41" WEST 13.68 FEET AND NORTH 02°01'43" EAST 10.67 FEET AND NORTH 88°10'26" WEST 8.88 FEET AND NORTH 03°21'19" EAST 53.34 FEET FROM THE SOUTHEAST CORNER OF SAID SOUTHEAST QUARTER; RUNNING THENCE NORTH 89°42'41" EAST 19.15 FEET; THENCE SOUTH 00°17'19" WEST 64.17 FEET; THENCE NORTH 89°42'41" WEST 13.45 FEET; THENCE NORTH 02°01'43" EAST 10.67 FEET; THENCE NORTH 88°10'26" WEST 8.88 FEET; THENCE NORTH 03°21'19" EAST 53.34 FEET TO THE POINT OF BEGINNING, CONTAINING 1257 SQUARE FEET.

AREA "B" BOUNDARY DESCRIPTION

A PART OF THE SOUTHEAST QUARTER OF SECTION 23, TOWNSHIP 5 NORTH, RANGE 1 WEST, OF THE SALT LAKE BASE AND MERIDIAN, BEGINNING AT A POINT BEING LOCATED NORTH 89°42'41" WEST 837.77 FEET ALONG SAID SOUTH LINE AND NORTH 00°35'01" EAST 44.83 FEET AND NORTH 89°42'41" WEST 13.68 FEET AND NORTH 02°01'43" EAST 10.67 FEET AND NORTH 88°10'26" WEST 8.88 FEET AND NORTH 03°21'19" EAST 53.34 FEET FROM THE SOUTHEAST CORNER OF SAID SOUTHEAST QUARTER; RUNNING THENCE NORTH 89°42'41" WEST 20.85 FEET; THENCE NORTH 00°17'19" EAST 79.00 FEET; THENCE SOUTH 89°42'37" EAST 20.85 FEET; THENCE SOUTH 00°17'19" WEST 79.00 FEET TO THE POINT OF BEGINNING, CONTAINING 1638 SQUARE FEET.

LEGEND

- ◆ WEBER COUNTY MONUMENT AS NOTED
- SET 24" REBAR AND CAP MARKED GARDNER ENGINEERING
- SUBJECT PROPERTY BOUNDARY
- - - LOT LINE
- - - ADJACENT PARCEL
- - - SECTION LINE
- - - EASEMENT
- x — EXISTING FENCE LINE

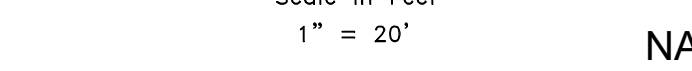

NARRATIVE

THE PURPOSE OF THIS SURVEY WAS TO ESTABLISH AND SET THE PROPERTY CORNERS OF THE PARCEL AS SHOWN AND DESCRIBED HEREON. THE SURVEY WAS ORDERED BY BRUCE HAZEN. THE BASIS OF BEARING IS THE SOUTH LINE OF THE SOUTHEAST QUARTER OF SECTION 23, TOWNSHIP 5 NORTH, RANGE 1 WEST, S.L.B.&M. WHICH BEARS NORTH 89°42'41" EAST, WEBER COUNTY, UTAH NORTH, NAD 83 STATE PLANE GRID BEARING. THE BOUNDARY WAS DETERMINED BY WARRANTY DEED RECORDED AS ENTRY NUMBERS 3039950, 2054969, 1983010, 2057774, AND THE DEDICATED PLATS OF S&M ESTATES WERE ALSO USED TO DETERMINE BOUNDARY LOCATION ALONG WITH THE FOUND MONUMENTS AS SHOWN AND DESCRIBED HEREON.

SURVEYOR'S CERTIFICATE

I, KLINT H. WHITNEY, DO HEREBY CERTIFY THAT I AM A LICENSED PROFESSIONAL LAND SURVEYOR IN THE STATE OF UTAH AND THAT I HOLD CERTIFICATE NO. 8227228 IN ACCORDANCE WITH TITLE 58, CHAPTER 22, OF THE PROFESSIONAL ENGINEERS AND LAND SURVEYORS ACT; I FURTHER CERTIFY THAT BY AUTHORITY OF THE OWNERS I HAVE COMPLETED A SURVEY OF THE PROPERTY DESCRIBED ON THIS RECORD OF SURVEY PLAT IN ACCORDANCE WITH SECTION 17-23-20 AND HAVE VERIFIED ALL MEASUREMENTS; THAT THE REFERENCE MONUMENTS SHOWN ON THIS RECORD OF SURVEY PLAT ARE LOCATED AS INDICATED AND ARE SUFFICIENT TO RETRACE OR REESTABLISH THIS SURVEY; AND THAT THE INFORMATION SHOWN HEREIN IS SUFFICIENT TO ACCURATELY ESTABLISH THE LATERAL BOUNDARIES OF THE HEREIN DESCRIBED TRACT OF REAL PROPERTY.

SIGNED THIS 10TH DAY OF JULY, 2024.

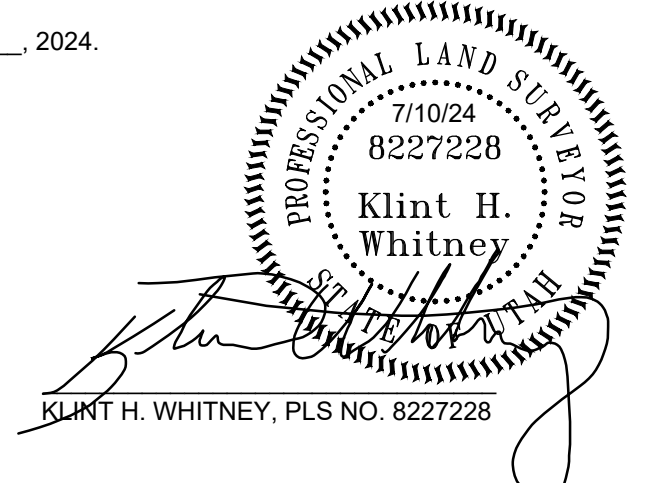

SCALE: 1:20, XREF	DATE: 7/1/20	DESIGN: KHW	DRAWN: KHW	CHECKED: KHW
REVISIONS	DESCRIPTION	DATE		

PROPERTY SURVEY FOR ERMA BYBEE TRUST
 6356 SOUTH BOMBE ROAD, UINTAH, UTAH
 LOCATED IN THE SOUTHEAST QUARTER OF SECTION 23,
 TOWNSHIP 5 NORTH, RANGE 1 WEST, S.L.B. AND M.

GARDNER ENGINEERING
 CIVIL & LAND PLANNING
 MUNICIPAL & LAND SURVEYING
 1580 W 2100S, WEST HAVEN, UT 84401
 P 801.476.0202 F 801.476.0066

S1

1