

POND EASEMENT BOUNDARY DESCRIPTION
(DEDICATED TO WEST HAVEN CITY FOR ACCESS AND MAINTENANCE)

A PART OF THE SOUTHEAST QUARTER OF SECTION 26, TOWNSHIP 6 NORTH, RANGE 2 WEST, OF THE SALT LAKE BASE AND MERIDIAN, ALSO BEING A PART OF THE CIRCLE "R" INDUSTRIAL PARK SUBDIVISION. MORE PARTICULARLY DESCRIBED AS FOLLOWS:

BEGINNING AT A POINT ON THE NORTH RIGHT-OF-WAY LINE OF 2050 WEST, SAID POINT BEING LOCATED NORTH 89°36'19" WEST 1026.77 FEET ALONG THE SOUTH SECTION LINE OF SAID SOUTHEAST QUARTER AND NORTH 00°00'00" EAST 1115.06 FEET FROM THE SOUTHEAST CORNER OF SAID SECTION 26; RUNNING THENCE NORTH 00°56'11" EAST 146.71 FEET; THENCE SOUTH 89°03'49" EAST 9.95 FEET; THENCE NORTH 00°32'09" EAST 58.30 FEET; THENCE SOUTH 89°36'19" EAST 116.92 FEET; THENCE SOUTH 00°23'41" WEST 55.00 FEET; THENCE NORTH 89°36'19" WEST 54.08 FEET; THENCE SOUTH 00°56'08" WEST 71.23 FEET; THENCE NORTH 89°03'49" WEST 47.90 FEET; THENCE SOUTH 00°55'49" WEST 79.42 FEET TO A POINT ON THE NORTH RIGHT-OF-WAY LINE OF SAID 2050 WEST; THENCE ALONG SAID RIGHT-OF-WAY LINE THE FOLLOWING TWO (2) COURSES: (1) ALONG THE ARC OF A 50.00 FOOT RADIUS CURVE TO THE LEFT 2.02 FEET WITH AN INTERNAL ANGLE OF 02°18'39" (CHORD BEARING NORTH 87°54'27" WEST 2.02 FEET); (2) NORTH 89°03'47" WEST 23.00 FEET TO THE POINT OF BEGINNING.

PARCEL 151320006 RECORD BOUNDARY DESCRIPTION

ALL OF LOT 11, CIRCLE "R" INDUSTRIAL PARK SUBDIVISION, WEST HAVEN CITY, WEBER COUNTY, UTAH.

PARCEL 151320007 RECORD BOUNDARY DESCRIPTION

ALL OF LOT 12, CIRCLE "R" INDUSTRIAL PARK SUBDIVISION, WEST HAVEN CITY, WEBER COUNTY, UTAH. ALSO; PART OF THE SOUTHEAST QUARTER OF SECTION 26, TOWNSHIP 6 NORTH, RANGE 2 WEST, SALT LAKE BASE & MERIDIAN, US SURVEY, DESCRIBED AS FOLLOWS; BEGINNING AT A POINT NORTH 1316.00 FEET AND WEST 462.00 FEET FROM THE SOUTHEAST CORNER OF SAID SECTION, THENCE WEST 198.00 FEET, THENCE NORTH 5.5 FEET, THENCE WEST 165.00 FEET, THENCE SOUTH 170.00 FEET, THENCE EAST 363 FEET, THENCE NORTH 164.50 FEET TO THE POINT OF BEGINNING. (E#1941075)

PARCEL 151320012 RECORD BOUNDARY DESCRIPTION

A HOLDING POND IN CIRCLE "R" INDUSTRIAL PARK SUBDIVISION, WEST HAVEN CITY, WEBER COUNTY, UTAH. DESCRIBED AS FOLLOWS: BEGINNING AT THE NORTHEAST CORNER OF SAID SUBDIVISION, RUNNING THENCE WEST 210.46 FEET, THENCE SOUTH 52°55' WEST 82.92 FEET, THENCE EAST 276.14 FEET, THENCE NORTH 0°32'30" EAST 50.00 FEET TO THE PLACE OF BEGINNING.

PARCEL 151320014 RECORD BOUNDARY DESCRIPTION

LOT 13, CIRCLE "R" INDUSTRIAL PARK SUBDIVISION SITUATED IN THE SOUTHEAST QUARTER OF SECTION 28, TOWNSHIP 6 NORTH, RANGE 2 WEST OF THE SALT LAKE BASE AND MERIDIAN LESS THE FOLLOWING DESCRIBED PARCEL OF LAND: BEGINNING AT THE NORTHEAST CORNER OF SAID LOT 13, BEING A POINT LOCATED 1150.00 FEET NORTH 00°49'33" EAST ALONG THE EAST LINE OF SAID SOUTHEAST QUARTER AND 822.77 FEET NORTH 89°10'22" WEST AND 49.77 FEET NORTH 0°56'11" EAST FROM THE SOUTHEAST CORNER OF SAID SECTION 26; RUNNING THENCE SOUTH 00°56'11" WEST (SOUTH 00°32'30" WEST BY RECORD) 35.82 FEET; THENCE NORTH 89°09'41" WEST 49.20 FEET TO THE NORTH LINE OF SAID LOT 13; THENCE NORTH 54°58'08" EAST (NORTH 54°33'52" EAST BY RECORD) 60.80 FEET ALONG SAID NORTH LINE TO THE POINT OF BEGINNING. CONTAINING 876 SQUARE FEET OR 0.020 ACRES FOR A NET AREA ON SAID LOT 13 OF 23,874 SQUARE FEET OR 0.548 ACRES.

PARCEL "A" BOUNDARY DESCRIPTION

A PART OF THE SOUTHEAST QUARTER OF SECTION 26, TOWNSHIP 6 NORTH, RANGE 2 WEST, OF THE SALT LAKE BASE AND MERIDIAN, ALSO BEING A PART OF THE CIRCLE "R" INDUSTRIAL PARK SUBDIVISION. MORE PARTICULARLY DESCRIBED AS FOLLOWS:

BEGINNING AT A POINT ON THE NORTH RIGHT-OF-WAY LINE OF 2050 WEST, SAID POINT BEING LOCATED NORTH 89°36'19" WEST 1026.77 FEET ALONG THE SOUTH SECTION LINE OF SAID SOUTHEAST QUARTER AND NORTH 00°00'00" EAST 1115.06 FEET FROM THE SOUTHEAST CORNER OF SAID SECTION 26; RUNNING THENCE ALONG SAID RIGHT-OF-WAY LINE THE FOLLOWING TWO (2) COURSES: (1) NORTH 89°03'49" WEST 52.00 FEET; (2) ALONG THE ARC OF A 49.90 FOOT RADIUS CURVE TO THE LEFT 29.84 FEET WITH AN INTERNAL ANGLE OF 34°15'46" (CHORD BEARING SOUTH 73°49'10" WEST 29.40 FEET); THENCE NORTH 33°15'18" WEST 115.46 FEET; THENCE ALONG THE ARC OF A 150.35 FOOT RADIUS CURVE TO THE LEFT 15.00 FEET WITH AN INTERNAL ANGLE OF 05°42'59" (CHORD BEARING NORTH 56°10'11" EAST 14.99 FEET); THENCE NORTH 53°18'41" EAST 179.54 FEET; THENCE SOUTH 00°32'09" WEST 58.30 FEET; THENCE NORTH 89°03'49" WEST 9.95 FEET; THENCE SOUTH 00°56'11" WEST 146.71 FEET TO THE POINT OF BEGINNING. CONTAINING 18,633 SQUARE FEET OR 0.43 ACRES.

PARCEL "B" BOUNDARY DESCRIPTION

A PART OF THE SOUTHEAST QUARTER OF SECTION 26, TOWNSHIP 6 NORTH, RANGE 2 WEST, OF THE SALT LAKE BASE AND MERIDIAN, ALSO BEING A PART OF THE CIRCLE "R" INDUSTRIAL PARK SUBDIVISION. MORE PARTICULARLY DESCRIBED AS FOLLOWS:

BEGINNING AT A POINT ON THE NORTH RIGHT-OF-WAY LINE OF 2050 WEST, SAID POINT BEING LOCATED NORTH 89°36'19" WEST 1026.77 FEET ALONG THE SOUTH SECTION LINE OF SAID SOUTHEAST QUARTER AND NORTH 00°00'00" EAST 1115.06 FEET FROM THE SOUTHEAST CORNER OF SAID SECTION 26; RUNNING THENCE NORTH 00°56'11" EAST 146.71 FEET; THENCE SOUTH 89°03'49" EAST 9.95 FEET; THENCE NORTH 00°32'09" EAST 58.30 FEET; THENCE SOUTH 89°36'19" EAST 210.46 FEET; THENCE SOUTH 00°56'11" WEST 149.71 FEET; THENCE NORTH 89°03'49" WEST 49.19 FEET; THENCE SOUTH 54°57'33" WEST 132.63 FEET TO A POINT ON SAID NORTH RIGHT-OF-WAY LINE OF 2050 WEST; THENCE ALONG SAID RIGHT-OF-WAY LINE THE FOLLOWING TWO (2) COURSES: (1) ALONG THE ARC OF A 50.00 FOOT RADIUS CURVE TO THE LEFT 47.15 FEET WITH AN INTERNAL ANGLE OF 54°01'13" (CHORD BEARING NORTH 62°03'11" WEST 45.42 FEET); (2) NORTH 89°03'47" WEST 23.00 FEET TO THE POINT OF BEGINNING. CONTAINING 40,206 SQUARE FEET OR 0.92 ACRES.

LESS THAN EXCEPTING PART OF THE SOUTHEAST QUARTER OF SECTION 26, TOWNSHIP 6 NORTH, RANGE 2 WEST, SALT LAKE BASE & MERIDIAN, US SURVEY, DESCRIBED AS FOLLOWS; BEGINNING AT A POINT NORTH 1316.00 FEET AND WEST 462.00 FEET FROM THE SOUTHEAST CORNER OF SAID SECTION, THENCE WEST 198.00 FEET, THENCE NORTH 5.5 FEET, THENCE WEST 165.00 FEET, THENCE SOUTH 170.00 FEET, THENCE EAST 363 FEET, THENCE NORTH 164.50 FEET TO THE POINT OF BEGINNING.

LEGEND

- ◆ WEBER COUNTY MONUMENT AS NOTED
- SET 24" REBAR AND CAP MARKED GARDNER ENGINEERING
- SUBJECT PROPERTY BOUNDARY
- - - ORIGINAL PARCEL LINE
- - - ADJACENT PARCEL
- - - SECTION LINE
- - - EASEMENT
- - - EXISTING FENCE LINE

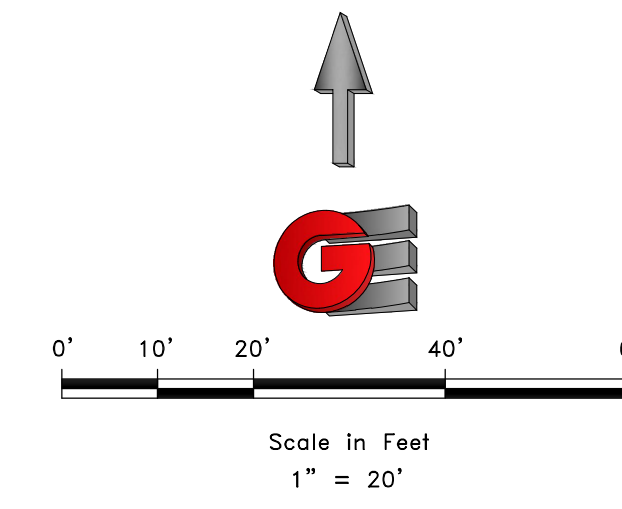

NARRATIVE

THE PURPOSE OF THIS SURVEY WAS TO ADJUST AND ESTABLISH THE BOUNDARY OF THE PARCELS AS SHOWN AND DESCRIBED HEREON. THE SURVEY WAS ORDERED BY RON KEMP. THE BASIS OF BEARING IS THE SOUTH LINE OF THE SOUTHEAST QUARTER OF SECTION 26, TOWNSHIP 6 NORTH, RANGE 2 WEST, OF THE SALT LAKE BASE & MERIDIAN, WHICH BEARS NORTH 89°36'19" WEST, WEBER COUNTY, UTAH NORTH, NAD 83 STATE PLANE GRID BEARING. THE BOUNDARY WAS DETERMINED BY WARRANTY DEEDS RECORDED AS ENTRY NUMBERS 2595453, 2989063, 3274642 AND 2989063, AND DEEDS OF ADJOINING PROPERTY OWNERS. RECORD OF SURVEY NUMBER 5759, AND THE DEDICATED PLAT OF CIRCLE R INDUSTRIAL PARK SUBDIVISION WERE ALSO USED TO DETERMINE BOUNDARY LOCATION ALONG WITH THE FOUND MONUMENTS AS SHOWN AND DESCRIBED HEREON.

SURVEYOR'S CERTIFICATE

I, KLINT H. WHITNEY, DO HEREBY CERTIFY THAT I AM A LICENSED PROFESSIONAL LAND SURVEYOR IN THE STATE OF UTAH AND THAT I HOLD CERTIFICATE NO. 8227228 IN ACCORDANCE WITH TITLE 58, CHAPTER 22, OF THE PROFESSIONAL ENGINEERS AND LAND SURVEYORS ACT. I FURTHER CERTIFY THAT BY AUTHORITY OF THE OWNERS I HAVE COMPLETED A SURVEY OF THE PROPERTY DESCRIBED ON THIS RECORD OF SURVEY PLAT IN ACCORDANCE WITH SECTION 17-23-20 AND HAVE VERIFIED ALL MEASUREMENTS; THAT THE REFERENCE MONUMENTS SHOWN ON THIS RECORD OF SURVEY PLAT ARE LOCATED AS INDICATED AND ARE SUFFICIENT TO RETRACE OR REESTABLISH THIS SURVEY; AND THAT THE INFORMATION SHOWN HEREIN IS SUFFICIENT TO ACCURATELY ESTABLISH THE LATERAL BOUNDARIES OF THE HEREIN DESCRIBED TRACT OF REAL PROPERTY.

SIGNED THIS 6TH DAY OF AUGUST, 2024.

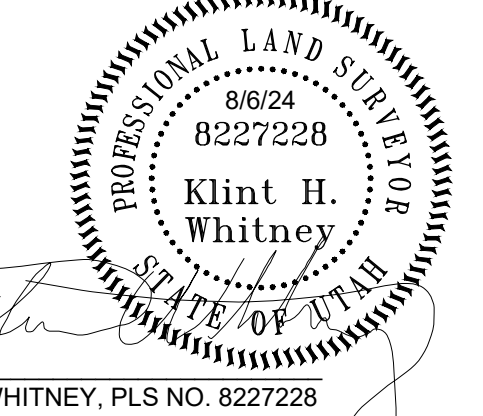

KLINT H. WHITNEY, PLS NO. 8227228

B & K STEEL & SUPPLY INC
150730011

RECEIVED
DEC 30 2024
FILE # 7948

BOMAN & KEMP LLC
151320009

BOMAN & KEMP LLC
151320015

BOMAN & KEMP LLC
151320007

PARCEL "B"
BOMAN & KEMP LLC
40,206 SQ. FT.
0.92 AC.

PARCEL "A"
WILSONS FLOOR
COATINGS INC
18,633 SQ. FT.
0.43 AC.

USA
150720023

USA
150730006

RELIABLE WASTE
SYSTEMS
151320005

RELIABLE WASTE
SYSTEMS
151320004

EXISTING
BUILDING

EXISTING
BUILDING

2050 WEST

SOUTH QUARTER CORNER
SEC.26 T6N R2W SLB&M

SOUTHEAST CORNER
SEC.26 T6N R2W SLB&M

SCALE:	1:20, XREF
DATE:	8/6/24
DESIGN:	
DRAWN:	JTN
CHECKED:	KHW
DWG.: B200 - MISC SURVEY - 164 RON KEMP SURVEY/TOWNSHIP 6 NORTH	

REVISIONS	DESCRIPTION
DATE	

BOUNDARY ADJUSTMENT FOR RON KEMP
2404 SOUTH 2050 WEST, WEST HAVEN, UTAH
LOCATED IN THE SOUTHEAST QUARTER OF SECTION 28,
TOWNSHIP 7 NORTH, RANGE 1 WEST, S.L.B. AND M.

GARDNER ENGINEERING
CIVIL & LAND PLANNING
MUNICIPAL & LAND SURVEYING
1580 W 2100S, WEST HAVEN, UT 84401
P 801.476.0202 F 801.476.0066



S1
1