

BOUNDARY DESCRIPTION

ALL OF LOT 20, WOLF RIDGE SUBDIVISION PHASE 2, ACCORDING TO THE OFFICIAL PLAT THEREOF ON FILE WITH THE WEBER COUNTY RECORDER.

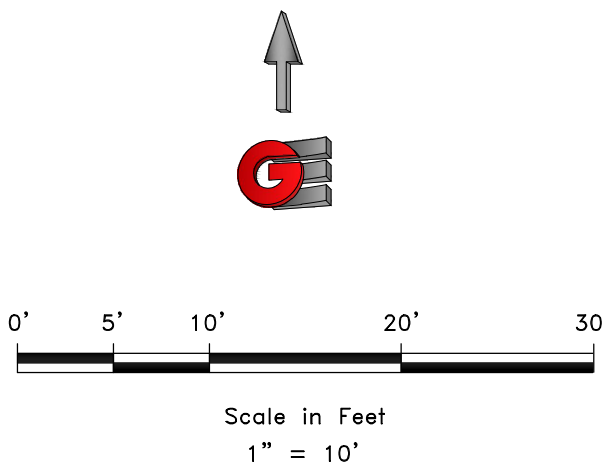

- LEGEND
- WEBER COUNTY MONUMENT AS NOTED
 - SET 24" REBAR AND CAP MARKED GARDNER ENGINEERING
 - SUBJECT PROPERTY BOUNDARY
 - LOT LINE
 - ADJACENT PARCEL
 - SECTION LINE
 - EASEMENT
 - EXISTING FENCE LINE

NARRATIVE

THE PURPOSE OF THIS SURVEY WAS TO CONDUCT A TOPOGRAPHIC SURVEY AND ESTABLISH AND SET THE PROPERTY CORNERS OF THE PARCEL AS SHOWN AND DESCRIBED HEREON. THE SURVEY WAS ORDERED BY TOM MCAULIFFE. THE BASIS OF BEARING IS THE WEST LINE OF THE NORTHEAST QUARTER QUARTER OF SECTION 22, TOWNSHIP 7 NORTH, RANGE 1 EAST OF THE SALT LAKE BASE AND MERIDIAN WHICH BEARS NORTH 00°30'27" EAST, WEBER COUNTY, UTAH NORTH, NAD 83 STATE PLANE GRID BEARING. THE BOUNDARY WAS DETERMINED BUY WARRANTY DEED RECORDED AS ENTRY NUMBER 2075144, AND DEEDS OF ADJOINING PROPERTY OWNERS. THE DEDICATED PLAT OF WOLF RIDGE SUBDIVISION PHASE -2 WAS ALSO USED TO DETERMINE BOUNDARY LOCATION ALONG WITH THE FOUND MONUMENTS AS SHOWN AND DESCRIBED HEREON.

SURVEYOR'S CERTIFICATE

I, KLINT H. WHITNEY, DO HEREBY CERTIFY THAT I AM A LICENSED PROFESSIONAL LAND SURVEYOR IN THE STATE OF UTAH AND THAT I HOLD CERTIFICATE NO. 8227228 IN ACCORDANCE WITH TITLE 58, CHAPTER 22, OF THE PROFESSIONAL ENGINEERS AND LAND SURVEYORS ACT; I FURTHER CERTIFY THAT BY AUTHORITY OF THE OWNERS I HAVE COMPLETED A SURVEY OF THE PROPERTY DESCRIBED ON THIS RECORD OF SURVEY PLAT IN ACCORDANCE WITH SECTION 17-23-20 AND HAVE VERIFIED ALL MEASUREMENTS; THAT THE REFERENCE MONUMENTS SHOWN ON THIS RECORD OF SURVEY PLAT ARE LOCATED AS INDICATED AND ARE SUFFICIENT TO RETRACE OR REESTABLISH THIS SURVEY; AND THAT THE INFORMATION SHOWN HEREIN IS SUFFICIENT TO ACCURATELY ESTABLISH THE LATERAL BOUNDARIES OF THE HEREIN DESCRIBED TRACT OF REAL PROPERTY.

SIGNED THIS 12TH DAY OF MARCH, 2025.

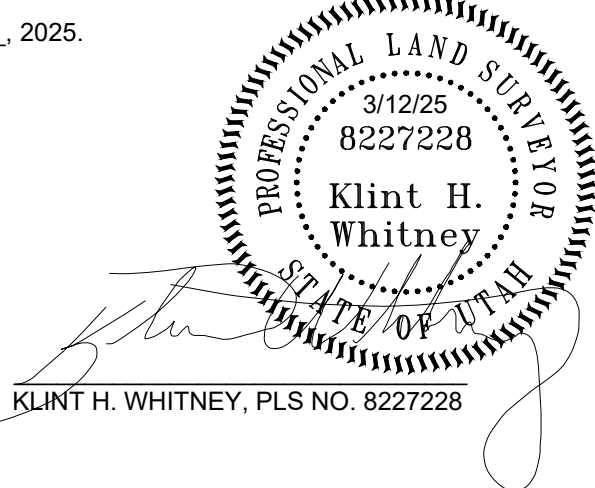

REVISIONS		SCALE: 1"=10' XREF
DATE	DESCRIPTION	DATE: 3/12/25
		DESIGN: -----
		DRAWN: KHW
		CHECKED: KHW
		DWG.: R-2001 - MISC SURVEYS-118 TOM MCAULIFFE SURVEY OF TOM MCAULIFFE DWG.
PROPERTY SURVEY FOR TOM MCAULIFFE		
4066 NORTH WOLF RIDGE CIRCLE, EDEN, UTAH		
LOCATED IN THE NORTHEAST QUARTER OF SECTION 22,		
TOWNSHIP 7 NORTH, RANGE 1 EAST, S.L.B. AND M.		
GARDNER ENGINEERING		
CIVIL & LAND PLANNING		
MUNICIPAL & LAND SURVEYING		
1580 W 2100S, WEST HAVEN, UT 84401		
P 801.476.0202 F 801.476.0066		
S1		
1		