

BOUNDARY DESCRIPTION

A PART OF THE NORTHEAST QUARTER OF SECTION 5, TOWNSHIP 5 NORTH, RANGE 1 WEST OF THE SALT LAKE BASE AND MERIDIAN, BEGINNING AT A POINT ON THE WEST LINE OF KIESEL AVENUE BEING LOCATED NORTH 01°24'11\"/>

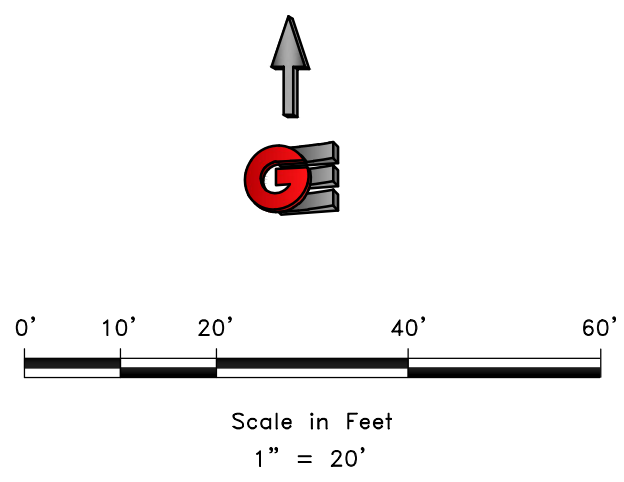

- LEGEND**
- OGDEN CITY MONUMENT AS NOTED
 - SET 24\"/>

NARRATIVE

THE PURPOSE OF THIS SURVEY WAS TO ESTABLISH AND SET THE PROPERTY CORNERS OF THE PARCEL AS SHOWN AND DESCRIBED HEREON. THE SURVEY WAS ORDERED BY BRANSON WOOD. THE BASIS OF BEARING IS THE CENTERLINE OF 36TH STREET BETWEEN RIVERDALE ROAD AND KIESEL AVENUE, WHICH BEARS NORTH 88°41'57\"/>

SURVEYOR'S CERTIFICATE

I, KLINT H. WHITNEY, DO HEREBY CERTIFY THAT I AM A LICENSED PROFESSIONAL LAND SURVEYOR IN THE STATE OF UTAH AND THAT I HOLD CERTIFICATE NO. 8227228 IN ACCORDANCE WITH TITLE 58, CHAPTER 22, OF THE PROFESSIONAL ENGINEERS AND LAND SURVEYORS ACT; I FURTHER CERTIFY THAT BY AUTHORITY OF THE OWNERS I HAVE COMPLETED A SURVEY OF THE PROPERTY DESCRIBED ON THIS RECORD OF SURVEY PLAT IN ACCORDANCE WITH SECTION 17-23-20 AND HAVE VERIFIED ALL MEASUREMENTS; THAT THE REFERENCE MONUMENTS SHOWN ON THIS RECORD OF SURVEY PLAT ARE LOCATED AS INDICATED AND ARE SUFFICIENT TO RETRACE OR REESTABLISH THIS SURVEY; AND THAT THE INFORMATION SHOWN HEREIN IS SUFFICIENT TO ACCURATELY ESTABLISH THE LATERAL BOUNDARIES OF THE HEREIN DESCRIBED TRACT OF REAL PROPERTY.

SIGNED THIS 10TH DAY OF APRIL, 2025.

RECEIVED
APR 23 2025
FILE # 8030

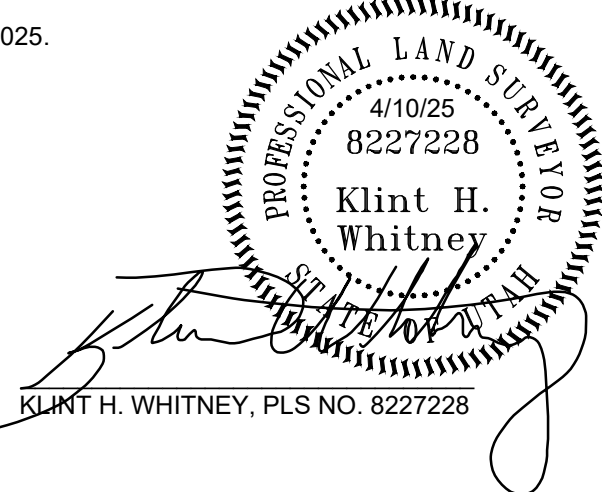

REVISIONS		SCALE: 1/2\"/>
DATE	DESCRIPTION	
DWG.:		PL-2001 - MISC SURVEYS-01 BRANSON WOOD 346 36TH STREET SURVEY 03/04/24 36TH STREET.DWG

PROPERTY SURVEY FOR MOUNTAIN WEST CRE

346 36TH STREET, OGDEN, UTAH

LOCATED IN THE NORTHEAST QUARTER OF SECTION 5,

TOWNSHIP 5 NORTH, RANGE 1 WEST, S.L.B. AND M.

**GARDNER
ENGINEERING**

CIVIL • LAND PLANNING
MUNICIPAL • LAND SURVEYING

1580 W 2100S, WEST HAVEN, UT 84401
P 801.476.0202 F 801.476.0066

S1

1