

RECORD PARCEL 220140023 BOUNDARY DESCRIPTION

PART OF THE SOUTHWEST QUARTER OF SECTION 20, TOWNSHIP 7 NORTH, RANGE 1 EAST, SALT LAKE BASE AND MERIDIAN, U.S. SURVEY-BEGINNING AT A POINT ON QUARTER SECTION LINE WHICH IS NORTH820.14 NORTH FROM THE SOUTH QUARTER CORNER OF SAID SECTION 20; RUNNING THENCE SOUTH 89D59' WEST 290.4 FEET, THENCE NORTH150 FEET, THENCE NORTH 89D59' EAST 290.4 FEET AND THENCE SOUTH 150.0 FEET TO THE POINT OF BEGINNING. CONTAINS 1.0 ACRE.

RECORD PARCEL 220140022 BOUNDARY DESCRIPTION

PART OF THE SOUTHWEST QUARTER OF SECTION 20, TOWNSHIP 7 NORTH, RANGE 1 EAST, SALT LAKE BASE AND MERIDIAN, U.S. SURVEY-BEGINNING AT A POINT ON THE QUARTER SECTION LINE, WHICH IS NORTH 236.5 FEET AND NORTH 44D27' WEST 40 FEET, MORE OR LESS, TO THE WEST LINE OF 3500 EAST STREET FROM THE SOUTH QUARTER CORNER OF SAID SECTION 20, RUNNING THENCE NORTH44D27' WEST 295.5 FEET, THENCE NORTH 44D02' WEST 84.5 FEET, THENCE NORTH 47D40' WEST 66.5 FEET, NORTH 54D51' WEST 79.0 FEET, NORTH 71D22' WEST 110.5 FEET, THENCE SOUTH 81D26' WEST 138.5 FEET, THENCE SOUTH 76D02' WEST 99.5 FEET, THENCE NORTH86D15' WEST 412.23 FEET, THENCE NORTH 325.13 FEET, THENCE NORTH 89D59' EAST 866.60 FEET; THENCE SOUTH 150 FEET; THENCE NORTH 89D59' EAST 257.4 FEET TO THE WEST LINE OF 3500 EAST STREET; THENCE SOUTH ALONG THE SAID STREET 583 FEET, MORE OR LESS, TO THE POINT OF BEGINNING.

ADJUSTED PARCEL 220140023 BOUNDARY DESCRIPTION

PART OF THE SOUTHWEST QUARTER OF SECTION 20, TOWNSHIP 7 NORTH, RANGE 1 EAST, SALT LAKE BASE AND MERIDIAN, BEGINNING AT A POINT ON THE WEST LINE OF 3500 EAST STREET BEING LOCATED NORTH 00°09'09" WEST 302.87 FEET ALONG THE EAST LINE OF SAID SOUTHWEST QUARTER AND NORTH 90°00'00" WEST 64.72 FEET AND NORTH 00°09'01" WEST 536.53 FEET FROM THE SOUTHEAST CORNER OF SAID SOUTHWEST QUARTER; RUNNING THENCE SOUTH 89°59'16" WEST 278.08 FEET; THENCE NORTH 00°30'11" EAST 169.41 FEET TO AN EXISTING FENCE LINE; THENCE ALONG SAID EXISTING FENCE LINE AND ITS REMAINS NORTH 89°59'23" EAST 276.12 FEET TO SAID WEST LINE OF 3500 EAST STREET; THENCE ALONG SAID WEST LINE SOUTH 00°09'29" EAST 169.40 FEET TO THE POINT OF BEGINNING. CONTAINING 1.077 ACRES.

ADJUSTED PARCEL 220140022 BOUNDARY DESCRIPTION

PART OF THE SOUTHWEST QUARTER OF SECTION 20, TOWNSHIP 7 NORTH, RANGE 1 EAST, SALT LAKE BASE AND MERIDIAN, BEGINNING AT THE NORTHEAST CORNER OF LOT 1 SPRING CREEK RANCHES BEING LOCATED NORTH 00°09'09" WEST 302.87 FEET ALONG THE EAST LINE OF SAID SOUTHWEST QUARTER AND NORTH 90°00'00" WEST 64.72 FEET FROM THE SOUTHEAST CORNER OF SAID SOUTHWEST QUARTER; RUNNING THENCE ALONG THE NORTH LINE OF SAID SPRING CREEK RANCHES THE FOLLOWING EIGHT (8) COURSES: (1) NORTH 44°35'50" WEST 242.43 FEET; (2) NORTH 44°11'10" WEST 84.50 FEET; (3) NORTH 47°49'10" WEST 66.50 FEET; (4) NORTH 55°00'10" WEST 79.00 FEET; (5) NORTH 71°31'10" WEST 110.50 FEET; (6) SOUTH 81°16'50" WEST 138.50 FEET; (7) SOUTH 75°52'50" WEST 99.50 FEET; (8) NORTH 86°24'10" WEST 486.12 FEET TO AN EXISTING FENCE LINE; THENCE ALONG EXISTING FENCE LINES THE FOLLOWING TWO (2) COURSES: (1) NORTH 00°19'23" WEST 363.59 FEET; (2) NORTH 89°59'33" EAST 870.55 FEET; THENCE SOUTH 00°30'11" WEST 169.41 FEET; THENCE NORTH 89°59'16" EAST 278.08 FEET TO THE WEST LINE OF 3500 WEST STREET; THENCE ALONG SAID WEST LINE SOUTH 00°09'01" EAST 536.53 FEET TO THE POINT OF BEGINNING. CONTAINING 10.016 ACRES.

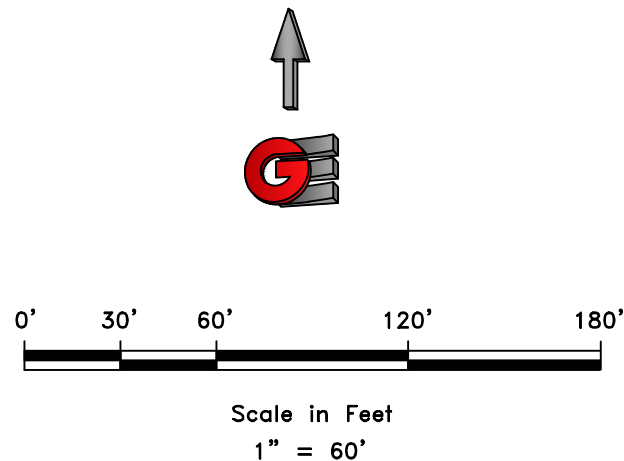

LEGEND

- WEBER COUNTY MONUMENT AS NOTED
- SET 24" REBAR AND CAP MARKED GARDNER ENGINEERING
- SUBJECT PROPERTY BOUNDARY
- LOT LINE
- ADJACENT PARCEL
- SECTION LINE
- EASEMENT
- EXISTING FENCE LINE

NARRATIVE

THE PURPOSE OF THIS SURVEY WAS TO ESTABLISH AND SET THE PROPERTY CORNERS OF THE PARCEL AS SHOWN AND DESCRIBED HEREON. THE SURVEY WAS ORDERED BY CHUCK CREAMER. THE BASIS OF BEARING IS THE EAST LINE OF THE SOUTHWEST QUARTER OF SECTION 20, TOWNSHIP 7 NORTH, RANGE 1 EAST, OF THE SALT LAKE BASE AND MERIDIAN WHICH BEARS NORTH 00°09'09" WEST, WEBER COUNTY, UTAH NORTH, NAD 83 STATE PLANE GRID BEARING. THE BOUNDARY WAS DETERMINED BUY WARRANTY DEED RECORDED AS ENTRY NUMBER 3324381, 3324382, AND DEEDS OF ADJOINING PROPERTY OWNERS. RECORD OF SURVEY NUMBERS 7047, AND THE DEDICATED PLATS OF SPRING CREEK RANCHES WERE ALSO USED TO DETERMINE BOUNDARY LOCATION ALONG WITH THE FOUND MONUMENTS AS SHOWN AND DESCRIBED HEREON. THERE ARE MULTIPLE GAPS AND OVERLAPS IN DEEDS SO OF WHICH EXCLUDE 3500 EAST STREET. BECAUSE THERE IS NO SHORTAGE IN AREA FOR EITHER PARCELS WHEN HOLDING OCCUPATION LINES THE ADJUSTED DESCRIPTIONS WERE PREPARED EXCLUDING 3500 EAST STREET.

SURVEYOR'S CERTIFICATE

I, KLINT H. WHITNEY, DO HEREBY CERTIFY THAT I AM A LICENSED PROFESSIONAL LAND SURVEYOR IN THE STATE OF UTAH AND THAT I HOLD CERTIFICATE NO. 8227228 IN ACCORDANCE WITH TITLE 58, CHAPTER 22, OF THE PROFESSIONAL ENGINEERS AND LAND SURVEYORS ACT; I FURTHER CERTIFY THAT BY AUTHORITY OF THE OWNERS I HAVE COMPLETED A SURVEY OF THE PROPERTY DESCRIBED ON THIS RECORD OF SURVEY PLAT IN ACCORDANCE WITH SECTION 17-23-20 AND HAVE VERIFIED ALL MEASUREMENTS; THAT THE REFERENCE MONUMENTS SHOWN ON THIS RECORD OF SURVEY PLAT ARE LOCATED AS INDICATED AND ARE SUFFICIENT TO RETRACE OR REESTABLISH THIS SURVEY; AND THAT THE INFORMATION SHOWN HEREIN IS SUFFICIENT TO ACCURATELY ESTABLISH THE LATERAL BOUNDARIES OF THE HEREIN DESCRIBED TRACT OF REAL PROPERTY.

SIGNED THIS 21ST DAY OF AUGUST, 2024.

RECEIVED
MAY 14 2025
FILE # 8053

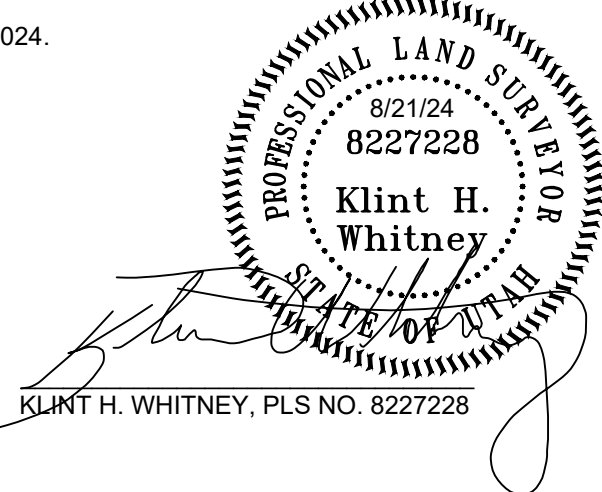

REVISIONS		SCALE: 1" = 60'
DATE	DESCRIPTION	DATE: 8/21/24
		DESIGN: -----
		DRAWN: KHW
		CHECKED: KHW
		DWG.: R-2001 - MISC SURVEY 24-302 - CHUCK CREAMER SURVEY FOR CHUCK CREAMER.DWG

BOUNDARY ADJUSTMENT SURVEY FOR CHUCK CREAMER
3627 NORTH 3500 EAST, LIBERTY, UTAH
LOCATED IN THE SOUTHWEST QUARTER OF SECTION 20,
TOWNSHIP 7 NORTH, RANGE 1 EAST, S.L.B. AND M.

GARDNER ENGINEERING

CIVIL • LAND PLANNING
MUNICIPAL • LAND SURVEYING
1580 W 2100S, WEST HAVEN, UT 84401
P 801.476.0202 F 801.476.0066

S1
1