

POINT OF CURVATURE OF MOUNTAIN ROAD
CALCULATED CENTERLINE MONUMENT

AT INTERSECTION OF MOUNTAIN ROAD
AND 16TH STREET
CALCULATED CENTERLINE MONUMENT

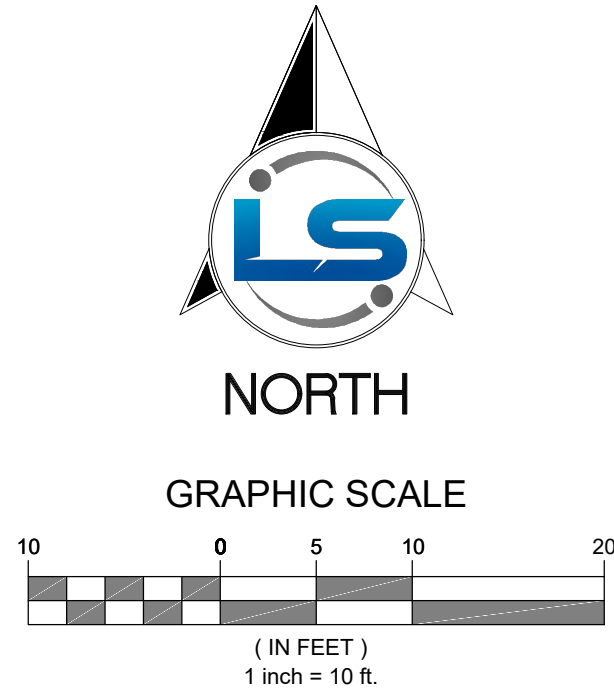

LEGEND

- COUNTY MONUMENT
- PROPERTY CORNER AS DESCRIBED
- SUBDIVISION BOUNDARY
- LOT LINE
- ADJACENT PARCEL
- SECTION LINE
- EASEMENT
- EXISTING FENCE LINE

DEED DESCRIPTION

ALL OF LOT 94, ORCHARD PARK SUBDIVISION NO. 7, OGDEN CITY, WEBER COUNTY, UTAH.

NARRATIVE

THE PURPOSE OF THE SURVEY WAS TO DETERMINE THE BOUNDARY OF THE LAND SHOWN HEREON. THE SURVEY WAS ORDERED BY KORTE WAMSLEY. THE BASIS OF BEARING IS THE CALCULATED CENTERLINE BETWEEN THE INTERSECTION OF MOUNTAIN ROAD AND 16TH STREET AND THE POINT OF CURVATURE OF MOUNTAIN ROAD WHICH BEARS SOUTH 0°15'01" EAST WEBER COUNTY, UTAH, NAD 83 STATE PLANE GRID BEARING.

SURVEYOR'S CERTIFICATE

I, WILLIS D. LONG, DO HEREBY CERTIFY THAT I AM A LICENSED PROFESSIONAL LAND SURVEYOR IN THE STATE OF UTAH AND THAT I HOLD CERTIFICATE NO. 10708886 IN ACCORDANCE WITH TITLE 58, CHAPTER 22, OF THE PROFESSIONAL ENGINEERS AND LAND SURVEYORS ACT; I FURTHER CERTIFY THAT BY AUTHORITY OF THE OWNERS I HAVE COMPLETED A SURVEY OF THE PROPERTY DESCRIBED ON THIS RECORD OF SURVEY PLAT IN ACCORDANCE WITH SECTION 17-23-20 AND HAVE VERIFIED ALL MEASUREMENTS; THAT THE REFERENCE MONUMENTS SHOWN ON THIS RECORD OF SURVEY PLAT ARE LOCATED AS INDICATED AND ARE SUFFICIENT TO RETRACE OR REESTABLISH THIS SURVEY; AND THAT THE INFORMATION SHOWN HEREIN IS SUFFICIENT TO ACCURATELY ESTABLISH THE LATERAL BOUNDARIES OF THE HEREIN DESCRIBED TRACT OF REAL PROPERTY.

SIGNED THIS 25TH DAY OF FEBRUARY 2025.

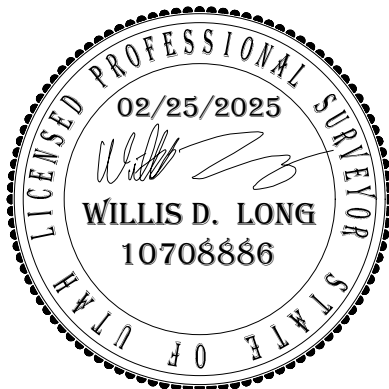

RECEIVED
MAY 16 2025
FILE # 8056

REVISIONS		DATE	DESCRIPTION

PROPERTY SURVEY FOR KORTE WAMSLEY
IN THE SOUTHWEST QUARTER OF SECTION 2, TOWNSHIP
6 NORTH, RANGE 1 WEST, SALT LAKE BASIN AND MERIDIAN
1544 MOUNTAIN ROAD, OGDEN CITY, WEBER COUNTY, UTAH

LAYTON SURVEYS LLC
Professional Land Surveying
837 S 500 W, STE. 201
WOODS CROSS, UT 84010
willis.long@laytonsurveys.com

S1
1