

NORTH QUARTER CORNER OF SECTION
23, TOWNSHIP 5 NORTH, RANGE 1
- WEST, SALT LAKE BASE AND MERIDIAN,
U.S. SURVEY, FOUND WEBER COUNTY
BRASS CAP MONUMENT DATED 1986

FINISH

-



THIS SURVEY WAS REQUESTED BY ZACK HADLEY FOR THE PURPOSE OF REESTABLISHING THE BOUNDARY OF THE HEREON DESCRIBED PARCELS OF LAND.

WEBER COUNTY BRASS CAP MONUMENTS WERE FOUND AT THE NORTH QUARTER CORNER AND THE CENTER OF SECTION 23, TOWNSHIP 5 NORTH, RANGE 1 WEST, SALT LAKE BASE AND MERIDIAN, U.S. SURVEY.

A LINE BEARING SOUTH 00°02'28" WEST BETWEEN SAID SECTION CORNERS WAS USED AS THE BASIS OF BEARINGS FOR THIS SURVEY.

OLYMPIC COVE ESTATES PREPARED BY REEVE AND ASSOCIATES DATED DECEMBER 14, 1997 AND RECORDED AS ENTRY #1508120 AND OLYMPIC COVE ESTATES 2ND AMENDMENT LOTS 6 AND 7 PREPARED BY GREAT BASIN DATED AUGUST 27, 2013 AND RECORDED AS ENTRY #2652727, WERE USED AS REFERENCE FOR THIS SURVEY.

BOUNDARIES OF THE PARCELS WERE ESTABLISHED BY INFORMATION OF RECORD AND FOUND EVIDENCE OF OCCUPATION ON THE GROUND.

PROPERTY CORNERS ARE SET WITH A 5/8" REBAR AND PLASTIC CAP STAMPED "REEVE & ASSOCIATES".

ALL OF LOT 8, OLYMPIC COVE ESTATES AMENDED AND ALL OF LOT 11, OLYMPIC COVE ESTATES 2ND AMENDMENT BEING PART OF THE NORTHEAST QUARTER OF SECTION 23, TOWNSHIP 5 NORTH, RANGE 1 WEST, SALT LAKE BASE AND MERIDIAN, U.S. SURVEY, MORE PARTICULARLY DESCRIBED AS FOLLOWS:

BEGINNING AT A POINT SDAID POINT BEING 2021.79 FEET SOUTH 00°02'28" WEST AND 1035.34 FEET SOUTH 89°57'32" EAST FROM THE NORTH QUARTER CORNER OF SAID SECTION 23; THENCE SOUTH 83°59'05" EAST 80.11 FEET; THENCE SOUTH 70°33'40" EAST 33.97 FEET TO THE NORTHWEST CORNER OF LOT 12, OLYMPIC COE ESTATES 2ND AMENDMENT; THENCE SOUTH 12°28'24" EAST 319.44 FEET ALONG THE WEST LINE OF SAID LOT 12 TO THE NORTHERLY RIGHT-OF-WAY LINE OF 5950 SOUTH STREET; THENCE SOUTH 77°31'36" WEST 243.24 FEET ALONG SAID NORTHERLY RIGHT-OF-WAY LINE TO THE EASTERLY RIGHT-OF-WAY LINE OF 2500 EAST STREET; THENCE ALONG SAID WESTERLY RIGHT-OF-WAY LINE THE DISTANCE OF THREE (3) FEET TO THE POINT OF BEGINNING. (2) ALONG A TANGENT CURVE TURNING TO THE RIGHT WITH A RADIUS OF 30.00 FEET, AN ARC LENGTH OF 15.00 FEET, A DELTA ANGLE OF 28°38'38", A CHORD BEARING OF NORTH 01°50'55" EAST, AND A CHORD LENGTH OF 14.84 FEET; AND (3) ALONG A REVERSE CURVE TURNING TO THE LEFT WITH A RADIUS OF 55.00 FEET, AN ARC LENGTH OF 32.26 FEET, A DELTA ANGLE OF 33°36'23", A CHORD BEARING OF NORTH 00°37'57" WEST, AND A CHORD LENGTH OF 31.80 FEET; THENCE NORTH 36°38'06" EAST 169.63 FEET TO THE POINT OF BEGINNING.

CONTAINING 77,755 SQUARE FEET OR 1.785 ACRES.

1, JASON FELT, DO HEREBY CERTIFY THAT I AM A PROFESSIONAL LAND SURVEYOR IN THE STATE OF UTAH IN ACCORDANCE WITH TITLE 58, CHAPTER 22, PROFESSIONAL ENGINEERS AND PROFESSIONAL LAND SURVEYORS ACT; AND THAT I HAVE COMPLETED A SURVEY OF THE PROPERTY DESCRIBED ON THIS PLAT IN ACCORDANCE WITH SECTIONS 17-23-17 AND HAVE VERIFIED ALL MEASUREMENTS, AND HAVE PLUED MONUMENTS TO REPRESENT THIS PLAT. I FURTHER CERTIFY THAT THIS PLAT IS A CORRECT REPRESENTATION OF THE LAND SURVEYED AND HAS BEEN PREPARED IN CONFORMITY WITH THE MINIMUM STANDARDS AND REQUIREMENTS OF THE LAW.

SIGNED THIS 20th DAY OF JUNE, 2025.

9239283

UTAH LICENSE NUMBER

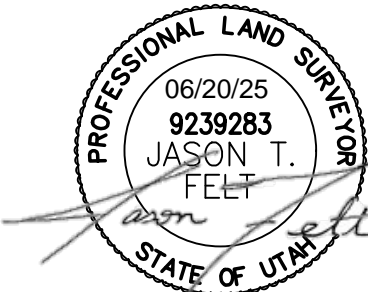

RECEIVED
JUN 20 2025
FILE # 8087

[illegible]

RECORD OF SURVEY

WEBER COUNTY, UTAH

ZACK HADLEY

Project Info.
Surveyor: J. FELT
Designer: N. ANDERSON
Begin Date: 6-20-2025
Name: HADLEY RECORD OF SURVEY
Scale: 1"=30'
Checked:
Number: 8329-01

Sheet	1
1	Sheets